



Accessories

Square nut



DIN 562

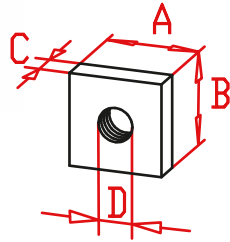

Slide nuts position refer to chapter 2.2 page 3
Material: galvanized steel

Code-No.	Type	A	B	C	D
02708	M 4	7	7	2,2	M 4
02710	M 5	8	8	2,7	M 5
02715	M 6	10	10	3,2	M 6
02714	M 8	13	13	4	M 8
02713	M 10	17	17	5	M 10
02721	M 10	25	20	8	M 10

T-nut

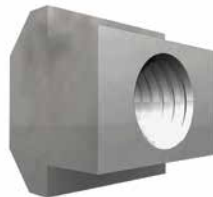

DIN 508

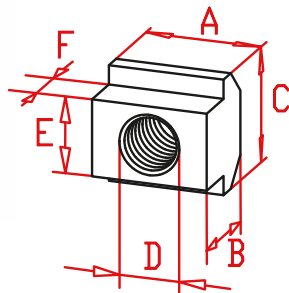
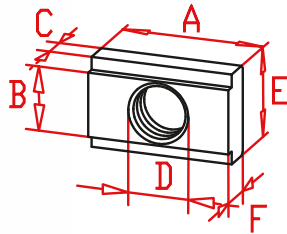

Slide nuts position refer to chapter 2.2 page 3
Material: galvanized steel

Code-No.	Type	A	B	C	D	E	F
02717	M3	8	4,2	2,1	M 3	6,9	4,3
02739	M4	10	4,2	2,1	M 4	6,9	3,3
02742	M 5	12	5,3	3	M 5	8	4
02709	M 5	14	8,1	4,5	M 5	14	6
02716	M 6	14	8,1	4,5	M 6	14	6
02718	M 8	18	8,1	4,5	M 8	14	6
02719	M10	22	8,1	4,5	M 10	14	6
02730	M 6	13	10	4	M 6	15	8
02731	M 8	13	10	4	M 8	15	8

Code-No.	Type	A	B	C	D	E	F
02734	M 5	10	8	10	M 5	6	4
02735	M 6	13	10	13	M 6	8	4
02736	M 8	15	12	15	M 8	10	6
02720	M 10	18	14	18	M 10	12	7
02722	M 12	22	16	22	M 12	14	8
02737	M 16	28	20	28	M 16	18	10

Rhombus nut

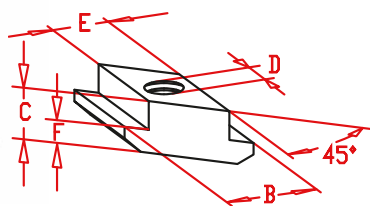

Slide nuts position refer to chapter 2.2 page 3
Material: galvanized steel

Code-No.	Type	B	C	D	E	F
02732	M 8	15	9	M 8	10	4,2
02733	M 6	15	9	M 6	10	4,2
02760	M 5	10	8	M 5	6	4

Half round nut

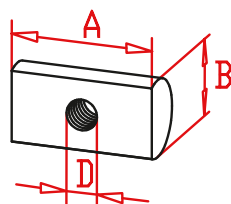

For guide body profile EL, ML, QL / QS and for fastening of jointing and mounting blocks. Material: galvanized steel

Size	Code-No.	Type	A	B	D
30	02724	M 3	28	5	2x M 3
40	02725	M 5	14	6	M 5
60 (S)	02726	M 6	18	10	M 6
80 (S)	02728	M 8	22	12	M 8
100	02729	M 8	22	16	M 8
125	02723	M10	25	20	M10

T-nut allocation

2.2

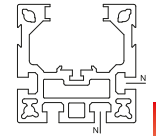
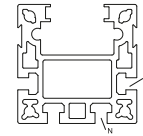
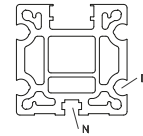
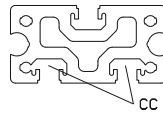
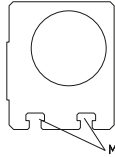
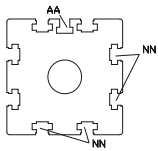

ML

LL

LS

Bearing block profile EL

Size	T-slot nut slot AA Code No.	T-slot nut slot NN Code No.
30	02715	02715
40	02710	02715
60 (S)	02710	02718
80 (S)	02714	02719
100	02714	02720
125	02736	02722

Bearing block profile ELZ

Size	T-slot nut slot M Code No.
30	02710
40	02735
60 (S)	02731 / 02719
80 (S)	02736
100	02720
125	02722

Guide body profile E

Size	T-slot nut slot CC Code No.
40	02730 / 02731
60	02730 / 02731
80	02730 / 02731

Guide body profile ML/LL/LS/ALL

Size	T-slot nut slot N Code No.	T-slot nut slot O Code No.
ML 60 (S)	02716 / 02718	02726
ML 80 (S)	02719	02728
ML 100	02720	02729
LL 60	02734	
LS 60	02734	
LS 80	02735	
ALLM 200	02737	

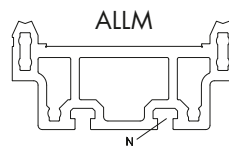

Guide body profile EL / EG

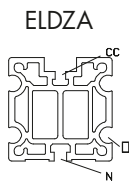
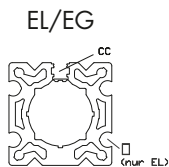

Size	T-slot nut slot CC Code No.	T-slot nut slot O Code No.	T-slot nut slot N Code No.
EL 30	02715	02724	-
EL/EG 40	02718	02725	-
EL/EG 60	02718	02726	-
EL/EG 80(S)	02718	02728	-
EL 100	02721	02729	-
EL 125	02721	02723	-
ELDZA 60(S)	02734	02726	02735
ELDZA 80(S)	02730	02728	02720
ELDZA 100	02736	02729	02720

Guide body profile DL/DS QL/QS

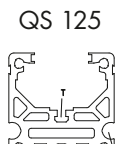
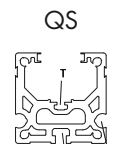
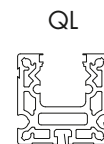
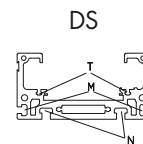
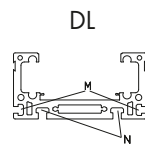

Size	T-slot nut slot N Code No.	T-slot nut slot M Code No.	T-slot nut slot T* Code No.	T-slot nut slot O* Code No.
DL/DS 120	02735	02734	02717	-
DL/DS 160	02736	02735	02739	-
DL/DS 200	02720	02736	02735	-
QL /QS 60	02734**	-	02739	02726
QL /QS 80	02735**	-	02742	02728
QL /QS 100	02720**	-	02716	02729
QS 125	02720	-	02736	02723

* only for DS/QS guide body profile
 ** not in QST/K guide body profile

Carriage profile EL / EG

Size	T-slot nut slot OO Code No.	T-slot nut slot MM Code No.
30	02715	-
40	02716 / 02709	-
60	02718	-
60 S	02736	-
80	02718 / 02719	02715
80S	02736	02735
100	02720	02713
125	02722	02720

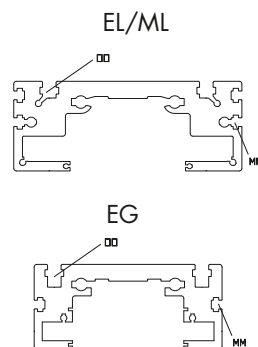

Carriage profile DL / DS / QL / QS

Size	T-slot nut slot O Code No.	T-slot nut slot M Code No.
DL/DS 120	02735	-
DL/DS 160	02736	-
DL/DS 200	02720	-
QL/QS 60	-	02735
QL /QS 80	-	02736
QL/QS 100	-	02720
QS 125	-	02722

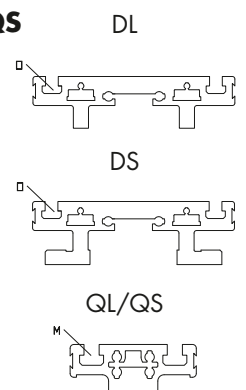

Slide nut dimensions refer to chapter 2.2 page 2

Accessories

Handwheel | Positional Indicator | Clamp

Handwheel with keyway and locking screw

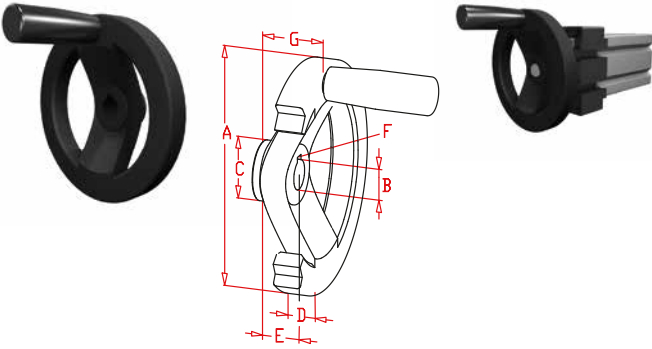

A plastic coated aluminium handwheel with a matt black finish. Equipped with a black handle.

Code-No.	Type	A	B	C	D	E	F	G
00050	30	70	6	17	13	15	-	20
00100	40	100	10	29	14,5	17	3x3	30
00160	60	140	14	36	16,5	19	5x5	36
00200	80	200	18	42	20,5	24	6x6	45
00222	100	200	22	42	20,5	24	6x6	45

Positional indicator EL / EG



Shell made of polyamide orange. Ambient temperature 80°C. Any fitting position possible. Numeral height 6 mm. Accuracy of reading 0,1 mm.

Code-No.	Size	AxBxC	D	type	pitch (mm)
00231..	30	33x47x31	6	SH	2,5 or 3
00232..	30	33x47x31	6	FH	2,5 or 3
00233..	30	33x47x31	6	SV	2,5 or 3
00234..	30	33x47x31	6	FV	2,5 or 3
00241..	40, 60, 80	48x67x51	12,17,20	SH	4 or 8
00242..	40, 60, 80	48x67x51	12,17,20	FH	4 or 8
00243..	40, 60, 80	48x67x51	12,17,20	SV	4 or 8
00244..	40, 60, 80	48x67x51	12,17,20	FV	4 or 8
00251..	40, 60, 80	48x67x51	12,17,20	SH	5 or 10
00252..	40, 60, 80	48x67x51	12,17,20	FH	5 or 10
00253..	40, 60, 80	48x67x51	12,17,20	SV	5 or 10
00254..	40, 60, 80	48x67x51	12,17,20	FV	5 or 10
00261..	100, 125	56x75x64	22,25,30	SH	6 or 12
00262..	100, 125	56x75x64	22,25,30	FH	6 or 12
00263..	100, 125	56x75x64	22,25,30	SV	6 or 12
00264..	100, 125	56x75x64	22,25,30	FV	6 or 12
00265..	40, 60, 80	48x76x39	12,17,20,30	SH	0,01 - 10
00266..	40, 60, 80	48x76x39	12,17,20,30	FH	0,01 - 10
00267..	40, 60, 80	48x76x39	12,17,20,30	SV	0,01 - 10
00268..	40, 60, 80	48x76x39	12,17,20,30	FV	0,01 - 10

0024108

Sample ordering code: size 40, 8 mm pitch increasing horizontal.

Spindle clamp EL / EG, DL / DS / QST/K

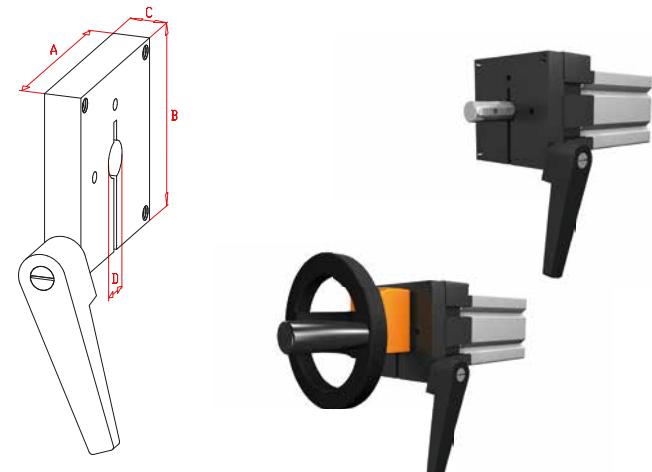

Black anodized aluminium, steel hand lever.

Code-No.	Type	A	B	C	D	Hand-lever
00291	EL/EG 30	43	50	10	6	M 6
00292	EL/EG 40	58	70	10	12	M 6
00293	EL/EG 60	80	80	15	17	M 8
00294	EL/EG 80	100	100	20	20	M10
00295	E 100	130	130	20	25	M10
00296	E 125	-	-	-	-	-
00283	DL/DS 120	62	80	15	12	M 6
00284	DL/DS 160	80	90	20	17	M 8
00285	DL/DS 200 QS 100	90	99	20	25	M 8
00286	QS 80	80	90	20	17	M 8
00287	QS 60	62	80	15	12	M 6

Accessories

Clamp | Mounting systems

Carriage clamp EL / ML / EG



Carriage with carriage clam. Carriage length can be chosen as required. Depending on type of drive (spindle or belt) the position of clamp can be different. Dimensions by inquiry.

Code-No.	Type
00311	EG 30
00312	EG 40
00313	EG 60
00314	EG 80
00301	EL 30

Code-No.	Type
00302	EL 40
00303	EL/ML 60
00304	EL/ML 80
00305	EL/ML 100
00306	EL 125

Assembly plate

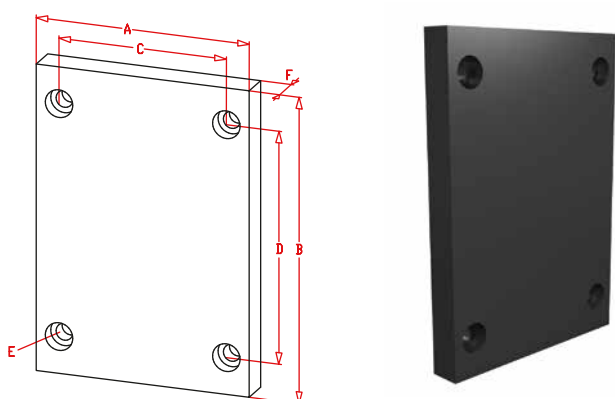

Assembly plate, anodized aluminium, enables various units to be assembled in a simple manner when combinations of linear units are to be used. Complete with screws and slide-nuts. Tapped holes can be made on request.

Code-No.	Type	A	B	C	D	E for	F
00940	EG 40	70	100	52	52	M 6	12
00960	EG 60	100	144	80	126	M 8	15
00980	EG 80	140	170	110	147	M10	15
00935	EL 30	70	70	56	56	M 6	10
00945	EL 40	100	100	66	84	M 6	12
00965	EL/ML 60	144	144	96	126	M 8	15
00964	EL/ML 60 S	170	170	108	152	M 8	15
00985	EL/ML 80	170	170	117	150	M10	15
00984	EL/ML 80 S	190	190	126	172	M 8	15
00915	EL/ML 100	230	270	155	248	M10	20
00925	EL 125	295	335	200	285	M12	20
00966	DL/DS 120	120	140	96	122	M 6	12
00986	DL/DS 160	160	180	130	162	M 8	15
00916	DL/DS 200	200	240	160	218	M 10	20
00967	QL 60	60	140	36	122	M 6	12
00987	QL 80	80	180	50	162	M 8	15
00917	QL 100	100	240	66	218	M10	20
00926	QS 60	60	165	36	147	M6	12
00928	QS 80	80	216	50	198	M8	15
00911	QS 100	100	248	66	226	M10	20

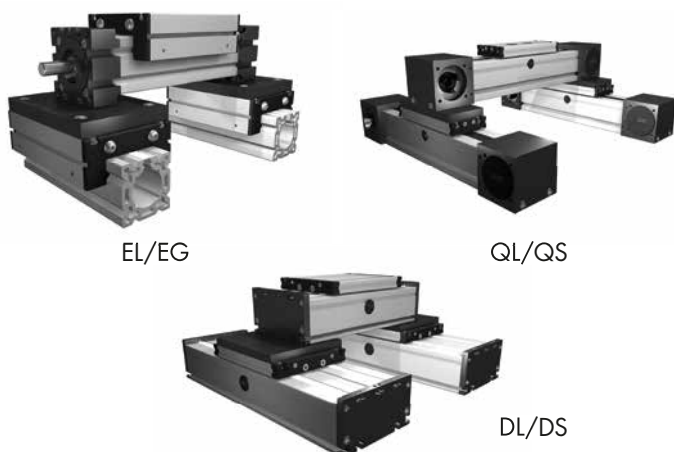

Connecting profiles DL / DS

Anodized aluminium. For joining body profiles longer than standard.

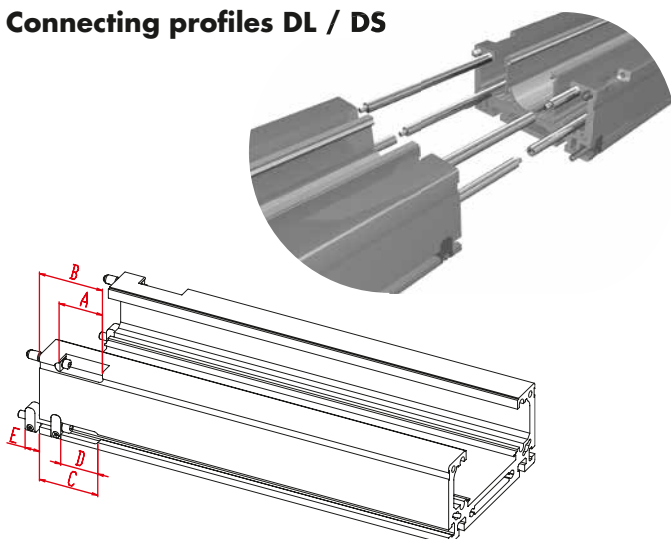

Code-No.	Type	A	B	C	D	E
03090	DS 120	47,5	66	78	56	12
03090_01	DL 120	47,5	66	78	56	12
03091	DS 160	39	58	78,5	56,5	12
03091_01	DL 160	39	58	78,5	56,5	12
03092	DS 200	53	77	71,3	45,3	17,55
03092_01	DL 200	53	77	71,3	45,3	17,55

Support and mounting block

Black anodized aluminium, for mounting and for supporting long units. These components can be ready mounted on the units by us to customer's specification. Mounting can be clear or tapped holes and slide-nuts.

2.2

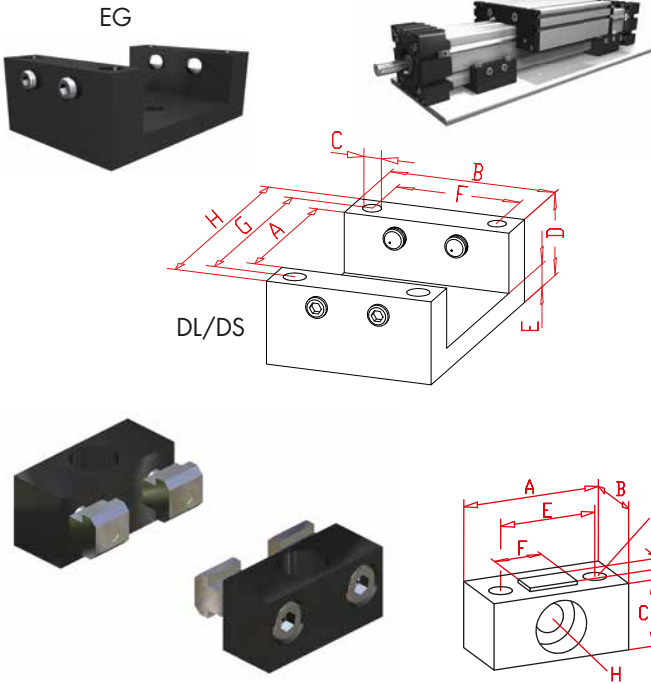

Code-No.	Type	A	B	C	D	E	F	G	H
03043	EG 40	40	40	6,5	24,0	9	1 hole	50	60
03063	EG 60	60	60	9,0	35,0	11		75	90
03083	EG 80	80	80	10,5	39,0	11		60	100

Code-No.	Type	A	B	C	D	E	F	G	H for	K for
03001	DL/DS 120	34	17	14	6	22	10	134	M6	M5
03002	DL/DS 160	40	20	19	8	28	14	179	M8	M6
03003	DL/DS 200	50	30	24	10	34	18	224	M10	M8



Mounting profile EL / ML / Q / L

Black anodized aluminium, for mounting. Mounting can be clear or tapped holes. Pair (without screws)

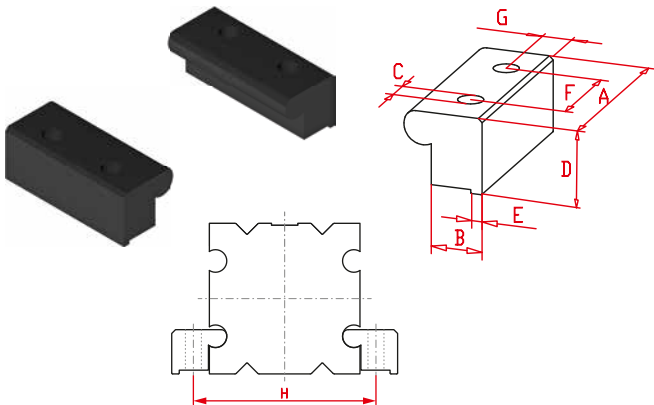

Code-No.	Type	A	B	Ø C	D	E	F	G	H
03039	EL 30	24	11,5	5,5	10	3	12	6,5	41
03049	EL 40	32	15,5	6,5	13	4	16	9	54
03069	EL/ML/Q 60	48	17,5	8,5	18	4	24	9,5	77
03089	EL/ML/Q 80	64	19,5	8,5	23,5	4	32	11,5	97
03019	EL / Q 100	80	21,5	10,5	30,5	4	40	12	120
03029	EL / QS 125	100	27	13	40	6	50	15,5	149
03009	L 60	64	19,5	9	23,5	4	32	11,5	76
03099	L 80	64	19,5	9	23,5	4	32	11,5	97

Double mounting profile EL / ML / Q / L

Black anodized aluminium. For mounting and joining body profiles longer than standard. Mounting can be clear or tapped holes. Pair (without screws)

Code-No.	Type	A	B	C	D	E	F1	F2	G	H
03039-2	EL 30	48	11,5	5,5	10	3	12	36	6,5	41
03049-2	EL 40	64	15,5	6,6	13	4	16	48	9	54
03069-2	EL / ML / Q 60	96	17,5	9	18	4	24	72	9,5	77
03089-2	EL / ML / Q 80	128	19,5	9	23,5	4	32	96	11,5	97
03019-2	EL / QL / QS 100	160	21,5	11	30,5	4	40	120	12	120
03029-2	EL / QS 125	200	27,0	13,5	40	6	50	150	15,5	149
03009-2	L 60	128	19,5	9	23,5	4	32	96	11,5	76
03099-2	L 80	128	19,5	9	23,5	4	32	96	11,5	97

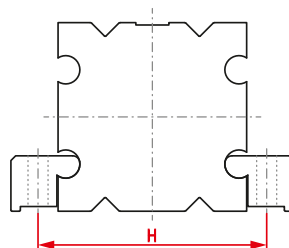
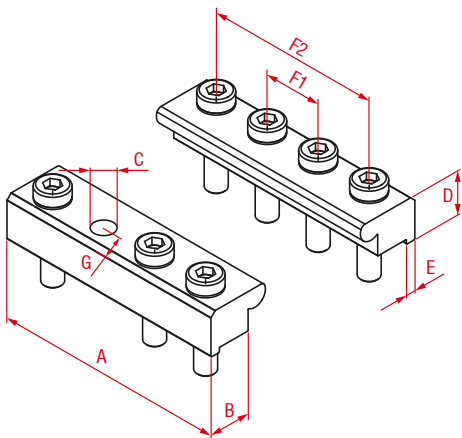

Accessories

Mounting systems

Mounting block EL / EH / ML / Q

Black anodized aluminium, for mounting and for supporting long units. These components can be ready mounted on the units by us to customer's specification. Mounting can be clear or tapped holes and slide-nuts.

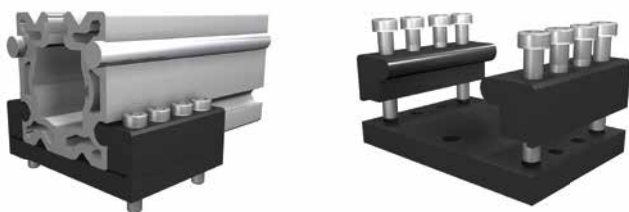

* only 1 hole

Code-No.	Type	A	B	C	E	F	G	H
030301	EL 30	54	30	*	38	10	4,2	6
030401	EL/EH 40	72	40	*	50	13	6,4	9
030601	EL/EH/ML/Q 60	96	60	*	75	18	8,5	10,8
030801	EL/EH/ML/Q 80	120	80	60	100	23,5	10,5	10,8
030101	EL/EH/ML/Q 100	144	100	70	120	30,5	10,5	14,8
030201	EL/EH/QS 125	180	125	85	150	40	11	20
030091	L 60	100	60	*	76	23,5	9	10,8
030991	L 80	120	80	60	100	23,5	10,5	10,8

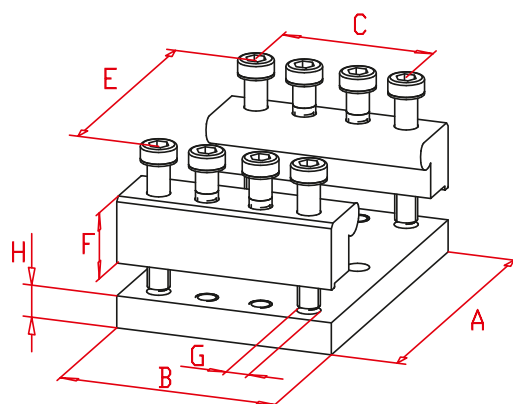

Joining profile EL / ML / Q

Black anodized aluminium. For joining body profiles longer than standard (without screws).



Code-No.	Type	A	B	C	E	F	G	M
030312	EL 30	54	60	50	38	10	4,2	10
030412	EL 40	72	80	66	50	13	6,4	14
030612	EL/ML/Q 60	96	120	100	75	18	8,5	20
030812	EL/ML/Q 80	120	160	140	100	23,5	10,5	20
030112	EL/ML/Q 100	144	200	170	120	30,5	10,5	30
030212	EL/QS 125	180	250	210	150	40	11	40

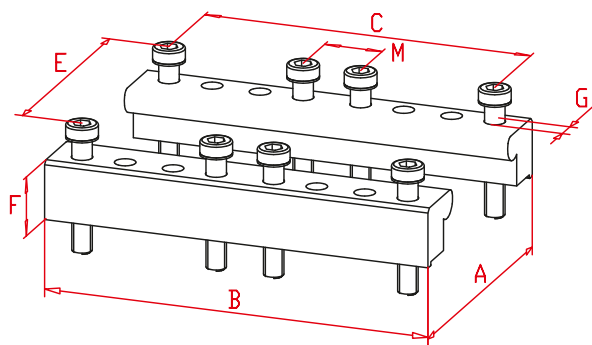

Joining block SLT

Anodized aluminium. For joining body profiles longer than standard.

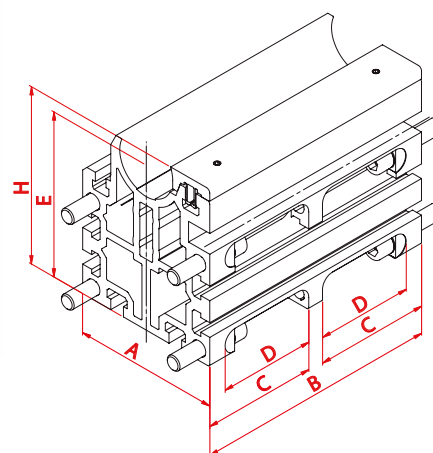

Code-No.	Type	A	B	C	D	E	H
030703	SLT 30	80	160	77	65	100	105
030705	SLT 50	120	200	93,5	79	135	145

Joining block EL / ML / Q / L

Black anodized aluminium, for jointing, mounting and supporting long units. These components can be ready mounted on the units by us to customer's specification. Mounting can be clear or tapped holes and slide-nuts.

2.2



Code-No.	Type	A	B	C	E	F	G	H	M
030311	EL 30	54	60	50	38	10	4,2	6	10
030411	EL 40	72	80	66	50	13	6,4	9	14
030611	EL/ML/Q 60	96	120	100	75	18	8,5	10,8	20
030811	EL/ML/Q 80	120	160	140	100	23,5	10,5	10,8	20
030111	EL/ML/Q 100	144	200	170	120	30,5	10,5	14,8	30
030211	EL/QS 125	180	250	210	150	40	11	20	40
030092	L 60	100	120	100	76	23,5	9	10,8	20
030992	L 80	120	160	140	100	23,5	10,5	10,8	20

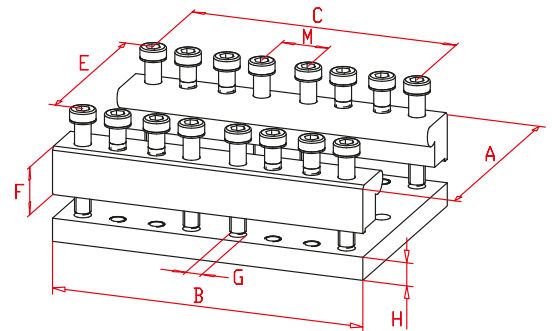

Parallel mounting block EL / ML

Black anodized aluminium. For parallel mounting of two units.

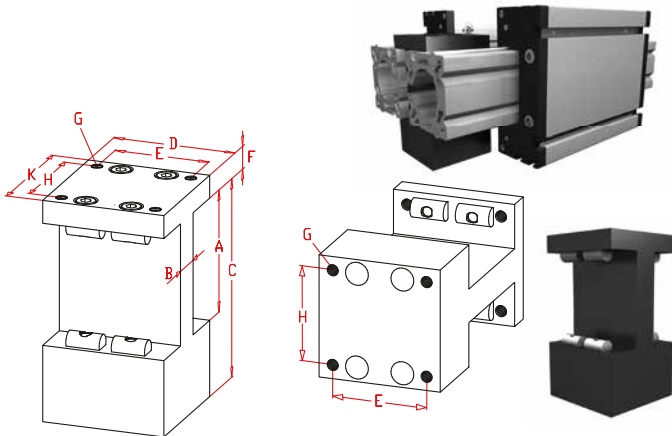

Code-No.	Type	A	B	C	D	E	F	G	H	K
03042	40	40	18	85	58	50	10	M 6	50	58
03062	60	60	22	123	70	54	15	M 8	54	70
03064	60S	60	22	120	70	54	15	M 8	54	70
03082	80	80	22	145	80	62	15	M 8	62	80
03084	80S	80	22	155	80	62	15	M 8	62	80
03012	100	120	30	200	110	90	20	M10	90	110
03022	125	125	40	253	135	115	22,5	M12	115	135

Mounting block E - units

Black anodized aluminium. Support and mounting block for E40, 60, 80. By using this mounting block you will reach the same level of heights as EL-units with support. Assembling by through holes (frame) and slide-nuts (unit).

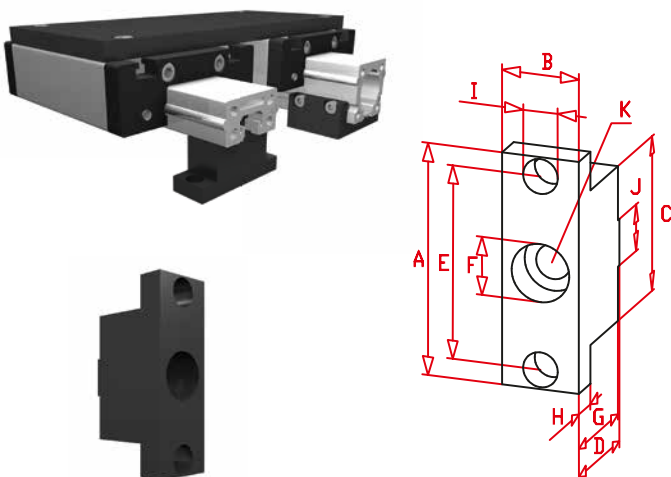

Code-No.	Type	A	B	C	D	E	Ø F	G	H	Ø I	J	Ø K
03048	E 40	60	20	40	28	50	15	27	8	6,6	12	9
03068	E 60	90	25	59	41,7	75	15	40,7	10	9	12	9
03088	E 80	120	30	80	51,8	100	15	50,8	15	10,5	12	9

Accessories

Mounting systems

Double mounting block with motor housing

Black anodized aluminium, including pulleys and belt for the drive.
Ratio 1:1

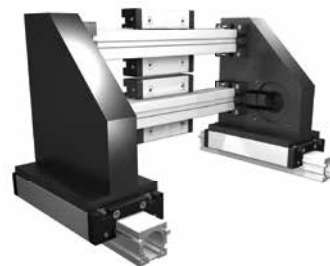
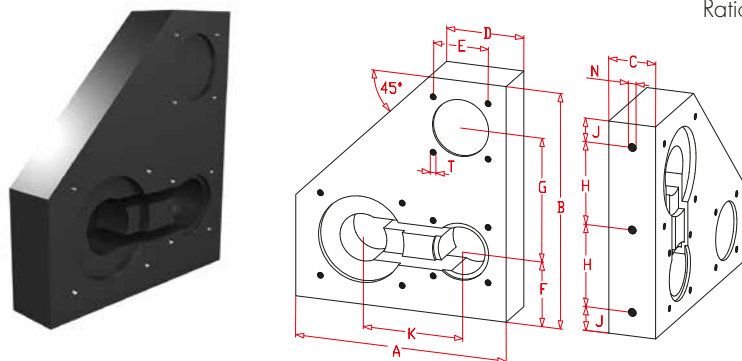

Code-No.	Type	A	B	C	D	E	F	G	H	J	K	N	T
03050	40	180	200	40	66	□ 47	55	105	70	20	85	M8	M6
03051	60	205	304	50	74	□ 68,6	80	164	87,5	15	125	M8	M8

Angular mounting block

Black anodized aluminium.

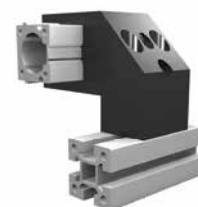
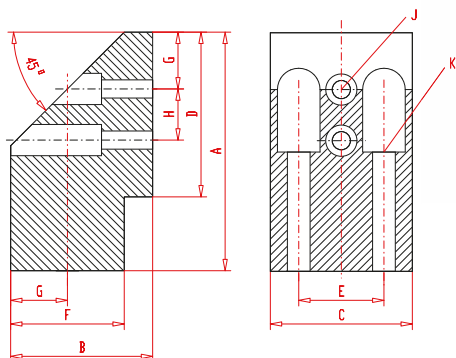

Code-No.	Type	A	B	C	D	E	F	G	H	J	K
03055	40	84	50	50	58	30	40	20	18	6,4	8,4
03056	60	117	50	59	80	36	40	20	30	9	9

Proximity / limit switch holder EG

Black anodized aluminium bracket, fixed by grub screws. Position along the length of the units is adjustable. Fixing holes for proximity and limit switches are provided.

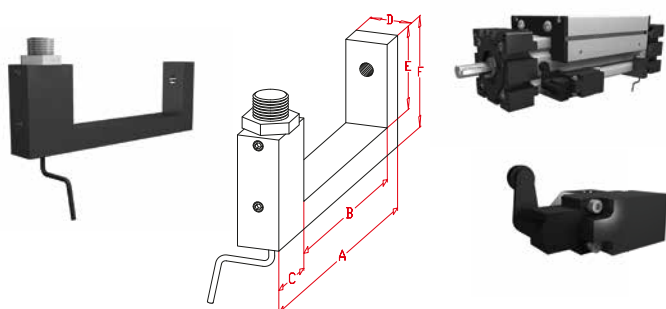

Code-No.	Type	A	B	C	D	E	F	Drill hole
01340	EG 40	72	40	24	15	19	28	8,2
01360	EG 60	92	60	24	15	26	35	12,2
01380	EG 80	114	81	24	15	30	40	12,2

Proximity / limit switch holder EL

Black anodized aluminium bracket, fixed by screws into with half-round nuts in the body half-round-slots, hence position axially adjustable. Fixing holes for proximity and limit switches are provided. Complete with screws and half-round nuts.

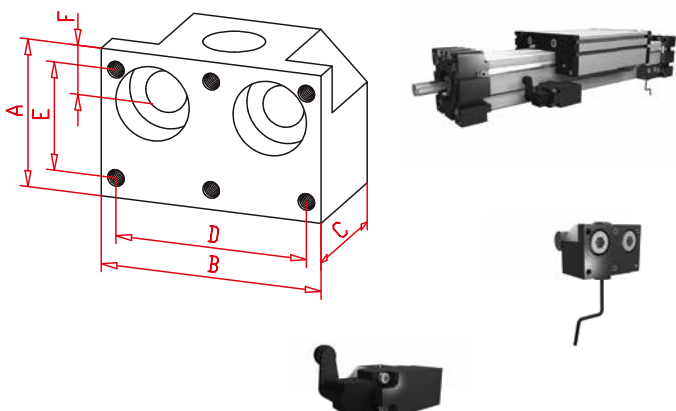

Code-No.	Type	A	B	C	D	E	F	Drill hole
01331	EL 30	12	30	12	-	-	6	8,2
01341	EL 40	28	32	25	26	22	8	8,2
01361	EL 60	30	40	25	32	22	11	12,2
01381	EL 80	30	45	25	39	22	10	12,2
01311	EL 100	40	55	20	49	22	12	12,2
01321	EL 125	45	60	25	52	22	12,5	12,2
01300	EL60-125	Reducing sleeve		Ø 12 to Ø 8				

Limit switch

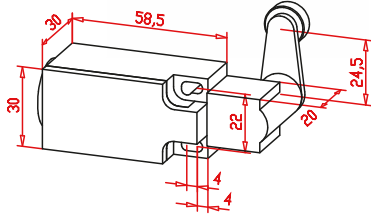
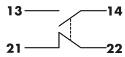

Fully insulated thermoplastic switch with adjustable operation lever. The operation device can be turned by 90°, the lever can be turned to engage by 360°.

Max. voltage	380 V
Max. constant current	6 A
Max. current at make	16 A
Duty classification	max.6000/h
Mechanical lifetime	1 x 10 ⁷
Operating repeatability	± 0,01
Transit time/snap switch	ca. 10 ms
Protection class	IP 65 (DIN 40050)
Working temperature	-30° C to +80° C

Code-No.	choice
01101	standard
01101ex	Version ATEX

Limit switch

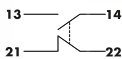

3 electromechanical switches in a row.

Nominal voltage	250 V
Cont. current	6 A
Switch rate	max.300/min.
Mech. Lifetime	>30 Mio.
Repeatability	± 0,01 mm
Transit time/snap switch	ca. 10 ms
Protection class	IP 67 (DIN 60529)
Working temperature	-5° C bis +80° C

Code-No.	choice
01105	switch system *



* consisting of 2 cam ledges and 3 cams

Proximity switch

Inductive proximity switches. Protection class IP67

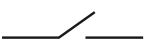

Code-No.	Type	Switching distance	Voltage	Output	Function
01003	M8	1 mm	10 - 30 V	200 mA	PNP NC
01004	M8	1 mm	10 - 30 V	200 mA	PNP NO
01001	M12	2 mm	10 - 30 V	200 mA	PNP NC
01002	M12	2 mm	10 - 30 V	200 mA	PNP NO
010014	Q 8x8	2 mm	10 - 30 V	200 mA	PNP NC
010013	Q 8x8	2 mm	10 - 30 V	200 mA	PNP NO

PNP NO (normally open) = 
 PNP NC (normally closed) = 

Proximity / limit switch holder
DL / DS / QL / QS / LL / LS

 Proximity / limit switch holder for guide body profile
 DL/DS/QL/QS/LLZ

Code-Nr.	Type
01327-0	Base holder for a limit switch
01327-1	Base holder for a proximity and a limit switch
01327-4	Base holder for a sensor bracket
01328-0	plug in holder for a proximity switch M8x1
01329-0	plug in holder for a proximity switch M12x1
01330-0	plug in holder for a proximity switch Q 8x8
01335-0	Sensor holder DL/DS 120 / QL/QS 60 H = 46,5mm
01335-1	Sensor holder DL/DS 160 H = 50,5mm
01335-2	Sensor holder QL/QS 80 H = 52,5mm
01335-3	Sensor holder DL/DS 200 H = 48 mm
01335-4	Sensor holder QL/QS 100 H = 57 mm

* stainless steel grub screws

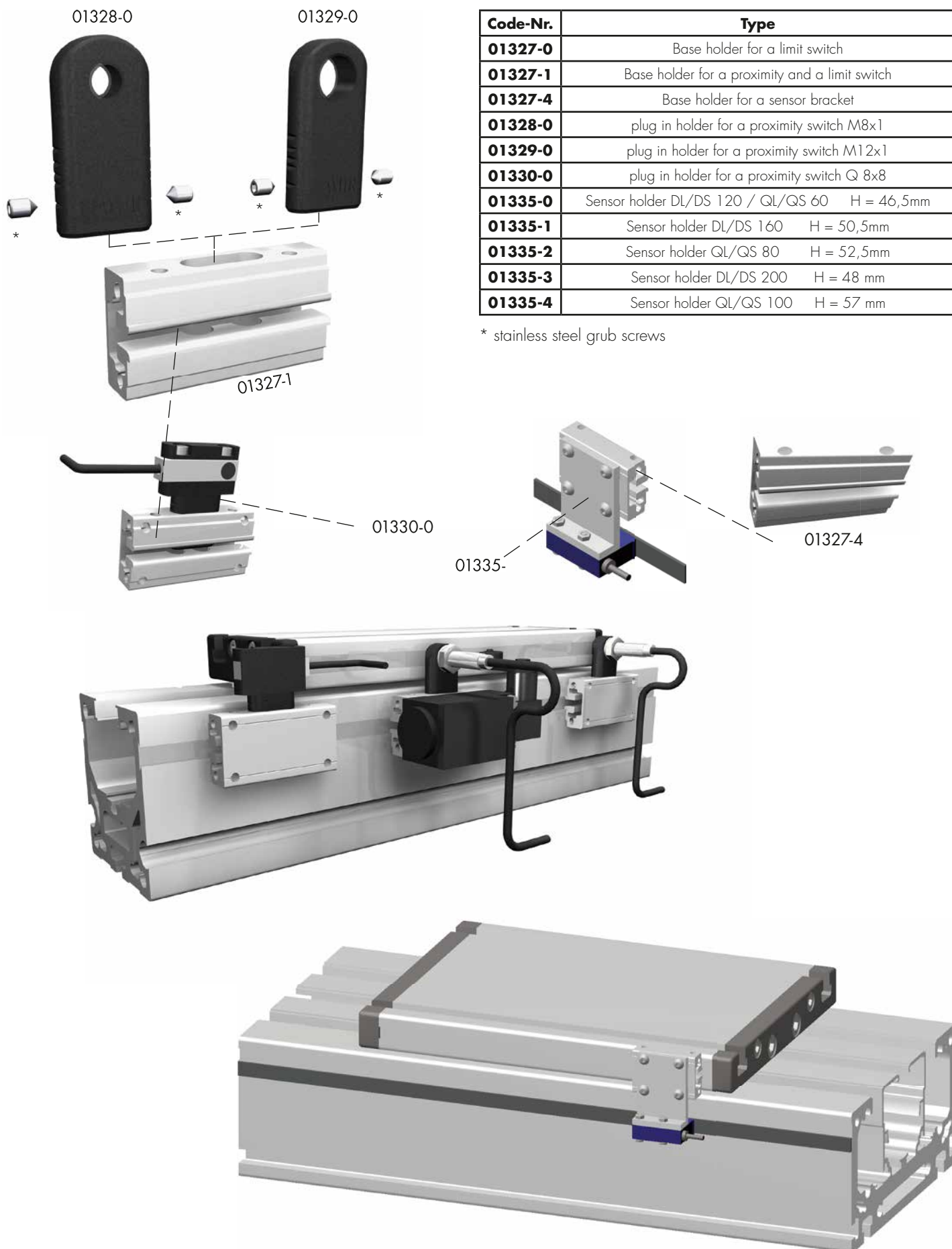

Accessories

Activating strips | Cable conduit | Cable chain

Activating strip DL / DS

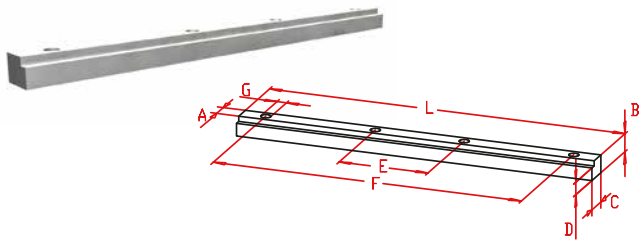

For internal proximity switches.

Code-No.	Type	A	B	C	D	E	F	G	L
04870	DL/DS 120	2,9	8,5	7	5,9	46	99	3,5	120
048710	DL/DS 160	6	6	8	4,3	30	104	3,5	120
04872	DL/DS 200	7,7	8	10	3,25	30	104	3,5	120

For external mounting proximity switches.

Code-No.	Type	Q
01000	EL 30	Carriage length
01005	EL 40	Carriage length
01006	EL/ML 60	Carriage length
01011	EL/ML 60S	Carriage length
01007	EL/ML 80	Carriage length
01010	EL/ML 80S	Carriage length
01008	EL/ML 100	Carriage length
01009	EL 125	Carriage length
010000	EG 30	Carriage length
010050	EG 40	Carriage length
010060	EG 60	Carriage length
010070	EG 80	Carriage length
01018	DL/DS 120	Carriage length
01017	DL/DS 160	Carriage length
01016	DL/DS 200	Carriage length
01030	QL/QS 60	Carriage length
01031	QL/QS 80	Carriage length
01032	QL/QS 100	Carriage length
01032	QS 125	Carriage length

Activating sheet EL / ML / EG

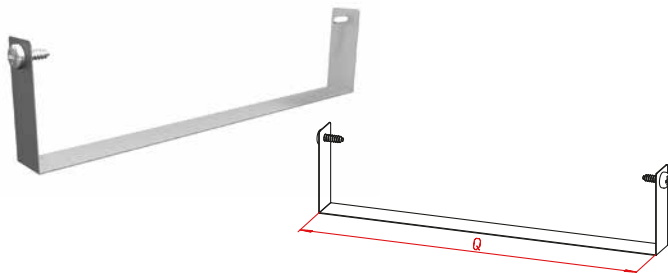

Activating sheet QL / QS - DL / DS

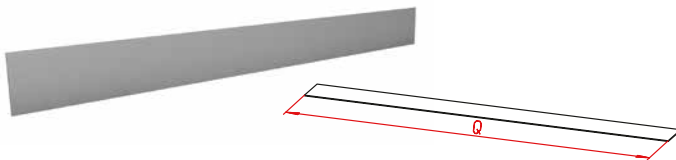

Cable conduit EL / ML / QS

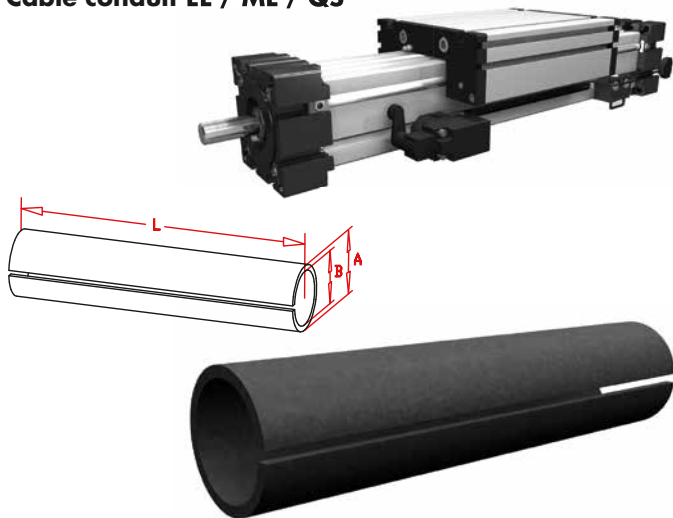

Slotted plastic tube for cabling directly onto body of linear unit. The tube can simply be pressed into the half-round slot in the body and will be securely retained there.

Code-No.	Type	A	B	L
02806	EL 40	6	4	max. 50m
02810	EL/ML/Q 60	10	7,5	max. 50m
02812	EL/ML/Q 80	12	8,5	max. 50m
02816	EL/ML/Q 100	16	12	max. 50m
02820	EL/QS 125	20	15	max. 50m

02816	1000
-------	------

Sample ordering code:
Plastic tube for EL 100, 1000 mm long.

Cable chain

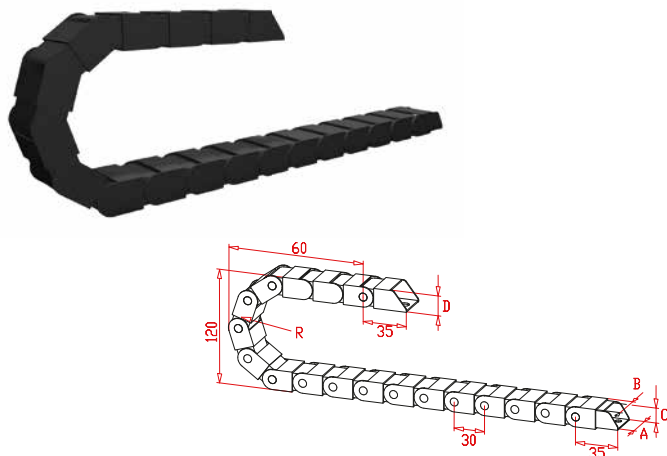

Black plastic, one floating and one fixed mounting bracket. The inner face opens like a zip, enabling cable to be inserted easily.

Code-No.	Type	Name	A	B	C	D
02115	15	Cable chain	25,5	15	18	23
02125	25	Cable chain	35,5	25	18	23
02138	38	Cable chain	48	38	18	23
02150	50	Cable chain	60	50	18	23
02116	15	fixing brackets (2 pieces)				
02126	25	fixing brackets (2 pieces)				
02139	38	fixing brackets (2 pieces)				
02151	50	fixing brackets (2 pieces)				

Accessories

Bellows | Motor adapter

Complete bellows EL / ML / EG

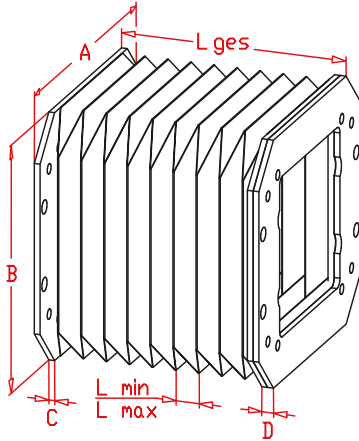

Code-No.	Type	A	B	C	D	Fold	
						L _{min}	L _{max}
02940	EL/EG 40 spindle	73	69	5	10	3	15
02941	EL/EG 40 belt drive	73	75	5	10	3	15
02960	EL/EG 60 spindle	99	94	5	10	3	20
02961	EL/ML/EG 60 belt drive	99	101	5	10	3	20
02980	EL/EG 80 spindle	130	124	5	10	3	25
02981	EL/ML/EG 80 belt drive	130	138	5	10	3	25
02910	EL 100 spindle	165	155	5	10	3	30
02911	EL/ML 100 belt drive	165	170	5	10	3	30

Bellow frame, zinc-plated plastic bellows with steel connection plates, max. 60° C.

02980	500
-------	-----

Sample ordering code: Size 80 spindle, unit length L = 500 mm.

Complete bellows DL / DS

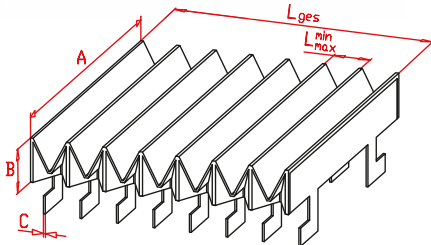

Bellow ERA7815, max. 120°, bellow frame PVC.

Code-No.	Type	A	B	C	Fold	
					L _{min}	L _{max}
02901	DL/DS 120	120	19	1	4	22
02902	DL/DS 160	160	24	1	4	31
02903	DL/DS 200	200	28	1	4	28

02902	500
-------	-----

Sample ordering code: Size 160, unit length L = 500 mm.



Motor adapter



Black anodized aluminium, can be designed for any motor. Simple assembly, accurate alignment.

Code-No.	Type
01531	EL/EG 30 spindle
01541	EL/EG 40 spindle
01561	EL/ML/EG 60 / DL/DS 120 / QS 60 spindle
01581	EL/ML/EG 80 / DL/DS 160 / QS 80 spindle
01511	EL/ML 100 / DL/DS 200 / QS 100 spindle
01521	EL 125 spindle
01831	EL 30 belt-drive
01841	EL 40 belt-drive
01861	EL/ML 60 / DL/DS 120 / QL/QS 60 / LL/LS 60 belt-drive
01881	EL/ML 80 / DL/DS 160 / QL/QS 80 belt-drive
01811	EL/ML 100 / DL/DS 200 / QL/QS 100 belt-drive
01821	EL125 / QS 125 belt-drive

Splined shaft EL / ML / EG - DL / DS

Steel splined shaft, for torque transfer between two parallel drives.
Shafts longer than 1000 mm are hollow shafts with welded journals.

2.2



Code-No.	Type	A	B1	B2	C	D	L _{max}
02230	EL/EG 30	15	8	12	2x2x12	6 _{h7}	1.500
02240	EL/EG 40	27	16	20	3x3x25	10 _{h7}	3.000
02260	EL/ML/EG 60 Q 60 D 120	35	20	24	5x5x28	14 _{h7}	3.000
02280	EL/ML/EG 80 Q 80 D 160	45	24	30	6x6x40	18 _{h7}	3.000
02210	EL/ML 100 Q 100 D 200	55	30	40	6x6x50	22 _{h7}	4.500
02220	EL/QS 125	55	40	50	8x7x50	30 _{h7}	5.000

02240	0500
-------	------

Sample order code:
Size 40, length L = 500 mm

B1 splined shaft < 1000 mm
B2 splined shaft > 1000 mm

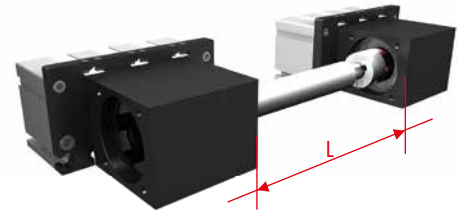
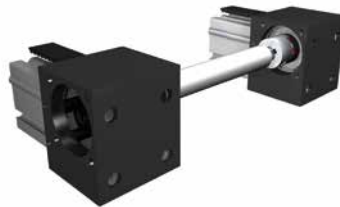
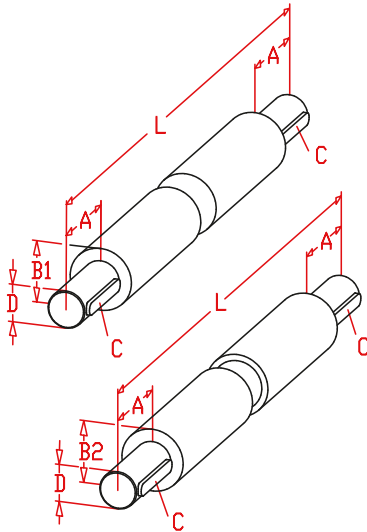

Splined shafts based on an aluminium tube

Aluminum splined shaft parallel to the torque transmission with adjustment units arranged. The splined shaft consists of an aluminum hollow shaft with bonded journals of stainless steel.

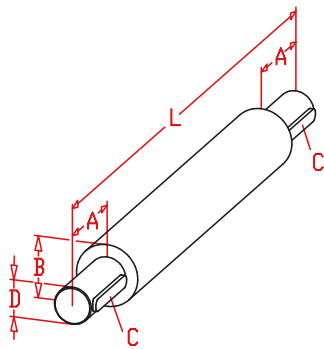
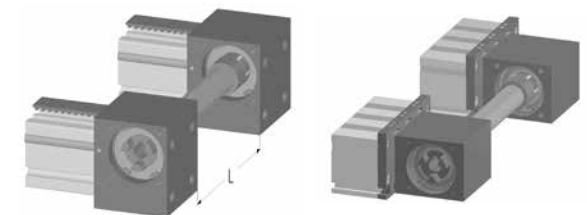
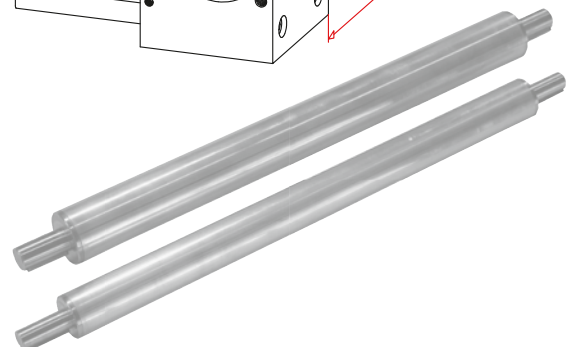
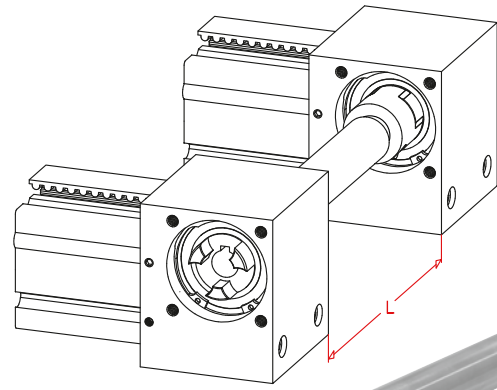

Code-No.	Type	A	B	C	D	L _{max}
02264	EL/ML/EG 60 Q 60 D 120	35	27	5x5x28	14 _{h7}	3000
02284	EL/ML/EG 80 Q 80 D 160	45	40	6x6x40	18 _{h7}	3000
02214	EL/ML 100 Q 100 D 200	55	50	6x6x40	22 _{h7}	4500
02224	EL/QS 125	55	60	8x7x50	30 _{h7}	5000

Sample ordering code:

Code-No.	L
02214	2000

Spindle shaft for EL/QL/QS 100 and DL/DS 200 with keyway, length 2000 mm

Coupling

Torsionally elastic coupling with keyway and clamp. Light pre-load provides backlash-free torque transmission. Standard spider type is 98-A. For higher torques spider type 64-D could be used as an option.

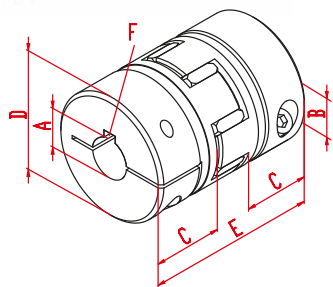

Code-No.	Type	ØA/B (min/max)	C	D	E	F	Gear ring	Shore- Scala	Torque [Nm]	
									T _{KN}	T _{K_{max}}
01400-	7	3 / 7	7	14	22	DIN-key	98	A	2	4
							64	D	2,4	4,8
01401-	9	5 / 12	10	20	30	DIN-key	98	A	5	10
							64	D	6	12
01410-	14	5 / 16	11	30	35	DIN-key	98	A	12,5	25
							64	D	16	32
01420-	19	6 / 22	25	40	66	DIN-key	98	A	21	42
							64	D	26	52
01430-	24	10 / 28	30	55	78	DIN-key	98	A	60	120
							64	D	75	150
01440-	28	18 / 38	35	65	90	DIN-key	98	A	160	320
							64	D	200	400
01450-	38	30 / 45	45	80	114	DIN-key	98	A	325	650
							64	D	405	810

01401- 08 10

Sample ordering code:

Coupling type 9, ØA = 8 mm, ØB = 10 mm

Coupling for toothed belt units

Torsionally elastic coupling with keyway and clamp. Light pre-load provides backlash-free torque transmission.

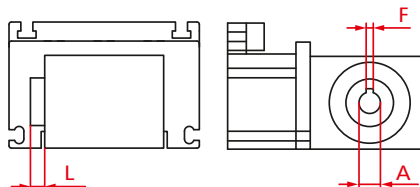

Code-No.	Type	Ø A (min/max)	L	Size	F	Gear ring	Shore- Scala	Torque [Nm]	
								T _{KN}	T _{K_{max}}
03400-	7	3 / 7	7	EL 30	DIN-key	98	A	2	4
						64	D	2,4	4,8
03401-	9	5 / 12	10	EL 40	DIN-key	98	A	5	10
						64	D	6	12
03410-	14	5 / 16	11	EL/ML 60 D 120 Q 60	DIN-key	98	A	12,5	25
						64	D	16	32
03420-	19	6 / 22	25	EL/ML 80 D 160 Q 80	DIN-key	98	A	21	42
						64	D	26	52
03430-	24	10 / 28	30	EL/ML 100 D 200 Q 100	DIN-key	98	A	60	120
						64	D	75	150
03440-	28	18 / 38	35	EL/QS 125	DIN-key	98	A	160	320
						64	D	200	400

03410- 12

Sample ordering code:

Coupling type 14, ØA = 12 mm

Coupling with tension ring

Coupling, to be clamped by tension ring.

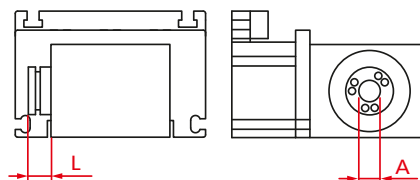

Code-No.	Type	Ø A	L	Size	Gear ring	Shore- Scala	Torque [Nm]	
							T _{KN}	T _{K_{max}}
03501-	14	5, 10, 14	19	EL/ML 60 D 120 Q 60	98	A	12,5	25
					64	D	16	32
03510-	19	10, 14, 16, 19	25	EL/ML 80 D 160 Q 80	98	A	21	42
					64	D	26	52
03520-	24	19, 20, 22, 24	30	EL/ML 100 D 200 Q 100	98	A	60	120
					64	D	75	150
03530-	28	38	35	EL/QS 125	98	A	160	320
					64	D	200	400

03510- 16

Sample ordering code:

Coupling type 19, ØA = 16 mm

Synchronous coupling

Coupling for synchronizing of two parallel units.
Light pre-load provides backlash-free torque transmission.

2.2

Code-No.	Type	Ø A	Ø D	E	Ø F	G	H	Gear ring	Shore-Scala	Torque [Nm]	
										T _{KN}	T _{K max}
03411	14	14	30	35	33,6	23,5	11,5	98	A	12,5	25
								64	D	16	32
03421	19	18	40	41	46	25	16	98	A	21	42
								64	D	26	52

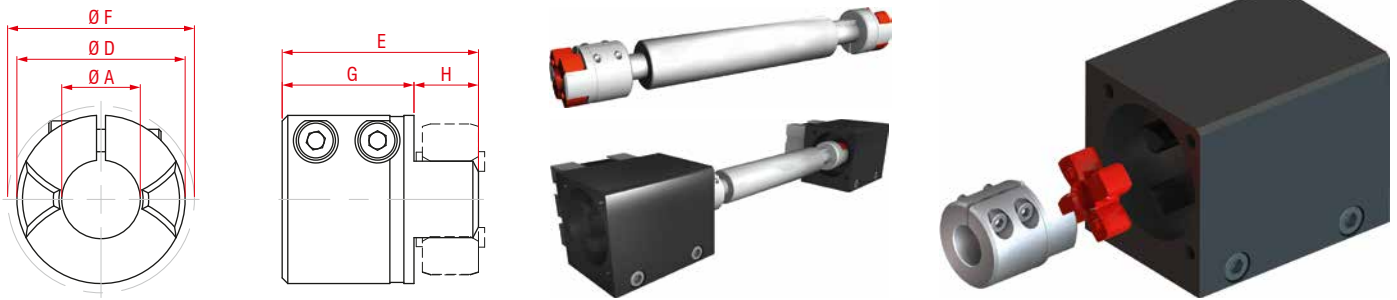

Code-No.	Type	Ø A	Ø D	E	Ø F	G	H	J	Gear ring	Shore-Scala	Torque [Nm]	
											T _{KN}	T _{K max}
03412	14	19 19,05	40	50	44	38,5	11,5	32	98	A	12,5	25
		22 24							64	D	16	32

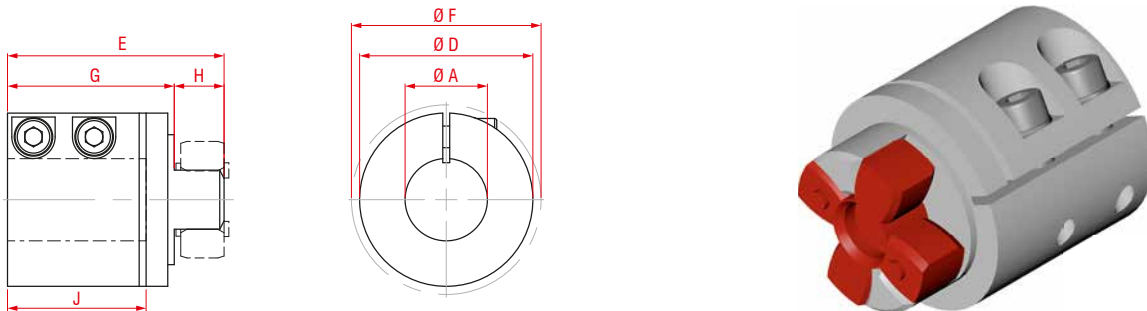

Flange coupling

Code-No.	Type	Ø A	Ø B	Ø C	Ø D	E	F	G	H	Gear ring	Shore-Scala	Torque [Nm]	
												T _{KN}	T _{K max}
039265	14	43	40	31,5	5	24	12,5	3	5	98	A	12,5	25
										64	D	16	32

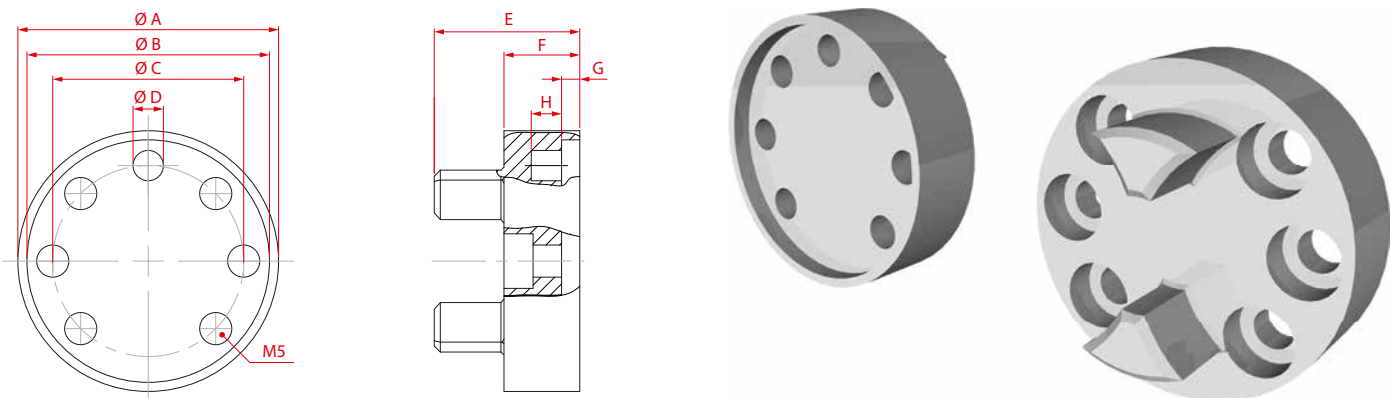

Accessories

Bevel gear | Combination cube

Bevel gear pair EL / EG

C 45 steel, helical gear, with keyway.

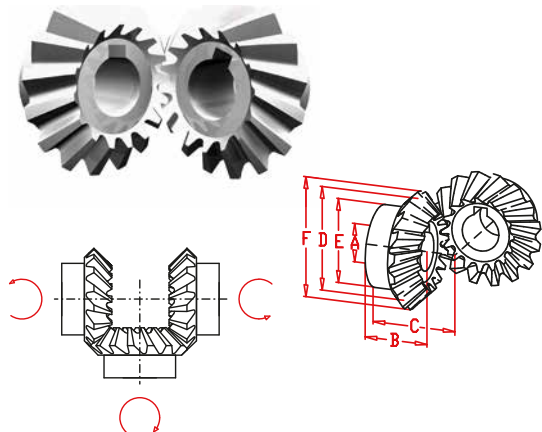

Code-No.	Type	i	Modul	Number of teeth	A ₁₇	B	C	D	E	F	max. rpm (min ⁻¹)
00641	40	1:1	2	16	10	13	28	-	22	35	560
00642	40	1:1,5	1,5	16	10	17	30	24	20	27	560
				24		17,5	27	36	26	38	840
00661	60	1:1	2,5	16	14	18,5	33	-	30	43	750
				24		21	38	32	26	36	560
00662	60	1:1,5	2	16	14	23	35	48	35	51	840
				24		23	35	48	35	51	840
00681	80	1:1	3	16	18	23	40	-	35	51,5	750
				24		28	54	48	40	53	560
00682	80	1:1,5	3	16	18	28	54	48	40	53	560
				24		30	49	72	50	76	840
00611	100	1:1	4	16	22	35,5	54	-	45	69,7	750
				24		27,7	50	48	34	53	560
00612	100	1:1,5	3	16	22	31	44	72	38	76	840
				24		31	44	72	38	76	840

2.2

Combination cube EL / EG Cover caps

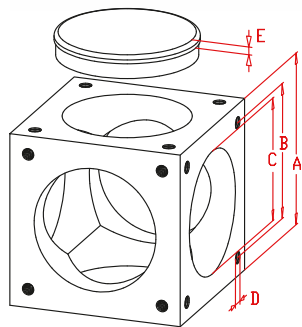

Combination cube					
Code-No.	Type	A	B	C	D
00830	30	52	35	40	M 4
00840	40	66	47	48	M 6
00860	60	92	69	62	M 8
00880	80	112	88	80	M 8
00810	100	148	112	110	M10

Cover caps		
Code-No.	Type	E
01830	30	2
01840	40	5
01860	60	6
01880	80	6
01810	100	3

Black plastic.
To cover empty cube sides.

Black anodized aluminium. Used for connecting modules at right angles or in line.

Telescopic shaft

Code-No.	Description	A stroke	B	C	D	Torque [Nm]	
						Mt dyn.	Mt stat.
039660	Telescopic shaft	223	355	578	60	17	39
039760	Universal joint						
039860	Torque ball bushing						

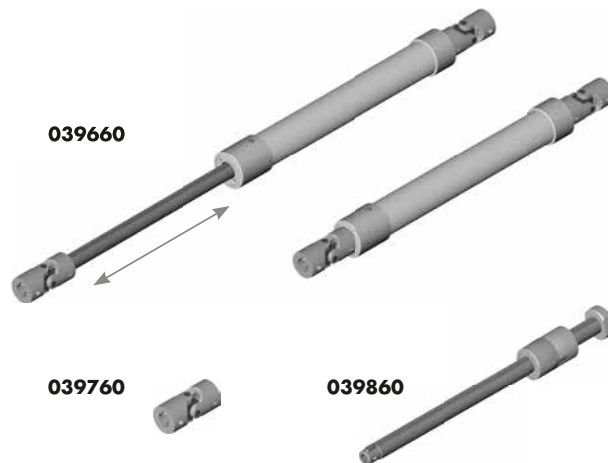
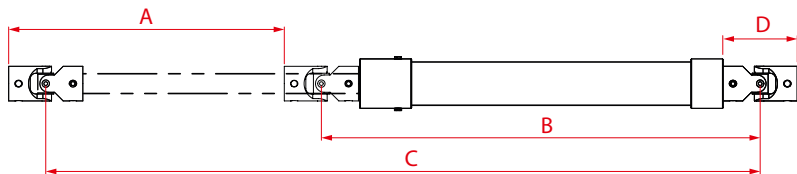

Accessories

Angular gear box | Transmission unit | Toothed pulley

Angular gear box EL / EG

2.2

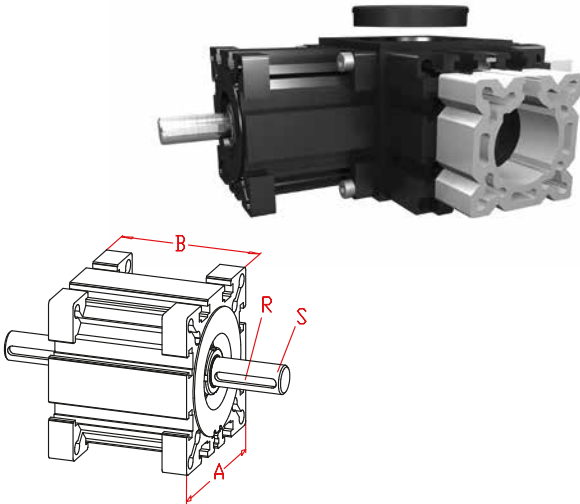

Code No.	Type	i	m	A	B	R	S ∅ x l	Torque	max. rpm(min ⁻¹)
00731	30	1:1	1	42	38	-	5x15	2 Nm	250
00741	40	1:1	2	58	50	3x3	10x27	5 Nm	560
00742	40	1:1,5	1,5	58	50	3x3	10x27	5 Nm	560 840
00761	60	1:1	2,5	82	70	5x5	14x35	15 Nm	750
00762	60	1:1,5	2	82	70	5x5	14x35	15 Nm	560 840
00781	80	1:1	3	102	90	6x6	18x45	25 Nm	750
00782	80	1:1,5	3	102	90	6x6	18x45	25 Nm	560 840
00711	100	1:1	4	130	110	6x6	22x45	30 Nm	750
00712	100	1:1,5	3	130	110	6x6	22x45	30 Nm	560 840

Complete self-centering gear. Can easily be retrofitted to any EG or EL unit. Packed with grease for lubrication.

Transmission unit EL / EG

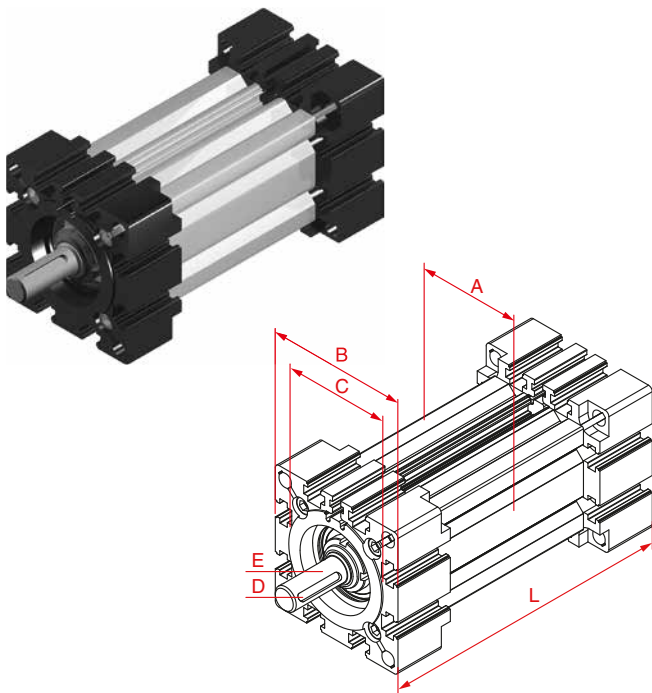

A shaft carried on ball bearings in an aluminium hollow section can be used to transmit torque or as a joining element for combining parallel linear units or as an individual element in angular operation.

Code-No.	Type	A	B	C	D	E	L _{min}	L _{max}
01931	30	30	42	40 x 0,7	-	5 x 15	38	3.000
01932	30 no shaft	30	42	40 x 0,7	-	-	38	3.000
01941	40	40	58	48 x 1	3 x 3	10 x 27	50	6.000
01942	40 no shaft	40	58	48 x 1	-	-	50	6.000
01961	60	60	82	62 x 1	5 x 5	14 x 35	100	6.000
01962	60 no shaft	60	82	62 x 1	-	-	100	6.000
01981	80	80	102	80 x 1	6 x 6	18 x 45	90	6.000
01982	80 no shaft	80	102	80 x 1	-	-	90	6.000
01911	100	100	130	110 x 1	6 x 6	22 x 45	110	6.000
01912	100 no shaft	100	130	110 x 1	-	-	110	6.000

01941 0750 Sample order code: Size 40, length L = 750 mm

Toothed pulley HTD

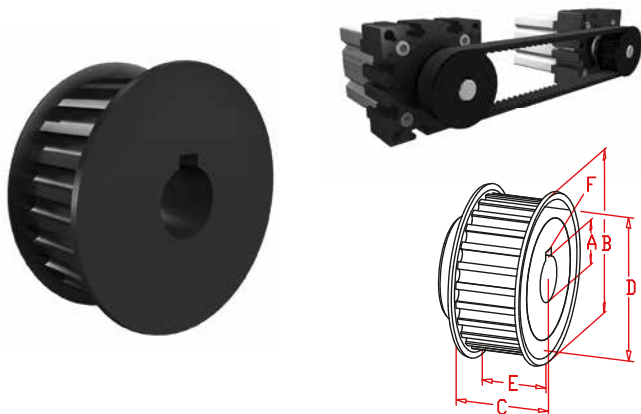

Material St 50, secured with key.

Code-No.	Type	A	B	C	D	E	F	Number of teeth	Spacing
00450	EL/EG 30	6	23	26	18,3	15	2x2	20	3x15
00451	EL/EG 40	10	36	26	30,7	15	3x3	20	5x15
00452	EL/EG 60 DL/DS120	14	44	38	40,2	25	5x5	26	5x25
00453	EL/EG 80 DL/DS160	18	54	38	49,8	25	6x6	32	5x25
00454	EL100	22	66	48	61,1	38	6x6	24	8x30

Accessories

Toothed belt | Parallel transfer unit | Incremental encoder

Toothed belt endless HTD



Code-No.	Type	Belt	Tensile force
00550	EL/EG 30	3M15	200 N
00551	EL/EG 40	5M15	390 N
00556	EL/EG 40	5M09	298 N
00552	EL/EG60	5M25	894 N
00553	EL/EG80	5M25	894 N
00554	EL100	8M30	1070 N
00555	EL100	8M20	980 N

00551	0700
-------	------

Sample order code:
Belt 5M15 perimeter: 700 mm

Parallel transfer unit for spindle drives

DL / DS

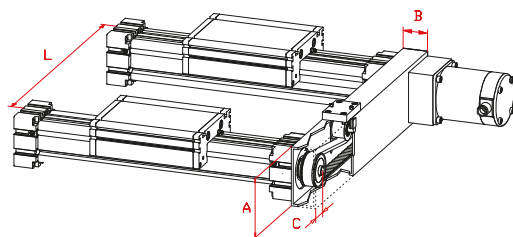

EL / EG / Q



Black anodized aluminium tube with plastic end caps, pulleys fixed with keys or tension rings. Spindle centers are multiples of 5 or 8 mm, according to belt pitch.

Code-No.	Type	A	B	C	L _{max}	Belt
T13030	EL/EG 30	50	25	25	1.200	5M 9
T13040	EL/EG 40	80	40	30	1.500	5M 15
T13060	EL/EG/Q 60	100	50	42	2.000	5M 25
T13061	DL/DS 120 *	60	50		2.000	5M 25
T13080	EL/EG/Q 80	120	50	52	2.000	5M 25
T13081	DL/DS 160 *	80	50		2.000	5M 25
T13010	EL/Q 100	160	80	66	3.000	8M 30

* Parallel transfers are special designed parts. Dimensions given in the documentation are samples.

T13060	500
--------	-----

Sample ordering code: Center-distance of axis L = 500 mm

For center-distances higher than 800mm you have to use an additional tensioning device code-number 04099.

Incremental encoder



Incremental encoders with plug.

500 increments per revolution - other resolutions on request.

Code-No.	A	B	C	D	E	F	G	H	J	K for
E 05500	57,5	4	50 _{h7}	6 _{h9}	10	58,5	120°	65	3	M3

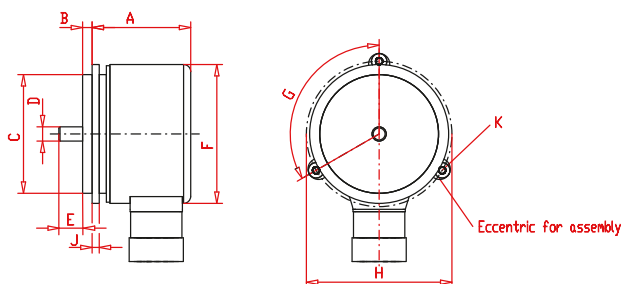

Guide carriage with brake / QS 80, QS 100, QS 125

Dimensions (mm)

2.2

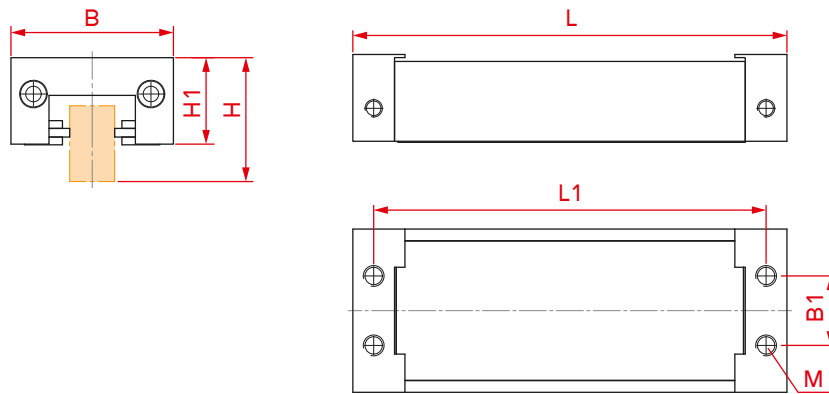
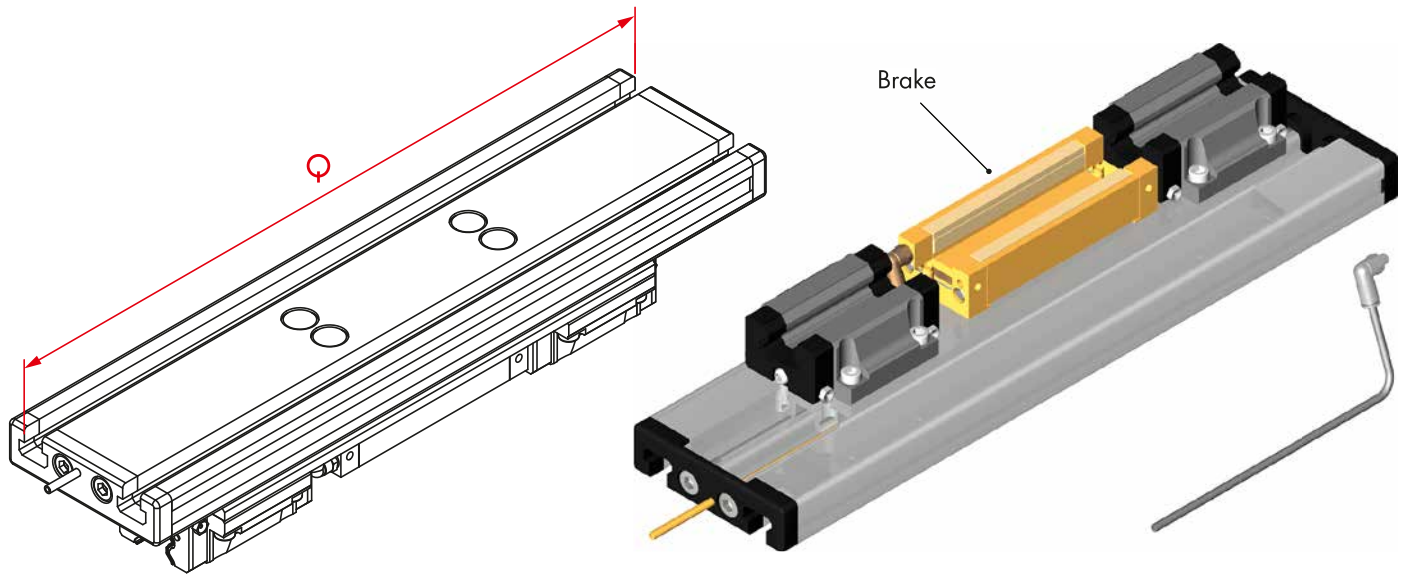

Code-No.	Type	Q	Rail size	B	B1	H	H1	H	H1	L	L1	M	Holding force at 6 bar	Holding force at 4 bar	Mass brake
04573-80	QS 80	356	20	43	15	30	19,5	-	-	105,5	93,2	M5	900 [N]	540 [N]	0,32 kg
04573-100	QS 100	410	25	47	20	36	25,0	40	29,0	125,5	113,5	M6	1200 [N]	780 [N]	0,50 kg
04573-125	QS 125	440	30	59	24	42	29,5	45	32,5	141,5	121,5	M8	1800 [N]	1100 [N]	0,90 kg

If required, several brake units are used to achieve greater braking power. In that case the carriage will be correspondingly longer, i. e. by the length of the unit.

Function:

The carriage is equipped with the brake / clamping unit.

LinClamp S/SK loosened: The chamber between the two spring steel membranes is pressurized. This leads to an elastic deformation of the spring steel sheets which are shortened in horizontal direction. As a result, the clamping body is deformed so that it becomes narrower at the top together with the spring steel sheets and wider at the bottom in the area of the brake shoes. As a consequence, the brake shoes are lifted from the rail and the chock can move freely.

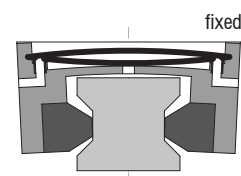
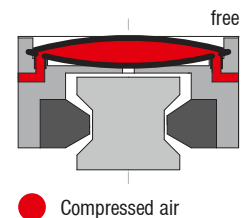

LinClamp S/SK clamped: The chamber between the two spring steel membranes is deaerated. The spring steel sheets have a tendency to spring back into their normal position, thereby widening the upper part of the clamping body. At the same time, this widening at the top results in a narrowing at the bottom. Due to this narrowing, the brake shoes are pressed towards the rail and fix it.

Guide carriage with brake / DS 200, DSZPVI 200

Dimensions (mm)

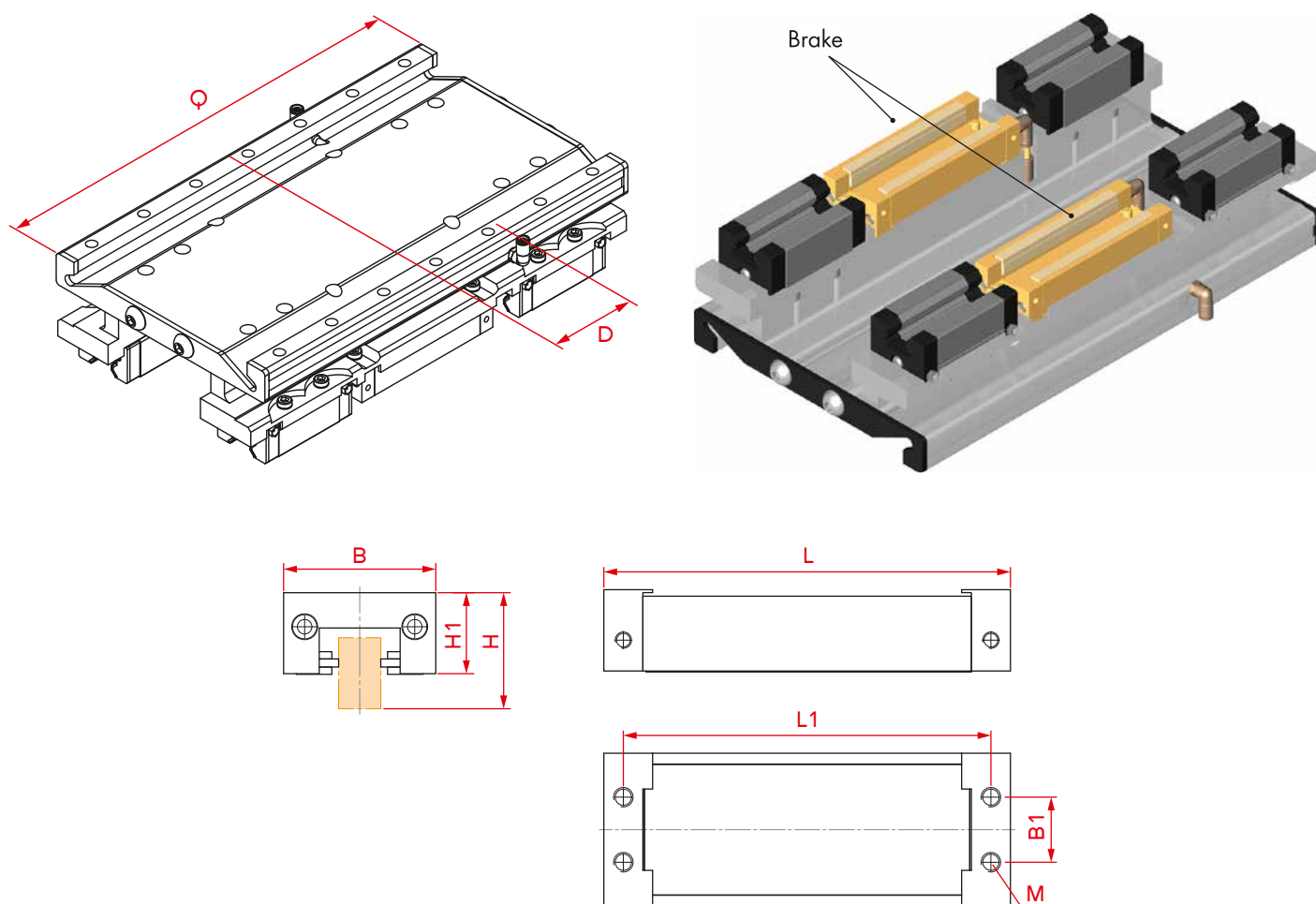

2.2

Code-No.	Type	Q	D	Rail size	B	B1	H	H1	H	H1	L	L1	M	Holding force at 6 bar	Holding force at 4 bar	Mass brakes
04573-200	DS / DSZPVI 200	348	65	25	47	20	36	25	40	29	125,5	113,5	M6	2400 [N]	1560 [N]	1,00 kg

If required, several brake units are used to achieve greater braking power. In that case the carriage will be correspondingly longer, i. e. by the length of the unit.

Function:

The carriage is equipped with the brakes / clamping unit.

2.2