

## ESD-ACCESSORIES



ESD (Electro Static Discharge) is the electrostatic discharge of charged objects or persons by direct contact or sparks. The cause of ESD are electrical charges which are generated by charge separations or as a result of influences in electrical fields. Sources of this charge may be people and their clothes

- workplace equipment including floors,
- packaging equipment and tools

Electrostatically sensitive devices, especially semiconductor components

Protective measures for electrostatically sensitive components

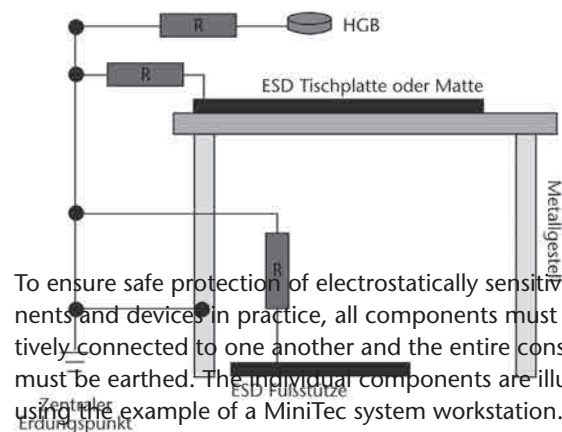

To ensure safe protection of electrostatically sensitive components and devices in practice, all components must be conductively connected to one another and the entire construction must be earthed. The individual components are illustrated using the example of a MiniTec system workstation.

## EARTHING BOX ESD

Part no.

32.1002/0

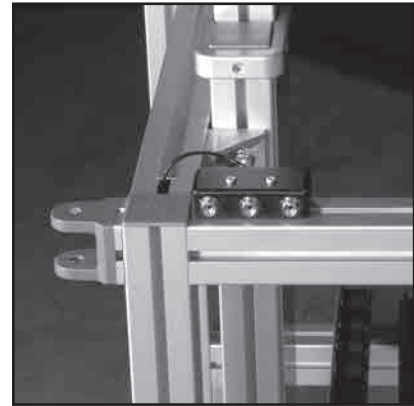
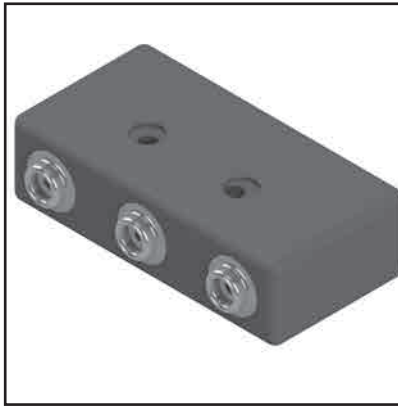
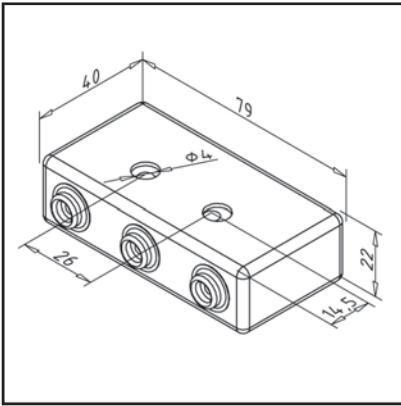

### TECHN. DATA / ITEMS SUPPLIED

- Earthing cable 2 m length
- Connection type: 4mm eye
- 1 MOhm safety resistor per connection
- 3x 10 mm push button connection
- Weight = 0.061 kg/piece

### APPLICATIONS

- Earth connection point EBP for personnel grounding

### ASSEMBLY

- Tighten to table plate with chipboard screw  $\varnothing 4 \times 30$
- Fix with cyl. screw M4 x 30 **part no. 21.1285/0** and 2x square nut M4 **part no. 21.1310/2** onto profile

## EARTH CONDUCTOR ESD

Part no.

32.1004/0

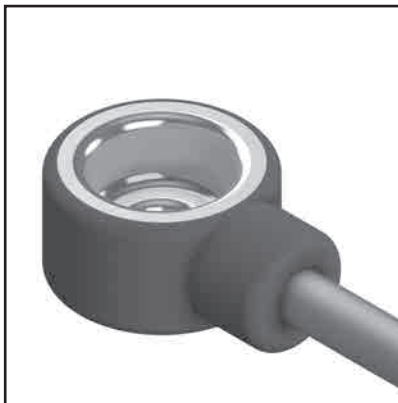
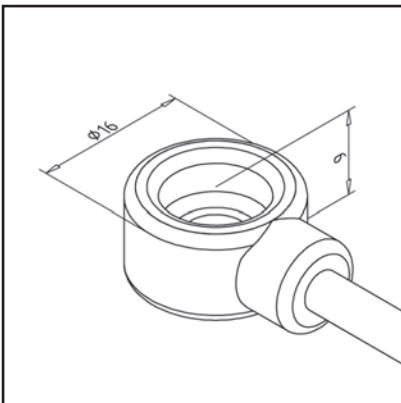

### TECHN. DATA / ITEMS SUPPLIED

- 1 MOhm safety resistance
- 10 mm push button / 4 mm eye
- Length: 3 m
- Weight = 0.019 kg/piece

### APPLICATIONS

- For table and floor coverings

### ASSEMBLY

- Connect as central grounding **part no. 32.1003/0** box ESD
- Clip onto table pad

**CENTRAL EARTHING BOX ESD**

Part no.

32.1003/0

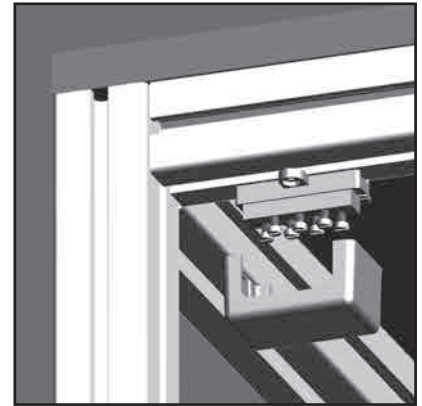
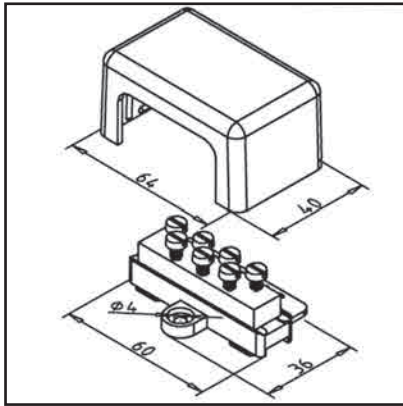
**TECHN. DATA / ITEMS SUPPLIED**

- Terminal strip for connection of max. 7 earthing cables
- With screw connections for lugs with 4 mm eye
- Weight = 0.072 kg/piece

**APPLICATIONS**

- Suitable for contacting earthing conductors to ESD or protective ground

**ASSEMBLY**

- Attach to the tabletop with accessories from scope of supply

**DUMMY PLUG WITHOUT RESISTOR**

Part no.

32.1001/0

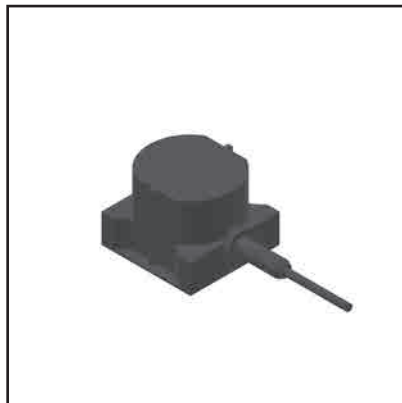
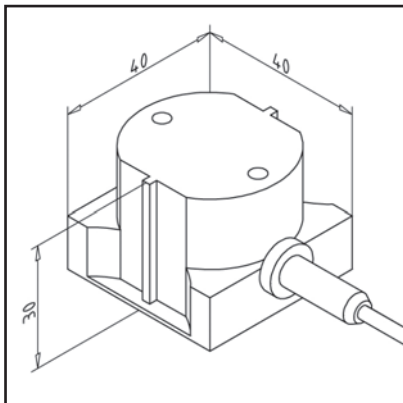
**TECHN. DATA / ITEMS SUPPLIED**

- Dummy plug for Schuko outlet
- With 2m smooth cable
- Connection type: 4mm eye
- Weight = 0.048 kg/piece

**APPLICATIONS**

- For direct earthing of tabletops and floor coverings or the central earthing strip

**ASSEMBLY**

- Connect to central grounding box **part no. 32.1003/0**
- Plug into suitable Schuko outlet

## SPIRAL CABLE HIGHLY ELASTIC

Part no.

32.1017/0



### TECHN. DATA / ITEMS SUPPLIED

- Spiral cable; highly elastic, black
- 10mm / 10mm pushbutton
- 1 MOhm
- Length: 1,80 m
- Weight = 0.041 kg/piece

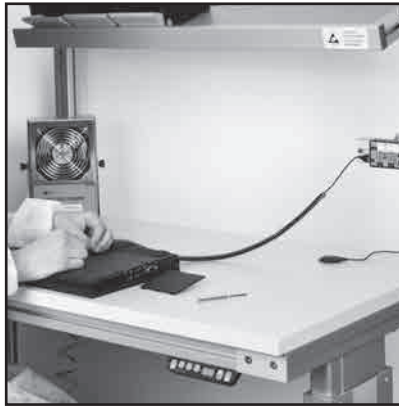

### APPLICATIONS

- For connecting wristlets onto earthing box

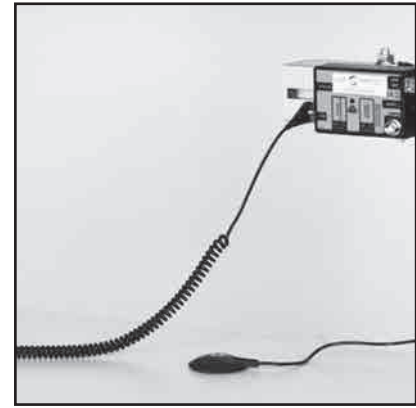

### ASSEMBLY

- Fasten spircal cable with push button onto earthing box and wristlet

## ELASTIC WRIST STRAP

Part no.

32.1018/0

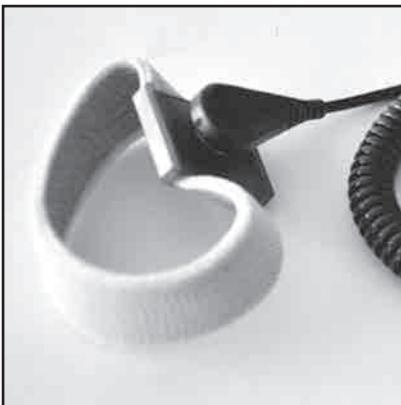

### TECHN. DATA / ITEMS SUPPLIED

- Wristlet blue
- Push-button 10mm
- Weight = 0.013 kg/piece



### APPLICATIONS

- Earthing of humans



### ASSEMBLY

- Attach to the wrist and connect to the grounding box via spiral cable

## EARTHING CABLE ESD AREA

Part no.

32.1013/0

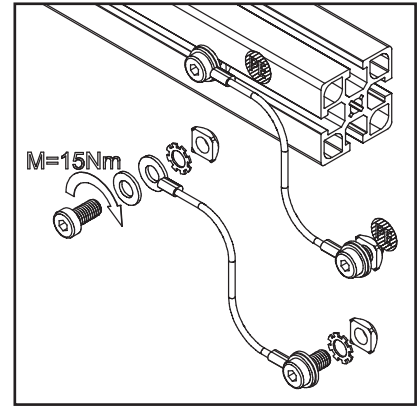
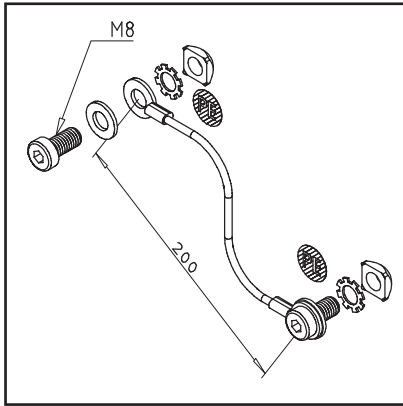

### TECHN. DATA / ITEMS SUPPLIED

- Earthing cable for ESD areas
- Core H07V-K 4mm<sup>2</sup> Length: 200 mm
- Weight = 0.053 kg/piece

### APPLICATIONS

- For earthing work tables and structures between profile and profile
- For earthing of work tables and constructions between profiles and panel element

### ASSEMBLY

- Fasten both sides with M8
- Fasten to profile groove with supplied hardware.

## EARTHING POINT

Part no.

32.0769/0

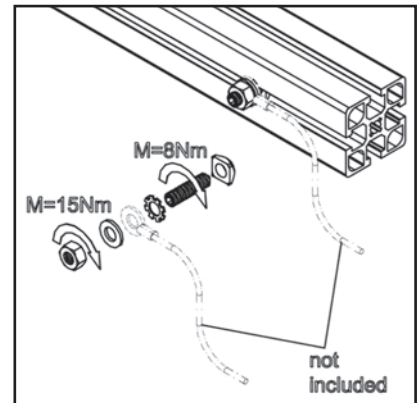
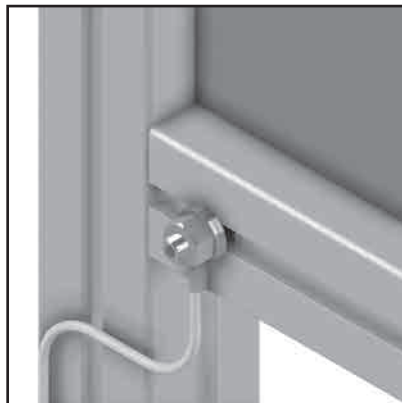
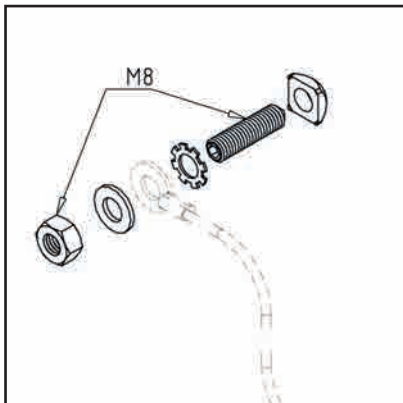

### TECHN. DATA / ITEMS SUPPLIED

- Threaded pin M8x30
- Sliding nut - Z M8
- Tooth lock washer
- washer
- hexagon nut
- Weight = 0.022 kg/piece

### APPLICATIONS

- For earthing workstations and constructions

### ASSEMBLY

- Mount in the profile groove according to the enclosed installation drawing

## HANDLE 120 ESD, BLACK

Part no.

32.1007/0

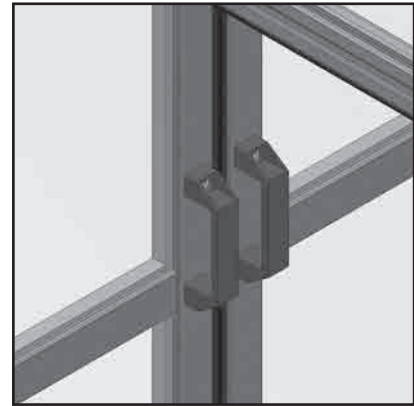
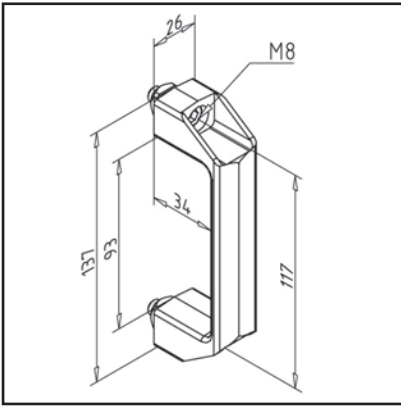

### TECHN. DATA / ITEMS SUPPLIED

- PA, black
- Fastening kit
- Weight = 0.073 kg/piece

### APPLICATIONS

- Doors
- Lids
- Guard units

### ASSEMBLY

- Fasten to profile groove with supplied hardware.
- Directly on surface element with cylinder head screw M8
- Also assembly possible from rear side

## CONNECTING PLATE 45X90, CONDUCTIVE

Part no.

21.1472/6

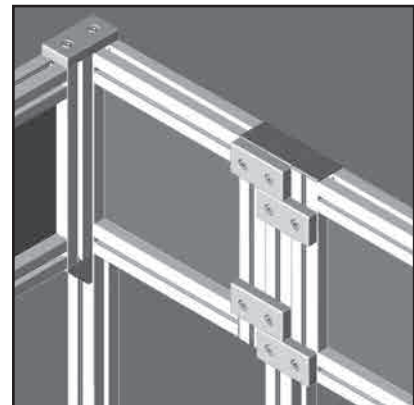
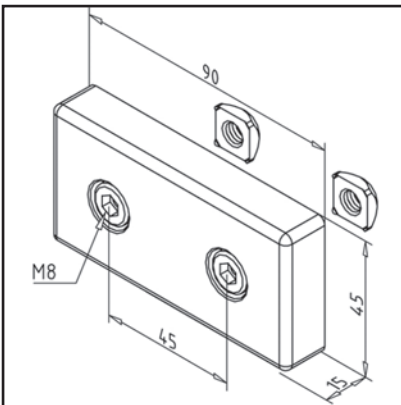

### TECHN. DATA / ITEMS SUPPLIED

- Aluminium, Pressure die-casting, bright
- With fastening material steel, zinc plated
- Weight = 0.180 kg/piece

### APPLICATIONS

- Connection of two guards without gap
- Strengthening of guard units
- Connection of pre-assembled modules

### ASSEMBLY

- Install to groove of protective field and posts with supplied hardware

**EARTHING CLAMP**

Part no.

E9.0141/0

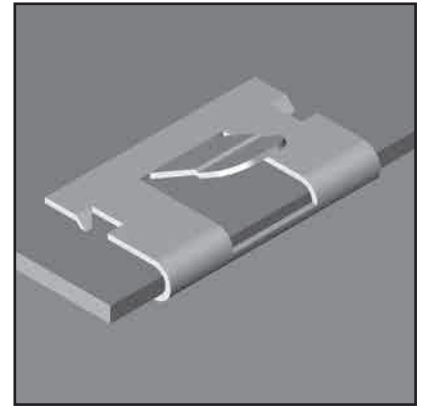
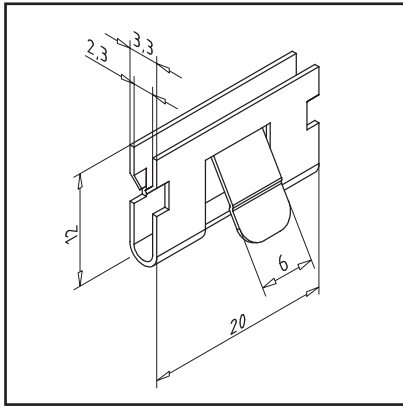
**TECHN. DATA / ITEMS SUPPLIED**

- Steel, Pressed, galvanized
- Weight = 0.002 kg/piece

**APPLICATIONS**

- For grounding sheet metal and thin-walled components with wall thickness of 0.7 - 2 mm
- Especially suitable for:
  - Cable duct AL **part no. 20.1051/0**
  - Cable duct 45 AL **part no. 20.1071/0**
  - Cable duct 90 AL **part no. 20.1056/0**

**ASSEMBLY**

- Attach to sheet metal edge
- Safe support and conductive connection is provided by claws
- For the connection of the earthing cable with 6 mm flat plug

## MOUNTING ANGLE 19 GD-Z CONDUCTIVE

Part no.

21.2078/6

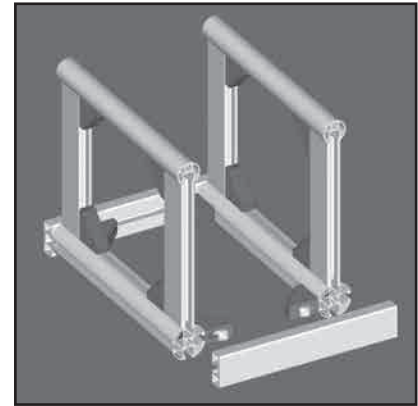
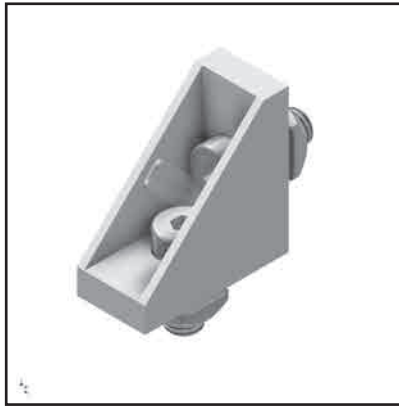
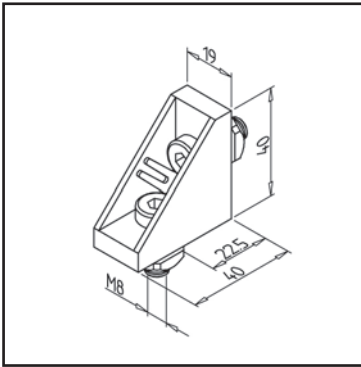

### TECHN. DATA / ITEMS SUPPLIED

- Aluminium, Pressure die-casting, blasted
- With fastening material steel, zinc plated
- Aluminium GD-Z
- Weight = 0.055 kg/piece

### APPLICATIONS

- Connection of profiles 19 and 32
- Subsequent insertion of profiles into existing constructions
- Attaching bearing surfaces
- Slidable in the groove direction

### ASSEMBLY

- Fasten to profile groove with supplied hardware
- For subsequent mounting on vertical nut, a square nut M8 Z with nut fixation, **part no. 21.1390/2** is preferred
- Recommended locking torque: 20 Nm

## MOUNTING ANGLE 25 GD-Z CONDUCTIVE

Part no.

21.0969/6

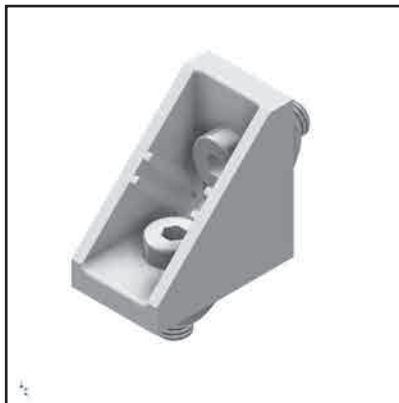
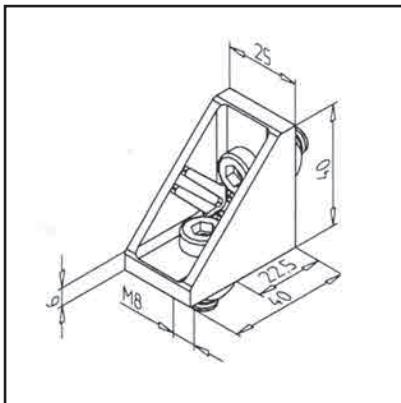

### TECHN. DATA / ITEMS SUPPLIED

- Aluminium, Pressure die-casting, blasted
- With fastening material steel, zinc plated
- Removable centering tabs
- Weight = 0.066 kg/piece

### APPLICATIONS

- General constructions, particularly for subsequent insertion of profiles into existing constructions
- Fastening of surface elements, table tops
- Strengthening of profile constructions

### ASSEMBLY

- Fasten to profile groove with supplied hardware
- For subsequent mounting on vertical nut, a square nut M8 Z with nut fixation, **part no. 21.1390/2** is preferred
- Recommended locking torque: 20 Nm



**MOUNTING ANGLE 45 GD-Z, CONDUCTIVE**

Part no.

21.1133/6

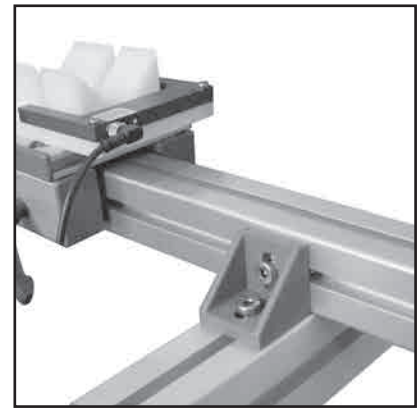
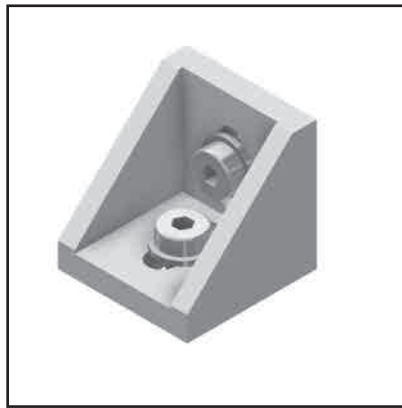
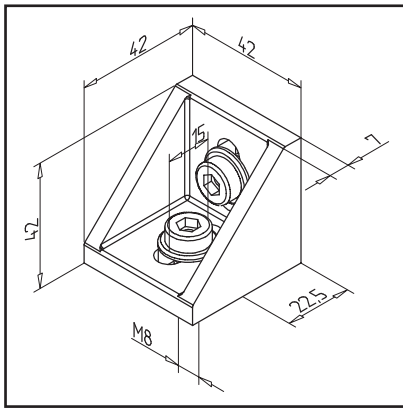
**TECHN. DATA / ITEMS SUPPLIED**

- Aluminium, Pressure die-casting, blasted
- With fastening material steel, zinc plated
- Mounting angle bracket with sliding nut Z with spring panel: **part no. 21.1133/8**
- Weight = 0.101 kg/piece

**APPLICATIONS**

- General constructions, particularly for subsequent insertion of profiles into existing constructions
- Fastening of surface elements, table tops
- Strengthening of profile constructions

**ASSEMBLY**

- Fasten to profile groove with supplied hardware
- For subsequent mounting on vertical nut, a square nut M8 Z with nut fixation, **part no. 21.1390/2** is preferred
- Hammer head screw **part no. 21.1370/0** can be used
- Recommended locking torque: 20 Nm

**MOUNTING ANGLE 45 X 90 GD-Z, CONDUCTIVE**

Part no.

21.1397/6

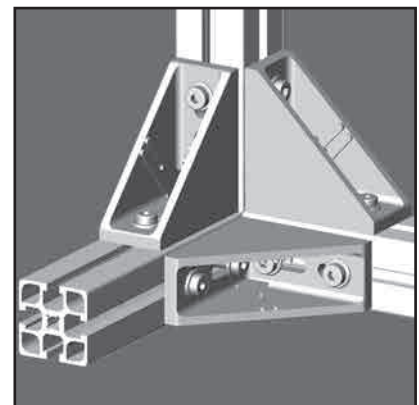
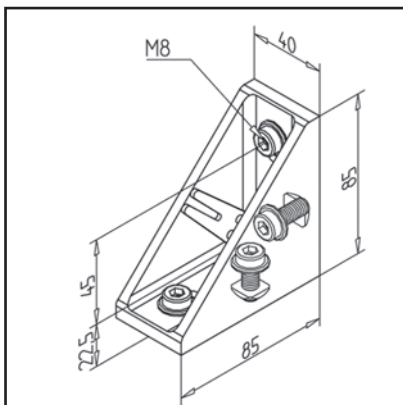
**TECHN. DATA / ITEMS SUPPLIED**

- Aluminium, Pressure die-casting, blasted
- With fastening material steel, zinc plated
- Angle with slide nut Z with spring steel sheet: **part no. 21.1397/8**
- Weight = 0.281 kg/piece

**APPLICATIONS**

- General constructions, particularly for subsequent insertion of profiles into existing constructions
- Fastening of surface elements, table tops
- Strengthening of profile constructions

**ASSEMBLY**

- Fasten to profile groove with supplied hardware
- For subsequent mounting on vertical nut, a square nut M8 Z with nut fixation, **part no. 21.1390/2** is preferred
- Recommended locking torque: 20 Nm

## MOUNTING ANGLE 30 GD-Z CONDUCTIVE

Part no.

21.0905/6

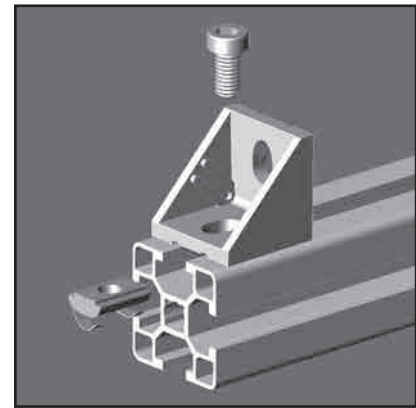
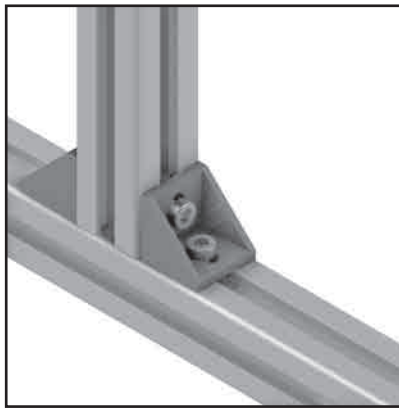
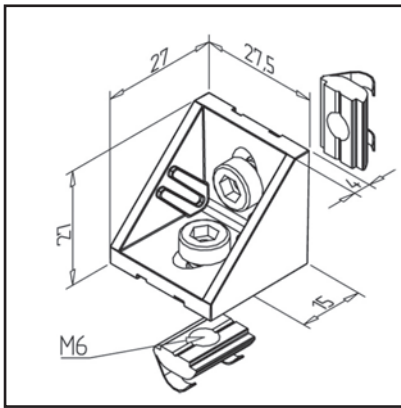

### TECHN. DATA / ITEMS SUPPLIED

- Aluminium, Pressure die-casting, blasted
- With fastening material steel, zinc plated
- Removable centering tabs
- Weight = 0.029 kg/piece

### APPLICATIONS

- Fastening of surface elements, table tops
- All types of constructions; specifically suited for the subsequent mounting of elements in existing constructions

### ASSEMBLY

- Strengthening of profile constructions
- Recommended locking torque: 20 Nm
- For subsequent mounting on vertical nut, a square nut M8 Z with nut fixation, **part no. 21.1390/2** is preferred
- Fasten to the profile with supplied hardware

## MOUNTING ANGLE 90 GD-Z CONDUCTIVE

Part no.

21.0978/6

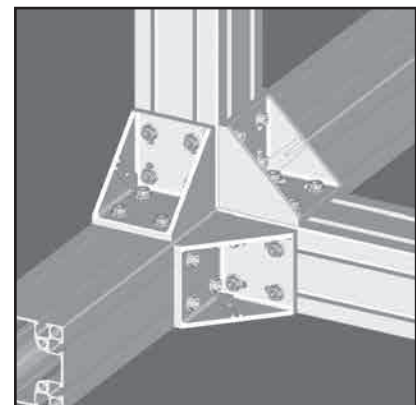
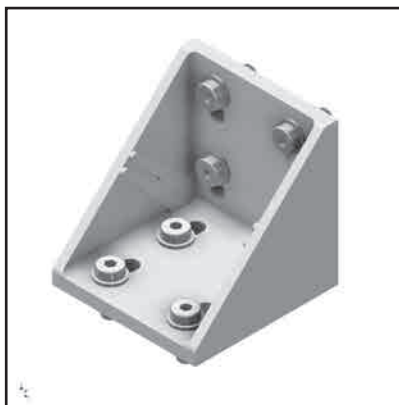
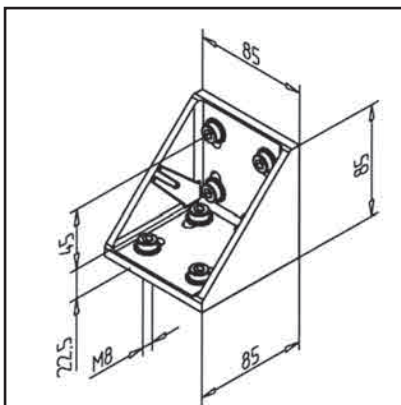

### TECHN. DATA / ITEMS SUPPLIED

- Aluminium, Pressure die-casting, blasted
- With fastening material steel, zinc plated
- Locking device against rotation
- Angle with slide nut Z with spring steel sheet: **part no. 21.0978/8**
- Weight = 0.497 kg/piece

### APPLICATIONS

- For profiles 90 and 180
- General constructions, particularly for subsequent insertion of profiles into existing constructions
- Fastening of surface elements, table tops
- Strengthening of profile constructions

### ASSEMBLY

- Fasten to profile groove with supplied hardware
- For subsequent mounting on vertical nut, a square nut M8 Z with nut fixation, **part no. 21.1390/2** is preferred
- Recommended locking torque: 20 Nm

**FOOT D45 CONDUCTIVE**

Part no.

32.1011/0

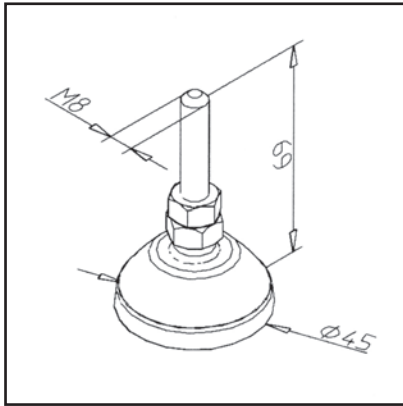
**TECHN. DATA / ITEMS SUPPLIED**

- Plate PA, black
- Anti-slip insert
- Spindle steel, galvanized M8
- Counter nut, steel, zinc plated
- All spindles fit all plates
- Conductive
- Hinged foot ESD D=45 m with spindle M10  
**part no. 32.1012/0**
- Weight = 0.062 kg/piece

**APPLICATIONS**

- Height adjustable heavy constructions of all types
- Guards, tables, show cases, Conveying systems, workstations
- Height adjustable constructions of all kinds
- Protective equipment, tables, showcases
- Conveyors, system workstations

**ASSEMBLY**

- Directly in the central bore of the profile (can be drilled with thread up to M12)
- Larger threads in connection with connection plate
- Direct in central drilling of the profiles
- For threads larger than M12, the hinged feet must be mounted in conjunction with the connection plate
- For profiles 45 x 90 und 90 x 90 a base and transport plate is required, if the feet are to be positioned centrally.

**FOOT D80 CONDUCTIVE**

Part no.

32.1021/0

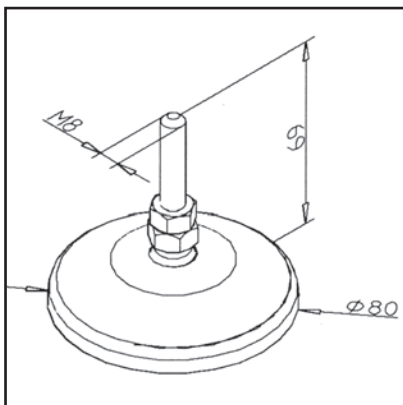
**TECHN. DATA / ITEMS SUPPLIED**

- Plate PA, black
- Anti-slip insert
- Spindle steel, galvanized M8
- Counter nut, steel, zinc plated
- All spindles fit all plates
- Conductive
- Hinged foot ESD D=80 m with spindle M10  
**part no. 32.1012/0**
- Weight = 0.108 kg/piece

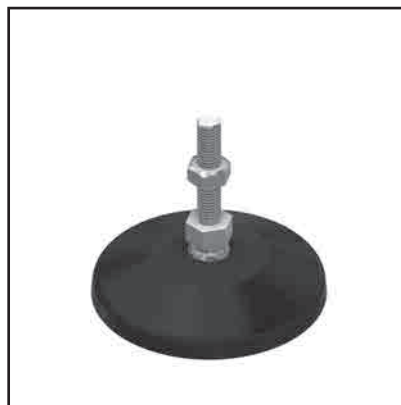
**APPLICATIONS**

- Height adjustable heavy constructions of all types
- Guards, tables, show cases, Conveying systems, workstations
- Height adjustable constructions of all kinds
- Protective equipment, tables, showcases
- Conveyors, system workstations

**ASSEMBLY**

- Directly in the central bore of the profile (can be drilled with thread up to M12)
- Larger threads in connection with connection plate
- Direct in central drilling of the profiles
- For threads larger than M12, the hinged feet must be mounted in conjunction with the connection plate
- For profiles 45 x 90 und 90 x 90 a base and transport plate is required, if the feet are to be positioned centrally.

## SWIVEL CASTER WITH WHEEL LOCK D75 X 100, CONDUCTIVE

Part no.

32.1030/0

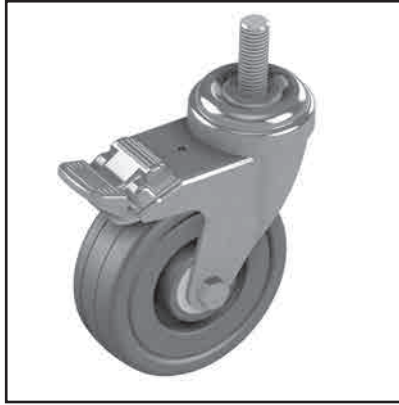
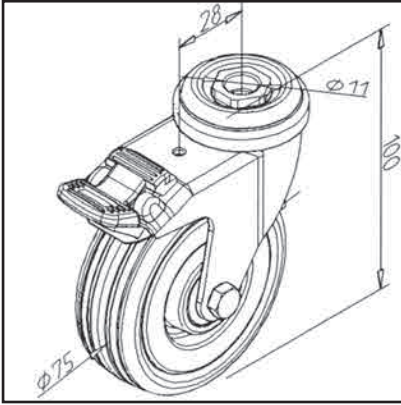

### TECHN. DATA / ITEMS SUPPLIED

- With fastening material steel, zinc plated
- Housing steel, galvanized
- Conductive
- Load capacity 50 kg
- **Other versions upon request**
- Weight = 0.322 kg/piece

### APPLICATIONS

- Movable tables
- Work stands
- display windows, showcases

### ASSEMBLY

- Attach directly to the central bore of the vertical profile with fastening material, then drill and introduce thread M10
- If the roller is to be centrally positioned for profile cross sections greater than 45 x 45, a connection plate is required

## SWIVEL CASTER WITHOUT WHEEL LOCK D75 X 100, CONDUCTIVE

Part no.

32.1031/0

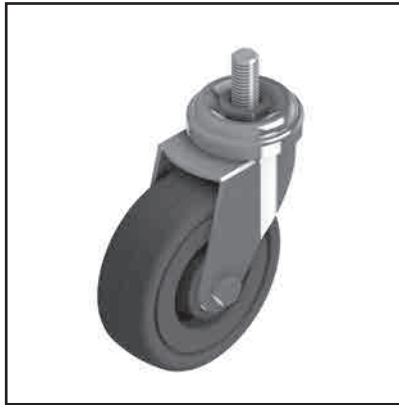
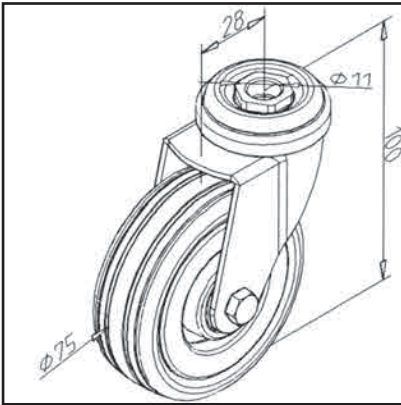

### TECHN. DATA / ITEMS SUPPLIED

- With fastening material steel, zinc plated
- Housing steel, galvanized
- Conductive
- Load capacity 50 kg
- **Other versions upon request**
- Weight = 0.292 kg/piece

### APPLICATIONS

- Movable tables
- Work stands
- display windows, showcases

### ASSEMBLY

- Attach directly to the central bore of the vertical profile with fastening material, then drill and introduce thread M10
- If the roller is to be centrally positioned for profile cross sections greater than 45 x 45, a connection plate is required

**SWIVEL CASTOR WITH BRAKE D100 X 135, ESD**

Part no.

32.1034/0

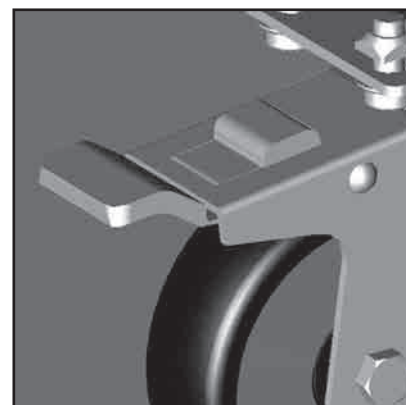
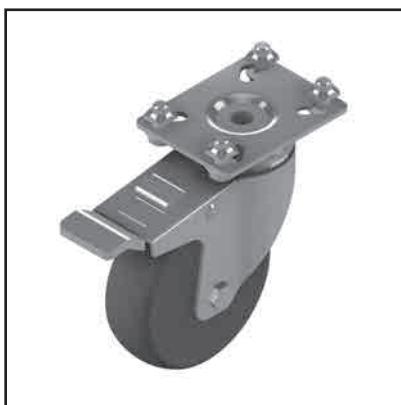
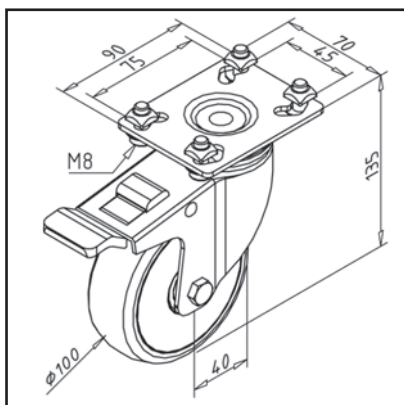
**TECHN. DATA / ITEMS SUPPLIED**

- With fastening material steel, zinc plated
- Housing steel, galvanized
- Conductive
- Load capacity 90 kg
- Weight = 0.881 kg/piece

**APPLICATIONS**

- Movable tables
- Work stands
- display windows, showcases

**ASSEMBLY**

- Fasten mounting plate in the profile groove with supplied hardware

**SWIVEL CASTOR WITHOUT BRAKE D100 X 135, ESD**

Part no.

32.1035/0

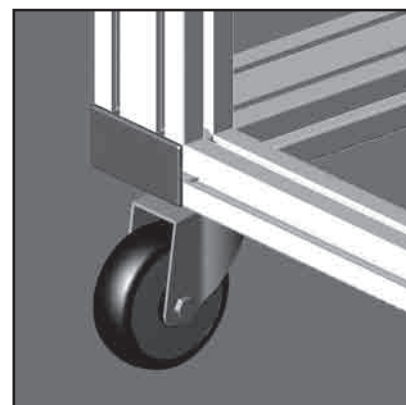
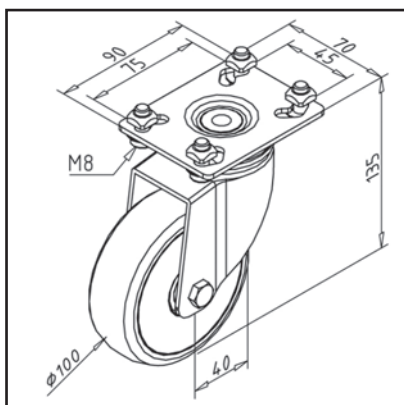
**TECHN. DATA / ITEMS SUPPLIED**

- With fastening material steel, zinc plated
- Housing steel, galvanized
- Conductive
- Load capacity 90 kg
- Weight = 0.765 kg/piece

**APPLICATIONS**

- Movable tables
- Work stands
- display windows, showcases

**ASSEMBLY**

- Fasten mounting plate in the profile groove with supplied hardware

## FIXED CASTOR D100 X 135, ESD

Part no.

32.1036/0

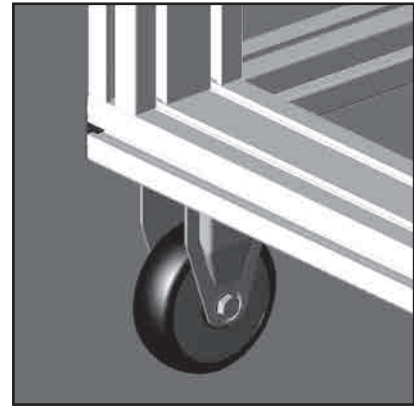
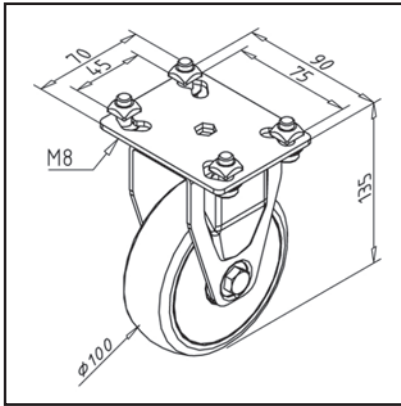

### TECHN. DATA / ITEMS SUPPLIED

- With fastening material steel, zinc plated
- Housing steel, galvanized
- Conductive
- Load capacity 90 kg
- Weight = 0.695 kg/piece

### APPLICATIONS

- Movable tables
- Work stands
- display windows, showcases

### ASSEMBLY

- Fasten mounting plate in the profile groove with supplied hardware

## CONNECTION PLATE 45X90 M10 CONDUCTIVE

Part no.

21.1038/6

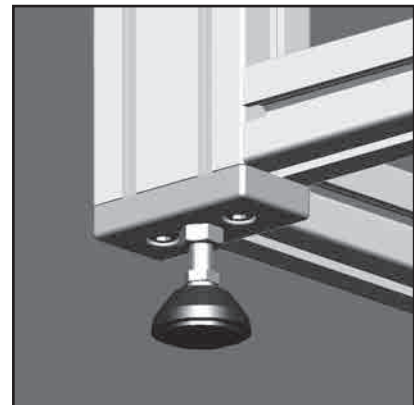
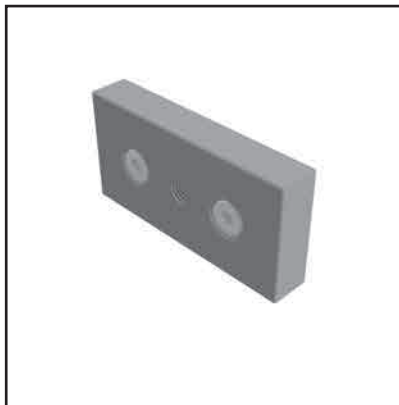
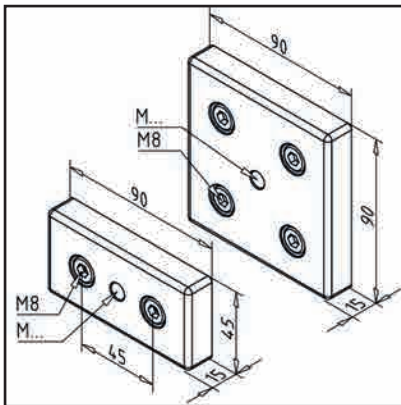

### TECHN. DATA / ITEMS SUPPLIED

- Aluminium, Pressure die-casting, blasted
- With fastening material steel, zinc plated
- Fastening kit
- Weight = 0.172 kg/piece

### APPLICATIONS

- Central fixation of support feet on profiles 45 x 90 or 90 x 90
- Fixation of guide rollers
- Centric attachment of hinged feet to profiles 45 x 90

### ASSEMBLY

- Fasten to the profile with supplied hardware
- Fasten to profile with fastening material from the scope of delivery