

CONNECTING PLATES

CONNECTING PLATE 30 x 60



Items Supplied

- Aluminium, powder coated, grey
- Fastening kit

Application

- Fixing of articulated feet and castors on profiles 30x60

Assembly

- Fasten with fastening material from the scope of supply to the profile

THREAD	STRENGTH	WEIGHT	Part no.
M8	15 mm	0,085 kg	21.2114/0
M10	15 mm	0,084 kg	21.2115/0
M12	15 mm	0,082 kg	21.2116/0

CONNECTING PLATE 32 x 90



Items Supplied

- Aluminium, powder coated, grey
- Fastening kit

Application

- Fixing of articulated feet to profiles 90x32 UL

Assembly

- Fasten with fastening material from the scope of supply to the profile

Thread	Thickness	Weight	Part no.
M8	15 mm	0,164 kg	21.1356/0
M10	15 mm	0,162 kg	21.1357/0
M12	15 mm	0,160 kg	21.1358/0

CONNECTING PLATE 45 x 90



Items Supplied

- Aluminium, powder coated, grey
- Fastening kit

Application

Fixing of articulated feet and castors on profiles 45x90

Assembly

Fasten with fastening material from the scope of supply to the profile

Thread	Thickness	Weight	Part no.
M10	15 mm	0,164 kg	21.1038/0
M12	15 mm	0,162 kg	21.1039/0
M16	15 mm	0,160 kg	21.1040/0
M20	15 mm	0,156 kg	21.1047/0

CONNECTING PLATES

CONNECTING PLATE 90 x 90

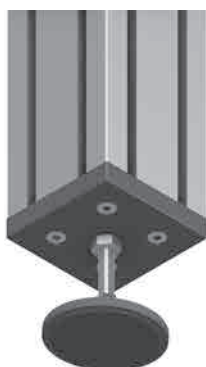

Items Supplied

- Aluminium, powder coated, grey
- Fastening kit

Application

- Fixing of articulated feet and castors on profiles 90x90

Assembly

- Fasten with fastening material from the scope of supply to the profile

Thread	Thickness	Weight	Part no.
M10	15 mm	0,332 kg	21.1041/0
M12	15 mm	0,330 kg	21.1042/0
M16	15 mm	0,345 kg	21.1043/0
M20	15 mm	0,290 kg	21.1057/0

CONNECTING PLATE 90 R 90°



Items Supplied

- Aluminium, powder coated, grey
- Fastening kit

Application

- Fixing of articulated feet and castors on profiles 90R90°

Assembly

- Fasten with fastening material from the scope of supply to the profile

Thread	Thickness	Weight	Part no.
M10	15 mm	0,277 kg	21.0009/0
M12	15 mm	0,275 kg	21.0010/0
M16	15 mm	0,272 kg	21.0011/0
M20	15 mm	0,268 kg	21.0012/0

HINGED FEET

HINGED FEET PA

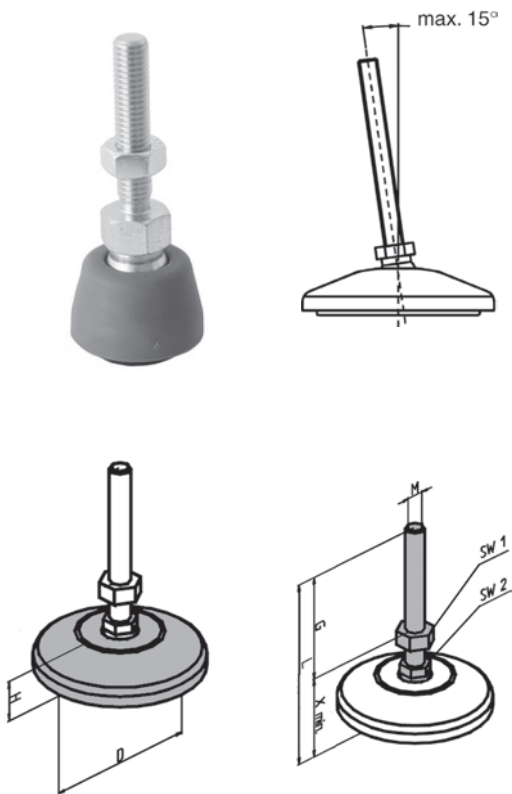

Items Supplied

- Plate PA, grey
- Anti slip insert NBR
- Spindle steel, galvanized
- Lock nut steel, galvanized
- All spindles fit all plates

Application

Height adjustable constructions of all kinds
 Protective equipment, tables, showcases
 Conveyors, system workstations

Assembly

- Direct in central drilling of the profiles (depending on profile cross-section drilled up to thread M12)
- Larger threads in connection with connection plate
- For profiles 45 x 90 and 90 x 90, a connection plate is required if the feet should be positioned centrally

Spindle	Plate			
	Ø 30	Ø 45	Ø 60	Ø 80
M8	21.1851/0	21.1871/0	21.1881/0	21.1891/0
M10	21.1852/0	21.1872/0	21.1882/0	21.1892/0
M12	-	21.1873/0	21.1883/0	21.1893/0
M16	-	21.1874/0	21.1884/0	21.1894/0

Plate		
D mm	H mm	Load capacity
30	20	300 kg
45	20	500 kg
60	20	1000 kg
80	20	1000 kg

Spindle					
M	G	X	SW1	SW2	L
8	33,5	38,5	13	14	72,5
10	42	40,5	17	14	82,5
12	90	42,5	19	14	132,5
16	107	45,5	24	17	152,5

HINGED FEET PA WITH MOUNTING HOLE

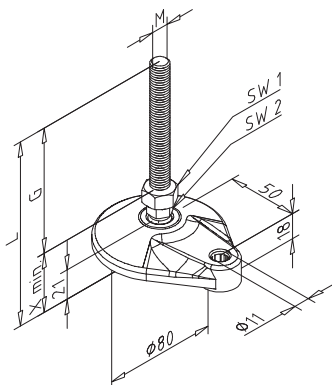

Items Supplied

- Plate PA, grey
- Spindle Steel, galvanized
- Lock nut steel, galvanized
- Anti slip insert NBR
- Load capacity: 1000 Kg

Part no.	Color	M	G	X	SW1	SW2	L
21.2510/0	grey	08	33,5	39	13	14	72,5
21.2511/0	grey	10	42	40,5	17	14	82,5
21.2512/0	grey	12	90	42,5	19	14	132,5
21.2513/0	grey	16	107	45,5	24	17	152,5

HINGED FEET

HINGED FEET GD

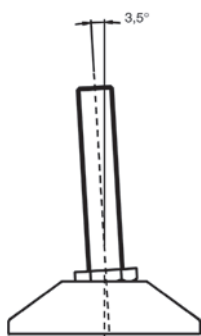

Items Supplied

- Plate die-cast aluminium powder-coated, grey
- Anti slip insert NBR
- Spindle Steel, galvanized
- Lock nut steel, galvanized
- All spindles fit all plates

Spindle	Plate	
	Ø 45	Ø 90
M10	21.1842/0	21.1862/0
M12	21.1843/0	21.1863/0
M16	21.1844/0	21.1864/0

Plate		
D mm	H mm	Load capacity
45	25	3000 kg
90	27	4000 kg

Spindle					
M	G	X	SW1	SW2	L
10	52,6	37,5	17	17	89,5
12	50,5	41	19	19	91,2
16	68	45,6	24	24	112,6

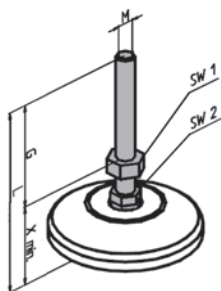
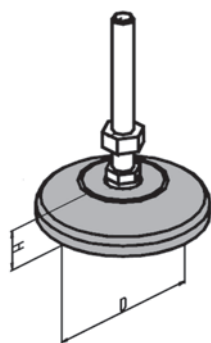

FOOT SST

Part no. 21.2053/0

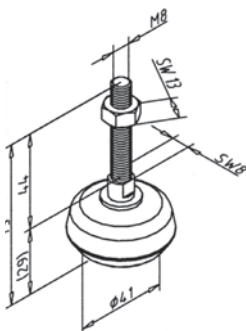

Items Supplied

- Plate Steel, VA
- Spindle insert steel VA
- Lock nut steel, VA
- Load capacity: 750 kg

Application

- Height adjustable constructions of all kinds
- Protective equipment, tables, showcases
- Conveyors, system workstations

Assembly

- Directly in central bore of the profiles, also in VA profile
Cut thread M8,
Mold in aluminum profile thread M8

CLIP - BLOCK FOR BALL HEAD

Part no.

22.1181/0

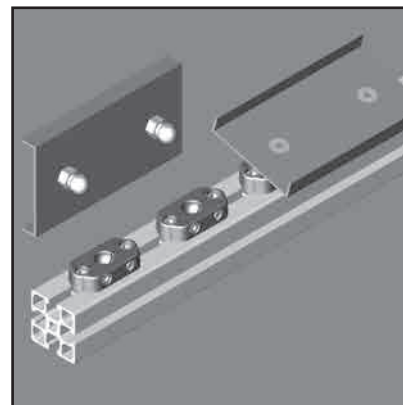
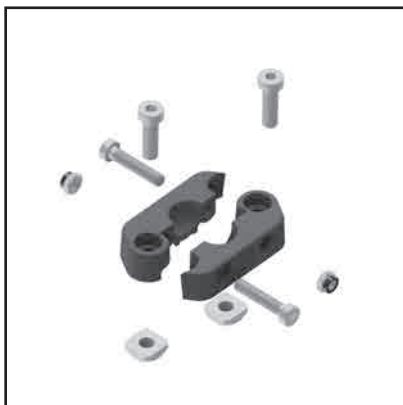
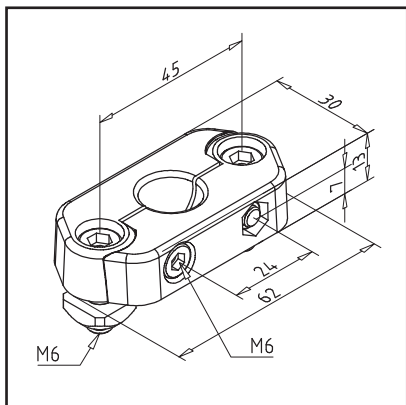

TECHN. DATA / ITEMS SUPPLIED

- PA, Injection Mould, grey
- Ball Ø15 mm
- With fastening material steel, zinc plated
- Swivel area 15°
- Load capacity up to 150 kg standing vertically
- Weight = 0.054 kg/piece

APPLICATIONS

- For the preparation of self-adjusting lines and stoppers
- Exchangeable workpiece or worktool carriers
- To be used with ball head M8 **part no. 21.2506/0** or the ball screws made of hinged feet PA

ASSEMBLY

- Fasten with fixing material to profile groove
- Holding force adjustable 0 - 50 N

BALL HEAD M8

Part no.

21.2506/0

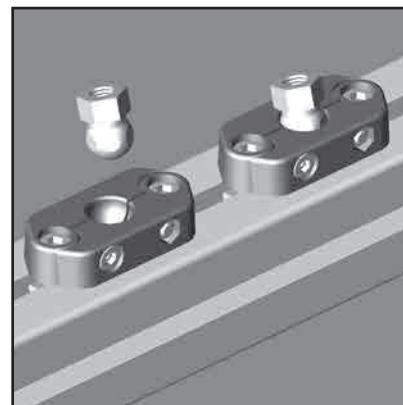
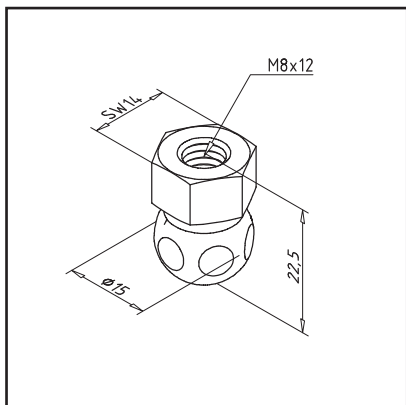

TECHN. DATA / ITEMS SUPPLIED

- Steel, galvanized
- Ball Ø15 mm
- Internal thread M8x12
- Weight = 0.020 kg/piece

APPLICATIONS

- For use in combination with Clip Block **part no. 22.1181/0**
- For the preparation of linings or hinged feet in special design, see hinged feet PA

ASSEMBLY

- Fasten onto preferred component with screw M8
- Use for fastening to profile groove setscrew M8x20 and square nut M8

FOOT 30 COMPACT

Part no.

21.2524/0

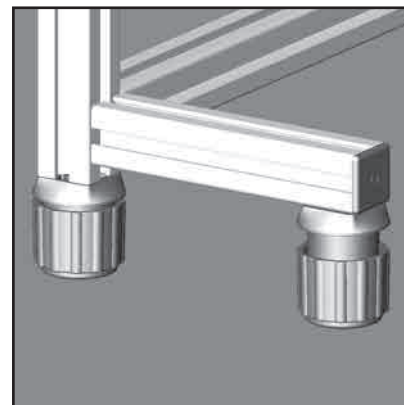
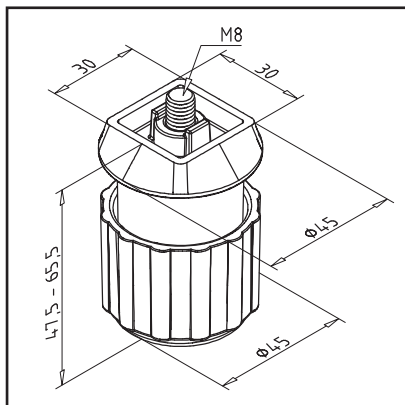

TECHN. DATA / ITEMS SUPPLIED

- PA, Injection Mould, grey
- With fastening material steel, zinc plated
- Max. load capacity: 100 Kg
- Adjustment area ± 9 mm
- With anti-skid rubber damper
- Weight = 0.121 kg/piece

APPLICATIONS

- For installation and levelling of smaller frames with nice design

ASSEMBLY

- Assembly with to profile end or on profile face with delivered fixation material

FOOT 45 COMPACT

Part no.

21.2525/0

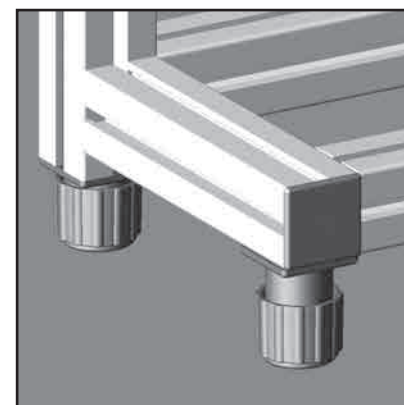
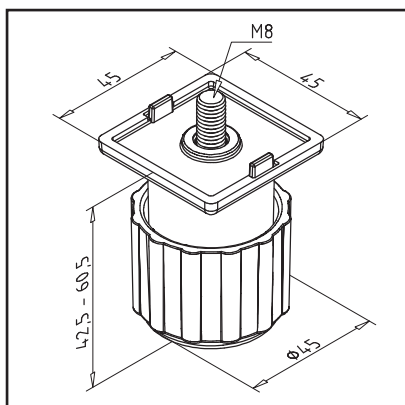

TECHN. DATA / ITEMS SUPPLIED

- PA, Injection Mould, grey
- With fastening material steel, zinc plated
- Max. load capacity: 100 Kg
- Adjustment area ± 9 mm
- With anti-skid rubber damper
- Weight = 0.117 kg/piece

APPLICATIONS

- For installation and levelling of smaller frames with nice design

ASSEMBLY

- Assembly with to profile end or on profile face with delivered fixation material

FLOOR MOUNTING PLATE 45X45 G

Part no.

22.1217/0

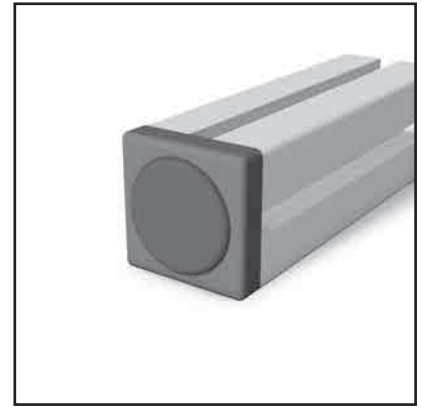
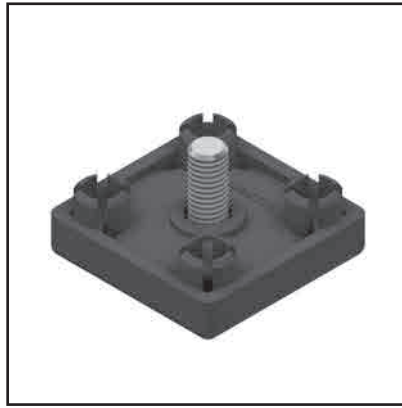
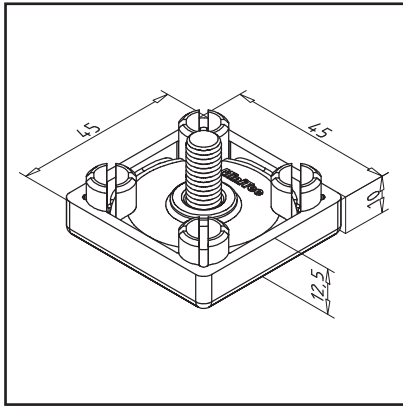

TECHN. DATA / ITEMS SUPPLIED

- ABS, Injection Mould, grey
- Anti-slip license NBR, black
- With fastening screw M8, galvanized
- Load capacity: 1000 kg
- Weight = 0.032 kg/piece

APPLICATIONS

- For use with all profiles with cross section 45x45
- For non-slip installation of tables and racks
- Reduces noise and protects the floor

ASSEMBLY

- Fasten to central profile bore with fixation material from delivery scope
- then insert anti-slip certificate

FURNITURE WHEEL WITH LOCKING DEVICE

Part no.

21.1153/0

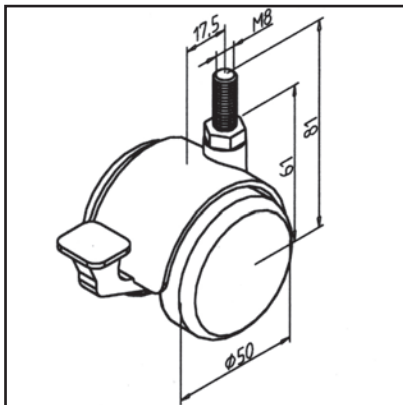

TECHN. DATA / ITEMS SUPPLIED

- PA, black
- Double role with sliding bearing
- With fastening material steel, zinc plated
- Load capacity 30 kg
- Weight = 0.080 kg/piece

APPLICATIONS

- Light movable tables
- Movable file box
- Furniture

ASSEMBLY

- Install directly in the center hole of the vertical profile with mounting material
- If the wheel must be positioned centrally for profile cross-sections 45 x 90 or greater, a base and transport plate with thread M8 is required

FURNITURE WHEEL WITHOUT LOCKING DEVICE

Part no.

21.1105/0

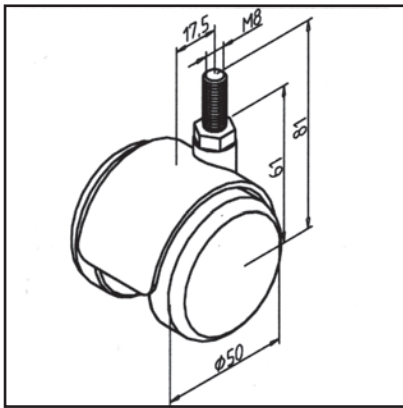

TECHN. DATA / ITEMS SUPPLIED

- PA, black
- Double role with sliding bearing
- With fastening material steel, zinc plated
- Load capacity 30 kg
- Weight = 0.076 kg/piece

APPLICATIONS

- Light movable tables
- Movable file box
- Furniture

ASSEMBLY

- Install directly in the center hole of the vertical profile with mounting material
- If the wheel must be positioned centrally for profile cross-sections 45 x 90 or greater, a base and transport plate with thread M8 is required

SWIVELLING CASTOR WITH BRAKE D 75 X 100

Part no.

21.1120/0

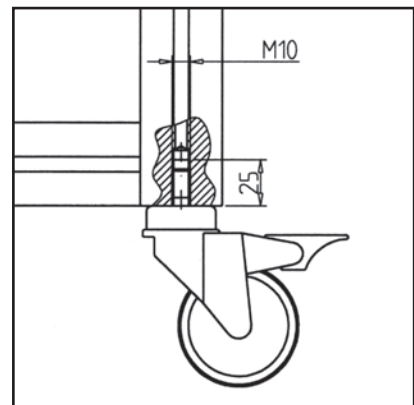
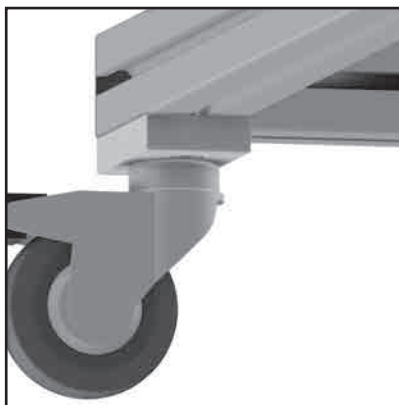
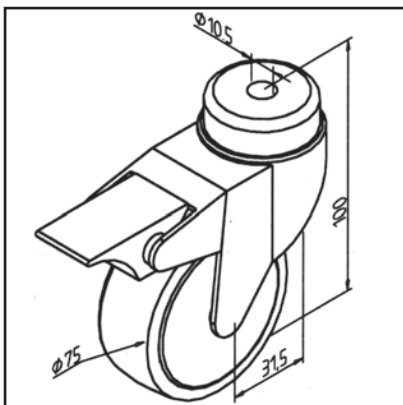

TECHN. DATA / ITEMS SUPPLIED

- Steel, galvanized
- Tire, rubber, grey
- With fastening material steel, zinc plated
- Load capacity 50 kg
- **Other versions upon request**
- Weight = 0.450 kg/piece

APPLICATIONS

- Movable tables
- Work stands
- display windows, showcases

ASSEMBLY

- Attach directly to the central bore of the vertical profile with fastening material, then drill and introduce thread M10
- A connection plate is required if the roller is to be positioned centrally with profile cross sections 45 x 90 or 90 x 90

SWIVELLING CASTOR WITHOUT BRAKE D 75 X 100

Part no.

21.1118/0

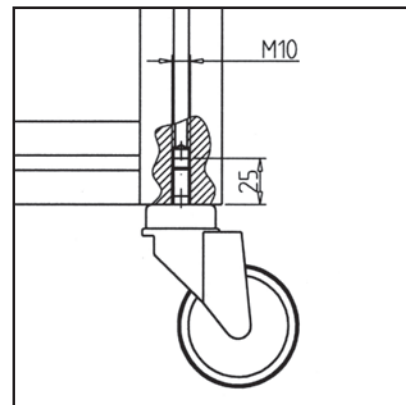
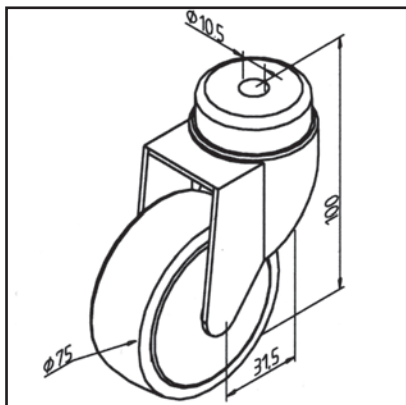

TECHN. DATA / ITEMS SUPPLIED

- Steel, galvanized
- Tire, rubber, grey
- With fastening material steel, zinc plated
- Load capacity 50 kg
- **Other versions upon request**
- Weight = 0.372 kg/piece

APPLICATIONS

- Movable tables
- Work stands
- display windows, showcases

ASSEMBLY

- Attach directly to the central bore of the vertical profile with fastening material, then drill and introduce thread M10
- A connection plate is required if the roller is to be positioned centrally with profile cross sections 45 x 90 or 90 x 90

FIXED CASTOR D 75 X 103

Part no.

21.1475/0

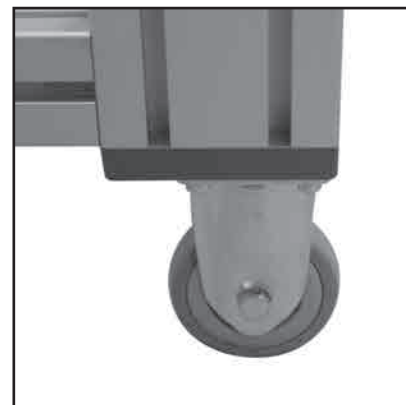
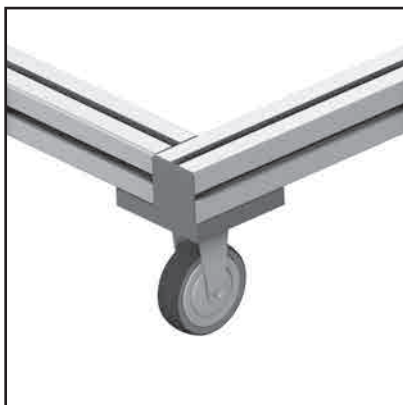
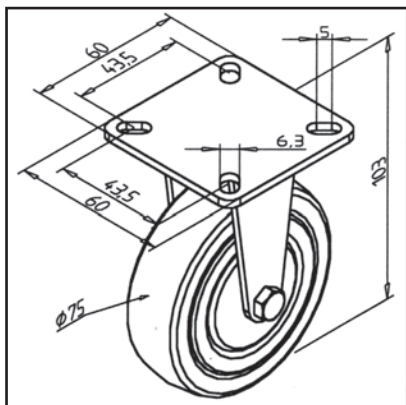

TECHN. DATA / ITEMS SUPPLIED

- Steel, galvanized
- Tire, rubber, grey
- With fastening material steel, zinc plated
- Load capacity 50 kg
- **Other versions upon request**
- Weight = 0.350 kg/piece

APPLICATIONS

- Work stands
- Frames
- Movable tables

ASSEMBLY

- to the profile groove with supplied hardware
- With mounting plate for castor **Part no. 21.1476/0** attach to profile

CONNECTING PLATE 45 X 45 VA M10

Part no. 21.2059/0

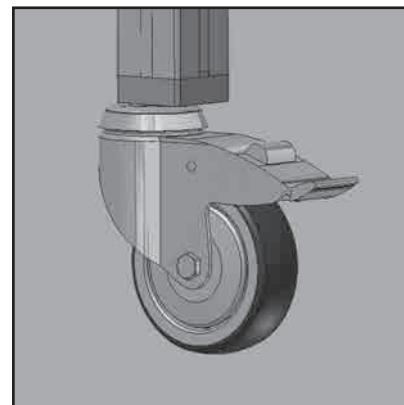
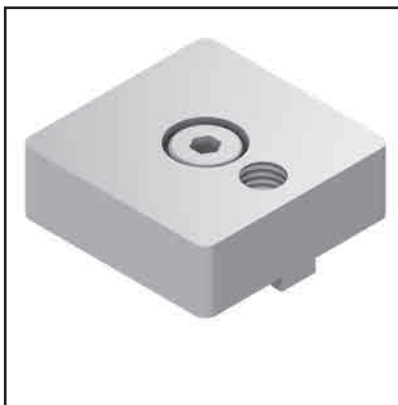
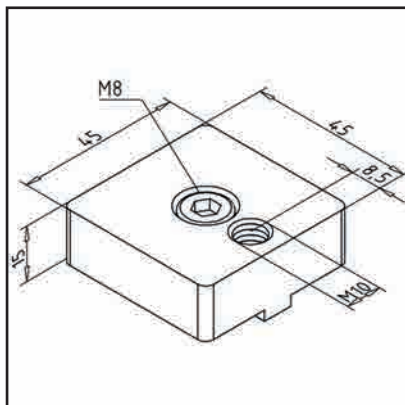

TECHN. DATA / ITEMS SUPPLIED

- Stainless steel
- Fastening kit
- Weight = 0.230 kg/piece

APPLICATIONS

- PROFILE 45 x 45
- Profile 45 x 45 VA
- Height compensation when mounting casters in combination with fixed casters on a movable base frame
- For using feet M10

ASSEMBLY

- Front attachment to profile with supplied hardware
- Fasten to profile with fastening material from the scope of delivery

FASTENING PLATE 45 SST TO FIXED CASTOR

Part no. 21.2058/0

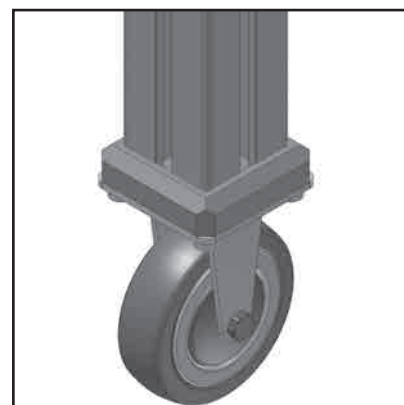
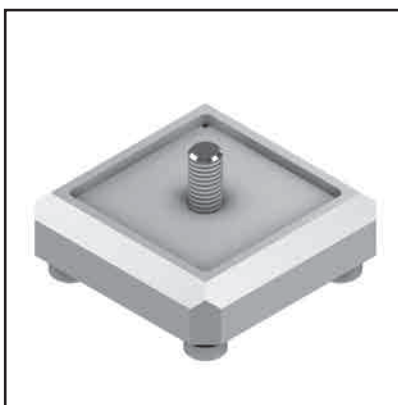
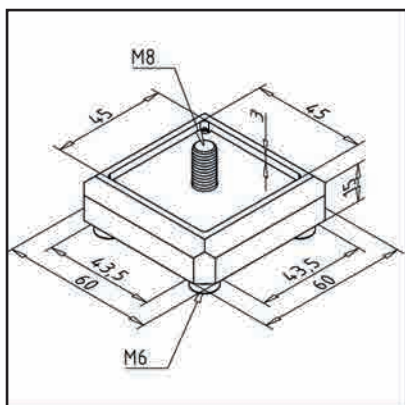

TECHN. DATA / ITEMS SUPPLIED

- Stainless steel
- Fastening kit
- Weight = 0.360 kg/piece

APPLICATIONS

- PROFILE 45 x 45
- Profile 45 x 45 VA
- For attaching the fixed caster on the front side to profile 45 x 45 and 45 x 45 VA

ASSEMBLY

- Front attachment to profile with supplied hardware

FASTENING PLATE 90 TO FIXED CASTOR

Part no. 21.1476/0

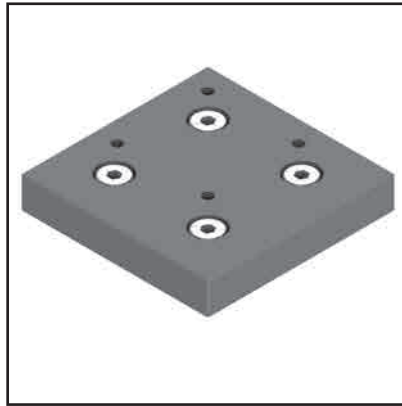
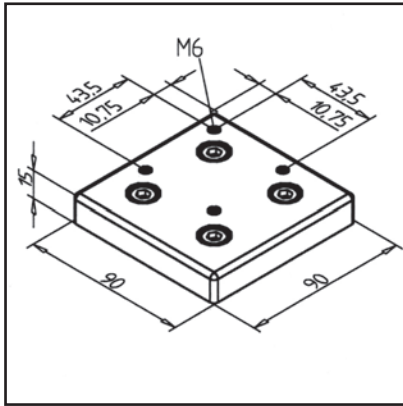

TECHN. DATA / ITEMS SUPPLIED

- Aluminium, Pressure die-casting, powder-coated, grey
- With fastening material steel, zinc plated
- Weight = 0.330 kg/piece

APPLICATIONS

- To attach the castor **part no. 21.1475/0** frontally to profile 90 x 90

ASSEMBLY

- Fasten to the profile end with supplied hardware

SWIVELLING CASTOR WITH BRAKE D 100 X 131

Part no. 21.0031/0

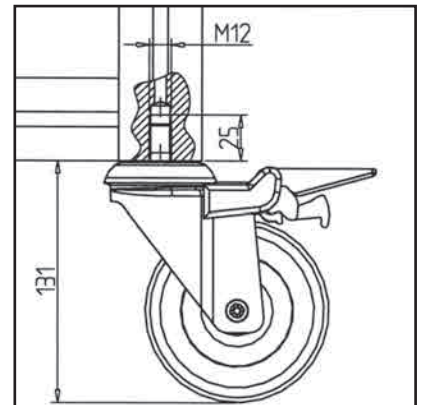
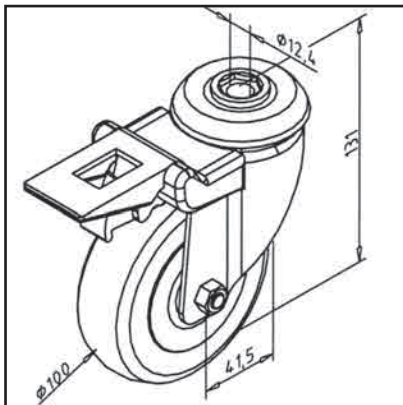

TECHN. DATA / ITEMS SUPPLIED

- Steel, galvanized
- Tire, rubber, grey
- With fastening material steel, zinc plated
- Load capacity 100 kg
- **Other versions upon request**
- Weight = 0.743 kg/piece

APPLICATIONS

- Movable tables
- Work stands
- display windows, showcases

ASSEMBLY

- Connect directly to the central bore of the vertical profile with supplied hardware, drill and introduce thread M12
- If the roller is to be centrally positioned for profile cross sections of 45 x 90 or 90 x 90, a connection plate is required

SWIVELLING CASTOR WITHOUT BRAKE D 100 X 131

Part no.

21.0030/0

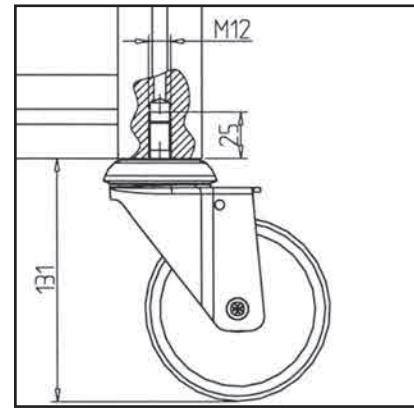
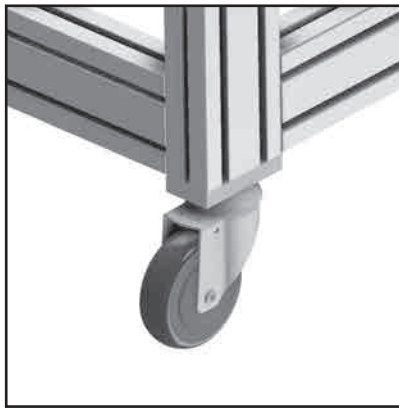
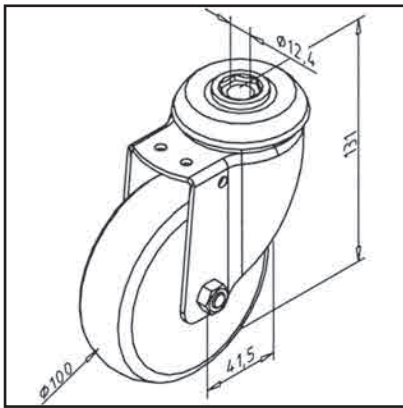

TECHN. DATA / ITEMS SUPPLIED

- Steel, galvanized
- Tire, rubber, grey
- With fastening material steel, zinc plated
- Load capacity 100 kg
- **Other versions upon request**
- Weight = 0.660 kg/piece

APPLICATIONS

- Movable tables
- Work stands
- display windows, showcases

ASSEMBLY

- Connect directly to the central bore of the vertical profile with supplied hardware, drill and introduce thread M12
- A connection plate is required if the roller is to be positioned centrally with profile cross sections 45 x 90 or 90 x 90

FLOOR MOUNTING PLATE 45

Part no.

21.1730/0

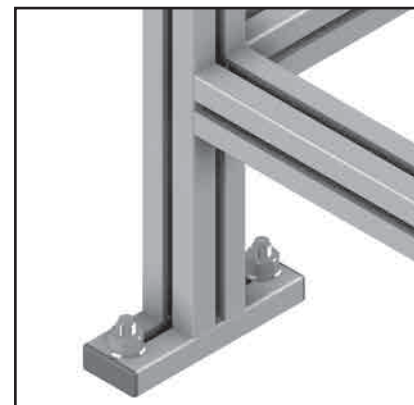
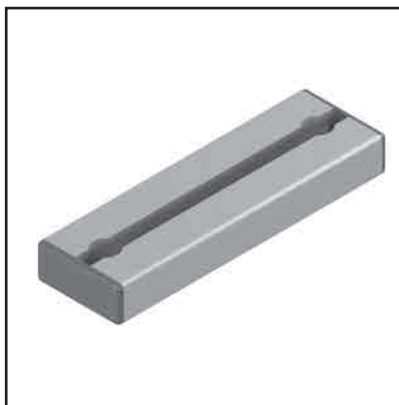
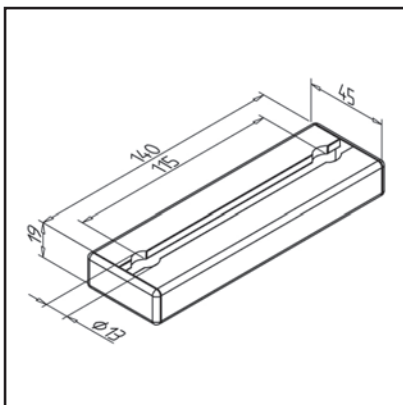

TECHN. DATA / ITEMS SUPPLIED

- Aluminium, anodized E6/EV1
- PROFILE 45 x 19
- With caps, grey
- Without fastening kit
- Weight = 0.130 kg/piece

APPLICATIONS

- Floor fixing of columns from profile 45 x 45

ASSEMBLY

- Secure profile with MiniTec profile connector
- On floor side: 2 floor anchors **part no. 21.1082/0**

FLOOR MOUNTING PLATE 90

Part no. 21.1733/0

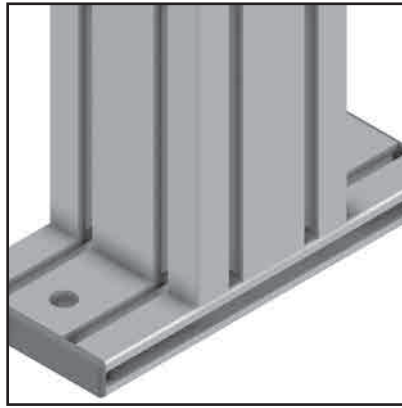
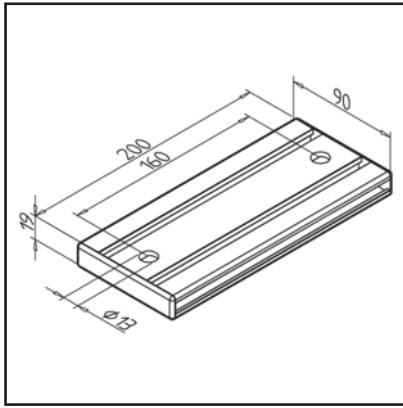

TECHN. DATA / ITEMS SUPPLIED

- Aluminium, anodized E6/EV1
- PROFILE 19 X 90
- With caps, grey
- Without fastening kit
- Weight = 0.470 kg/piece

APPLICATIONS

- Floor fixing of columns from profile 45 x 90 oder 90 x 90

ASSEMBLY

- On profile side: 2 or 4 MiniTec power-lock fasteners
- On floor side: 2 floor anchors **part no. 21.1082/0**

FLOOR ANCHOR 10

Part no. 21.1082/0

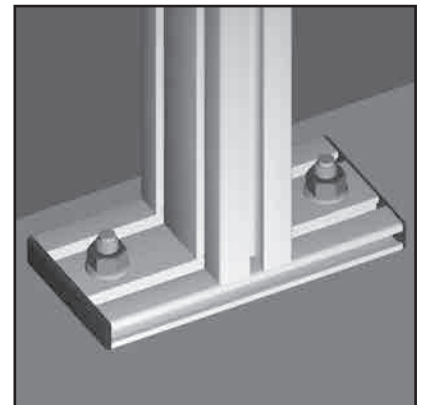
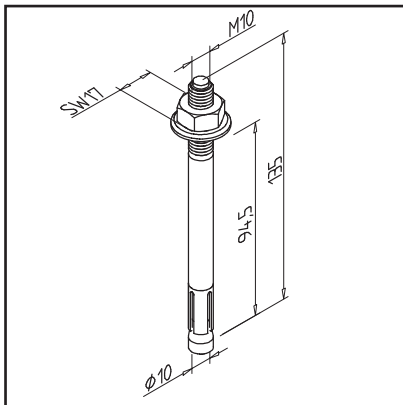

TECHN. DATA / ITEMS SUPPLIED

- Steel, galvanized
- Ø 10
- With hexagonal nut and washer
- Weight = 0.084 kg/piece

APPLICATIONS

- Secure and fasten constructions in connection with the floor mounting bracket, levelling plate or stationary plate

ASSEMBLY

- Fit bore in the bottom
- Use floor anchor in connection with angle, levelling plate or floor mounting plate

FLOOR ANCHOR 12

Part no.

21.1115/0

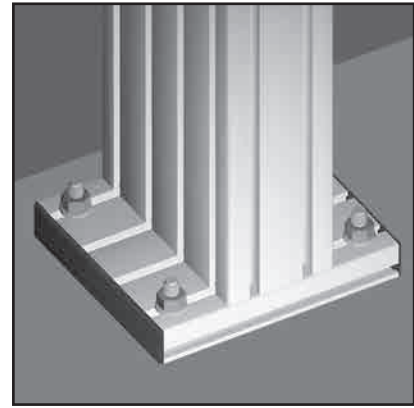
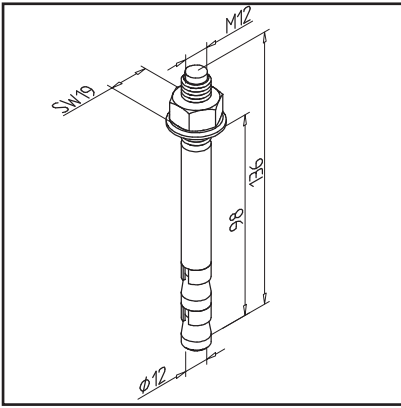

TECHN. DATA / ITEMS SUPPLIED

- Steel, galvanized
- Ø 12
- With hexagonal nut and washer
- Weight = 0.116 kg/piece

APPLICATIONS

- Secure and fasten constructions in connection with the floor mounting bracket, leveling plate or stationary plate

ASSEMBLY

- Fit bore in the bottom
- Use floor anchor in connection with angle, levelling plate or floor mounting plate

LEVELING PLATE 90 ST

Part no.

21.0976/0

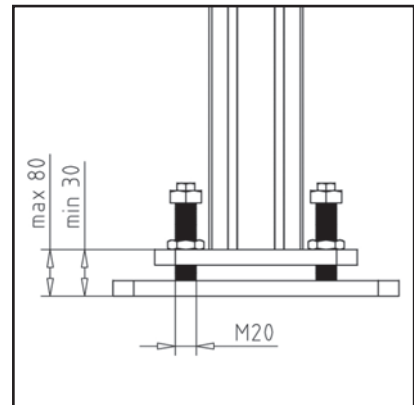
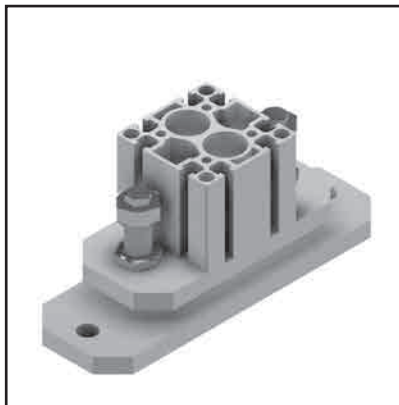
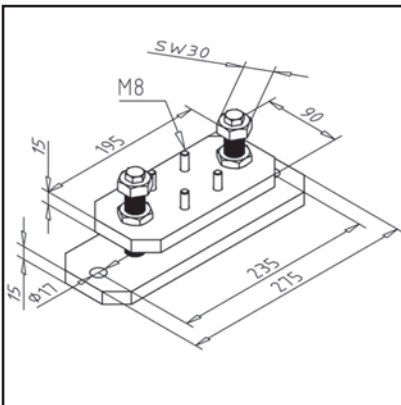

TECHN. DATA / ITEMS SUPPLIED

- Steel, galvanized
- With galvanized steel fastening material, for profile
- With leveling element
- Without dowels
- Weight = 5.146 kg/piece

APPLICATIONS

- Precise alignment of heavy constructions with cross-section 90x90 as post profile

ASSEMBLY

- Fasten footplate to the floor using a high performance anchor
- Fasten profile plate to the profile with supplied hardware
- Turn the M20 screw to set the height and secure it with the counter nut

LEVELING PLATE 180 ST

Part no.

21.0977/0

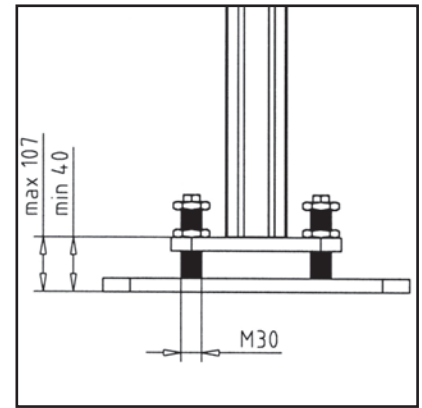
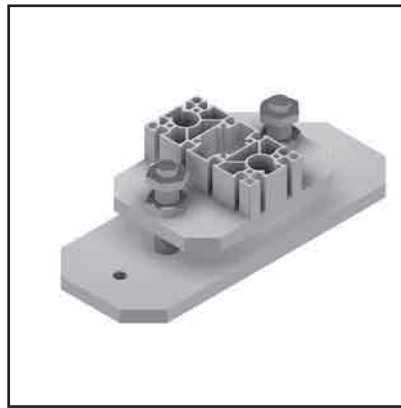
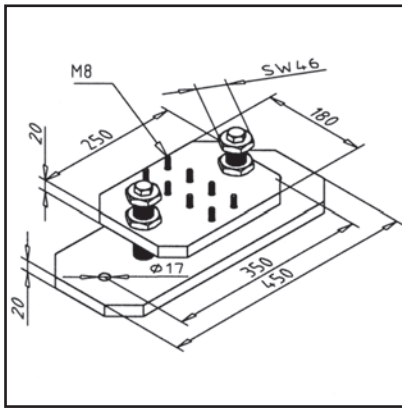

TECHN. DATA / ITEMS SUPPLIED

- Steel, galvanized
- With galvanized steel fastening material, for profile
- With leveling element
- Without dowels
- Weight = 20.347 kg/piece

APPLICATIONS

- Precise alignment of heavy constructions with cross-section 90x180 as post profile

ASSEMBLY

- Fasten footplate to the floor using a high performance anchor
- Fasten profile plate to the profile with supplied hardware
- Adjust height by turning screw M30 and secure with counter nut.

FLOOR MOUNTING ANGLE

Part no.

21.1112/0

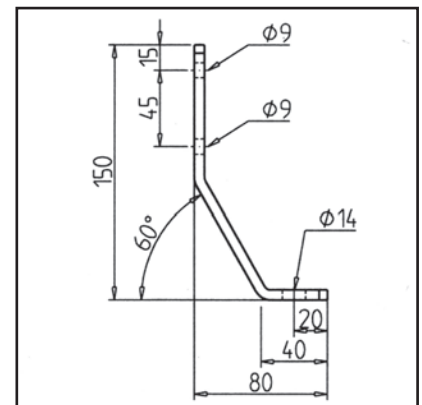
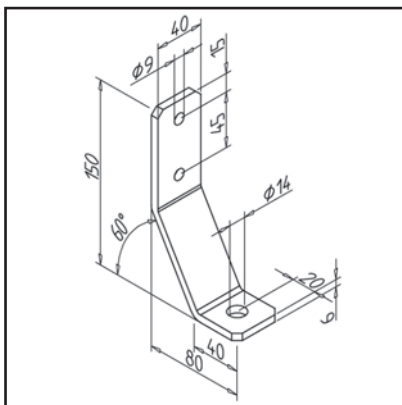

TECHN. DATA / ITEMS SUPPLIED

- Steel, powder-coated, grey
- With fastening material steel, zinc plated
- Without dowels
- Weight = 0.389 kg/piece

APPLICATIONS

- Securing and fastening of constructions on floor or wall

ASSEMBLY

- On profile side with cylinder screws M8 x 20, SW5
- Bottom side with high performance anchor 12 **part no. 21.1115/0**
- Also suitable for subsequent mounting

FLOOR MOUNTING ANGLE

Part no. 21.0015/0

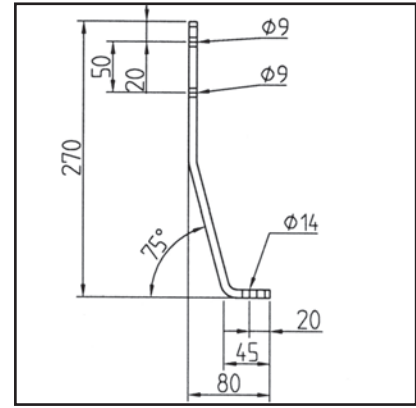
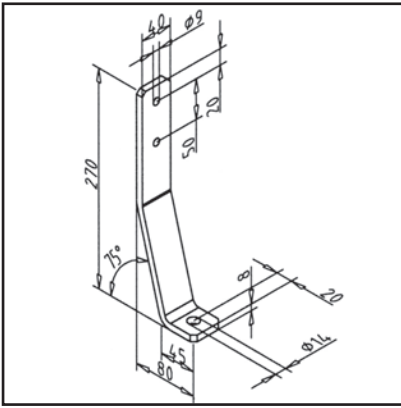

TECHN. DATA / ITEMS SUPPLIED

- Steel, powder-coated, grey
- With fastening material steel, zinc plated
- Without dowels
- Weight = 0.786 kg/piece

APPLICATIONS

- For securing heavy constructions under dynamic load on floor or wall

ASSEMBLY

- On the profile side with cylinder screw M8 x 20, SW 5
- Bottom side with high performance anchor 12 **part no. 21.1115/0**
- Also suitable for subsequent mounting

STRUT SOCKET 45 GD

Part no. 21.1729/0

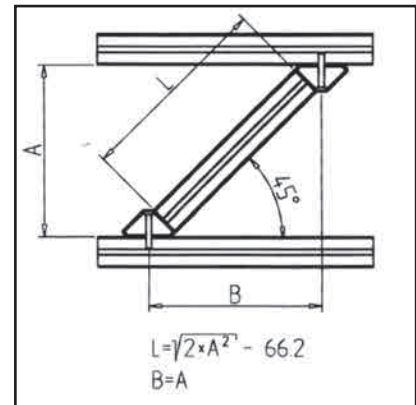
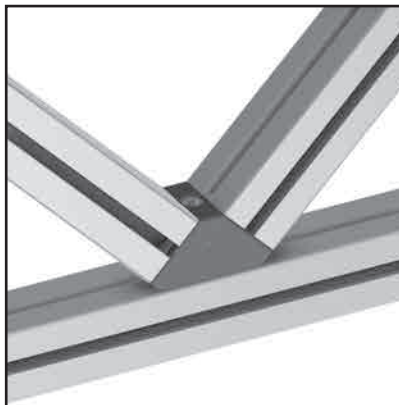
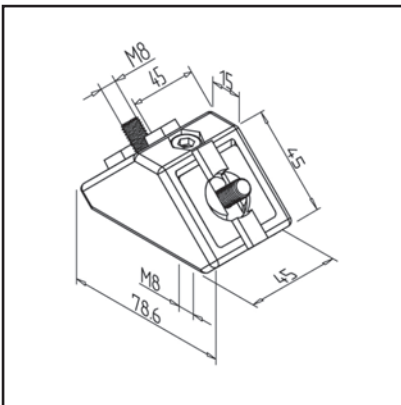

TECHN. DATA / ITEMS SUPPLIED

- Aluminium, Pressure die-casting, powder-coated, grey
- With fastening material steel, zinc plated
- Use on vertical struts **part no. 21.1729/7** (square nut with position-fixing)
- Weight = 0.261 kg/piece

APPLICATIONS

- Bracing in the composite structure

ASSEMBLY

- Pre-assemble brace base and place in frame
- Screw the brace socket onto the frame

STRUT SOCKET 45°/90

Part no.

21.1727/0

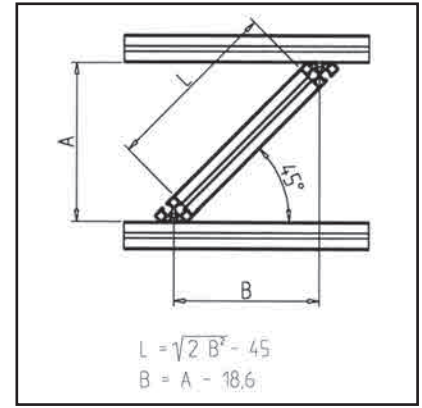
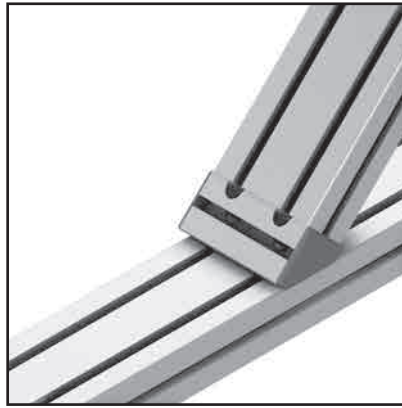
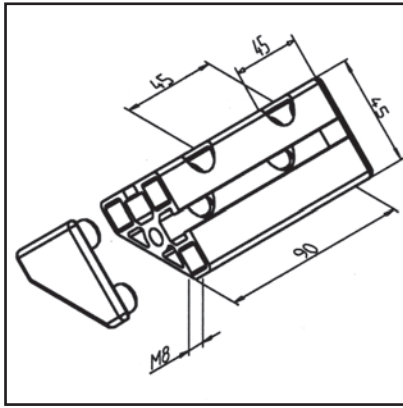

TECHN. DATA / ITEMS SUPPLIED

- Aluminium, anodized E6/EV1
- From profile 45/45°
- With fastening material steel, zinc plated
- With caps, grey
- Use on vertical struts **part no. 21.1727/4** (square nut with position-fixing)
- Weight = 0.175 kg/piece

APPLICATIONS

- Bracing in the composite structure

ASSEMBLY

- Screw the brace socket onto the frame
- Insert supports by means of MiniTec power-lock fasteners and tighten
- Install caps

CONNECTING PLATE 60 X 60 X 30

Part no.

21.0038/0

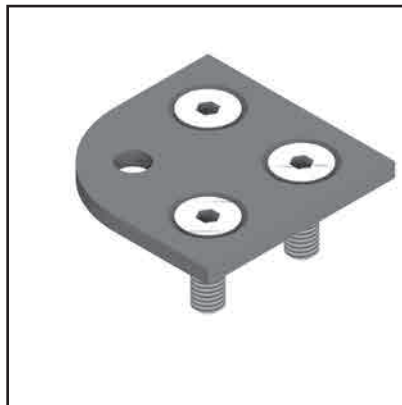
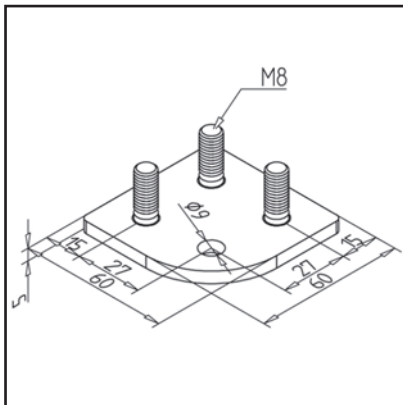

TECHN. DATA / ITEMS SUPPLIED

- Steel, powder-coated, grey
- With fastening nut steel, galvanized
- Fastening kit
- Weight = 0.145 kg/piece

APPLICATIONS

- Profile 60 x 60 x 30 **part no. 20.0982/0**
- For the construction of guide rollers
- Use of hinged foot M8

ASSEMBLY

- Front attachment to profile with supplied hardware
- Fasten to profile with fastening material from the scope of delivery

BASE AND TRANSPORT PLATE 90 X 90 X 45

Part no.

21.2505/0

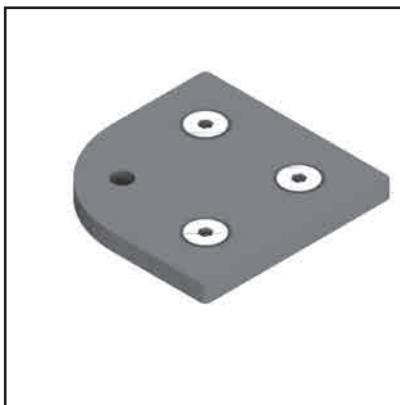
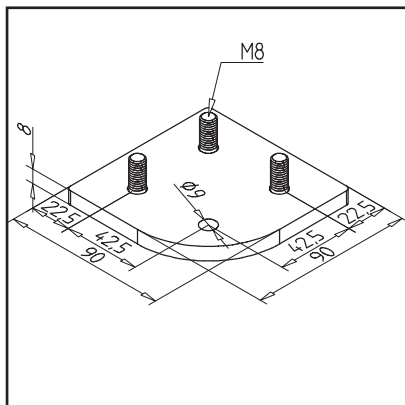

TECHN. DATA / ITEMS SUPPLIED

- Steel, powder-coated, grey
- With fastening material steel, zinc plated
- Weight = 0.488 kg/piece

APPLICATIONS

- Use of hinged foot M8
- For the construction of guide rollers
- To profile 90 x 90 x 45 **part no. 20.0984/0**

ASSEMBLY

- Front attachment to profile with supplied hardware

ADAPTER FLANGE 30

Part no.

21.2120/0

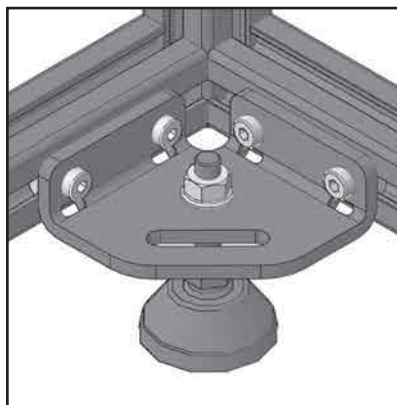
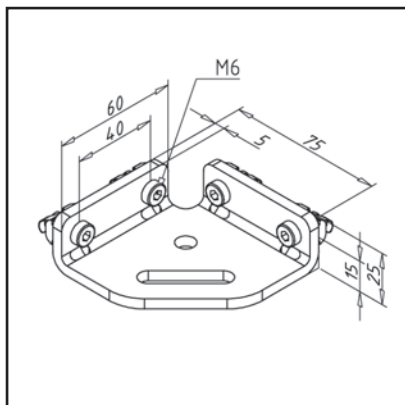

TECHN. DATA / ITEMS SUPPLIED

- Steel, powder-coated, grey
- With fastening material steel, zinc plated
- Weight = 0.261 kg/piece

APPLICATIONS

- Strengthening of profile constructions
- Fixation of internal feet or rollers
- Floor mounting and leveling constructions

ASSEMBLY

- Mount onto frame with fixation material from delivery scope

ADAPTER FLANGE 45

Part no.

21.2300/0

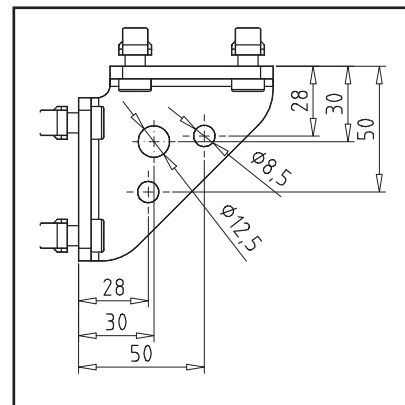
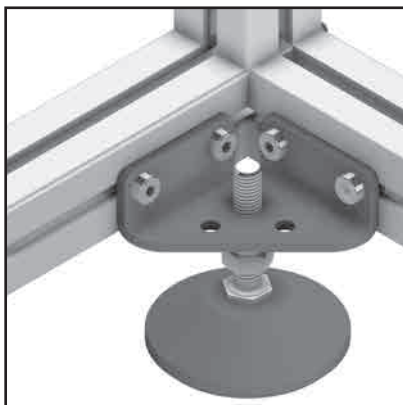
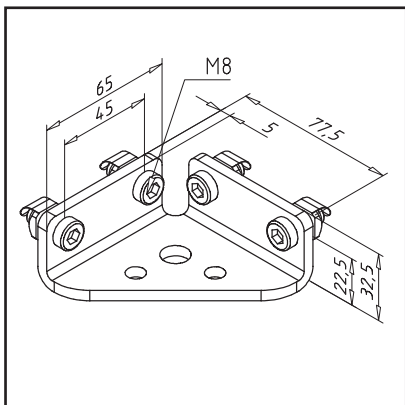

TECHN. DATA / ITEMS SUPPLIED

- Steel, powder-coated, grey
- With fastening material steel, zinc plated
- Weight = 0.311 kg/piece

APPLICATIONS

- Strengthening of profile constructions
- Fixation of internal feet or rollers
- Floor mounting and leveling constructions

ASSEMBLY

- Mount onto frame with fixation material from delivery scope

BEAM 90

Part no.

21.1783/0

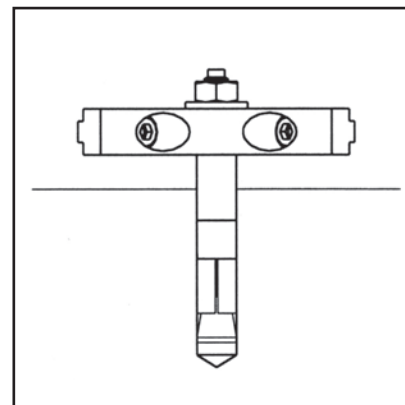
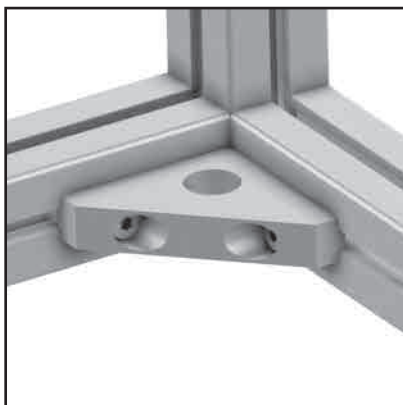
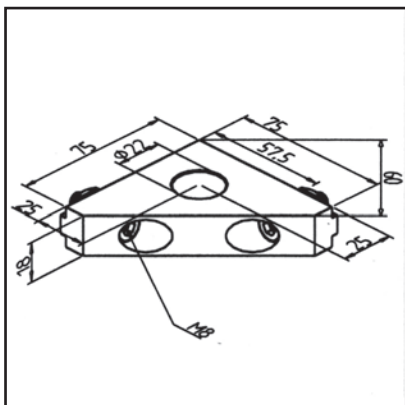

TECHN. DATA / ITEMS SUPPLIED

- Aluminium, anodized E6/EV1
- With fastening material steel, zinc plated
- Use on vertical struts **part no. 21.1783/7**
- Weight = 0.170 kg/piece

APPLICATIONS

- Strengthening of constructions
- Fixation of internal feet or rollers
- Floor mounting and leveling constructions

ASSEMBLY

- On profile side, with fastening kit
- On floor side, fasten with floor anchor

BEAM 180

Part no.

21.1784/0

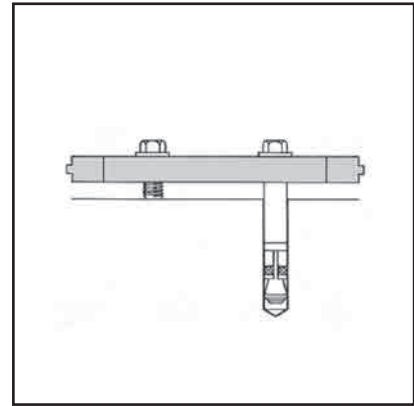
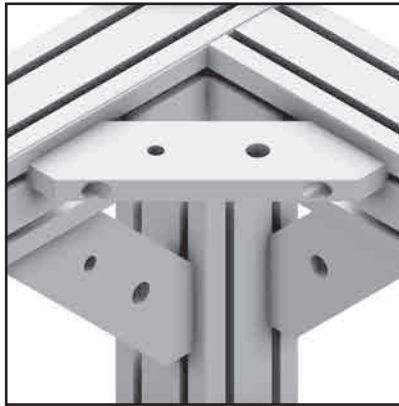
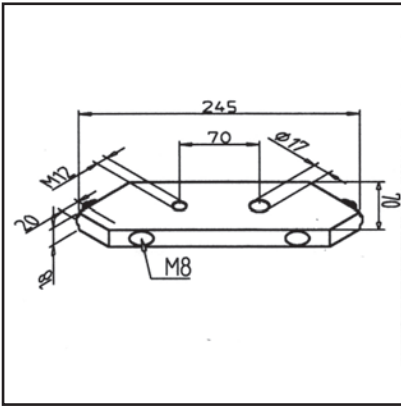

TECHN. DATA / ITEMS SUPPLIED

- Aluminium, anodized E6/EV1
- With fastening material steel, zinc plated
- Use on vertical struts **part no. 21.1784/7**
- Weight = 0.690 kg/piece

APPLICATIONS

- Strengthening of heavy constructions
- Fixation of internal feet or rollers
- Floor mounting and leveling heavy constructions

ASSEMBLY

- On profile side, with fastening kit
- On floor side, fasten with floor anchor and levelling screw M 12

STRENGTHENING ELEMENT 30

Part no.

21.2110/0

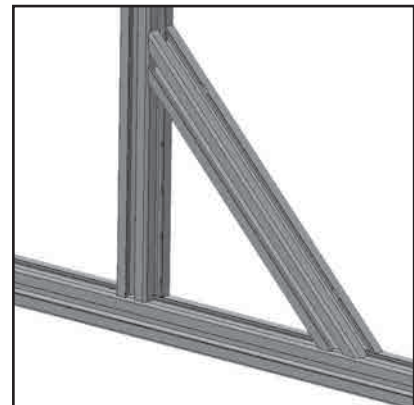
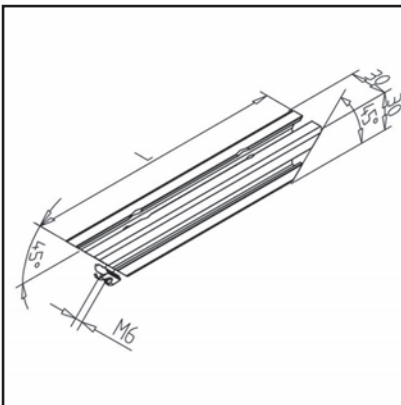

TECHN. DATA / ITEMS SUPPLIED

- Aluminium, anodized E6/EV1
- Length (l) : 360 mm
- Profile 30 x 30, ready for use
- Both ends cut at 45° with counter-bores for fastening kit
- With fastening material steel, zinc plated
- **Other lengths and designs under part no. 21.1761/5 on request**
- **Please specify dimension L**
- Weight = 0.212 kg/piece

APPLICATIONS

- Reinforcement of profile constructions in "timbered structure" principle

ASSEMBLY

- Screw on the profile groove of the frame construction with supplied hardware

STRENGTHENING ELEMENT 30 X 60

Part no.

21.2210/0

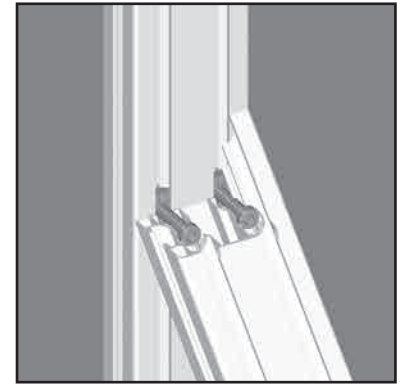
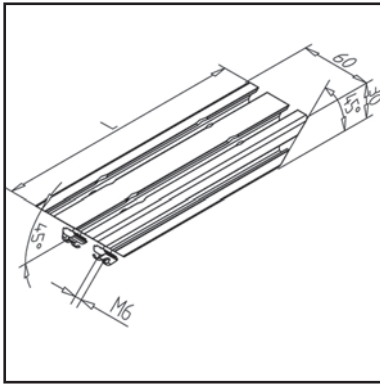
**TECHN. DATA / ITEMS SUPPLIED**

- Aluminium, anodized E6/EV1
- Length (l) : 360 mm
- Profile 30 x 60, ready for use
- Both ends cut at 45° with counter-bores for fastening kit
- With fastening material steel, zinc plated
- **Other lengths and designs under part no. 21.2210/5 on request**
- **Please specify dimension L**
- Weight = 0.338 kg/piece

APPLICATIONS

- Reinforcement of profile constructions in "timbered structure" principle

ASSEMBLY

- Screw on the profile groove of the frame construction with supplied hardware

STRENGTHENING ELEMENT 45

Part no.

21.1761/0

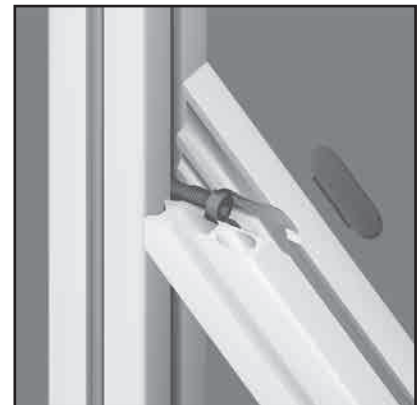
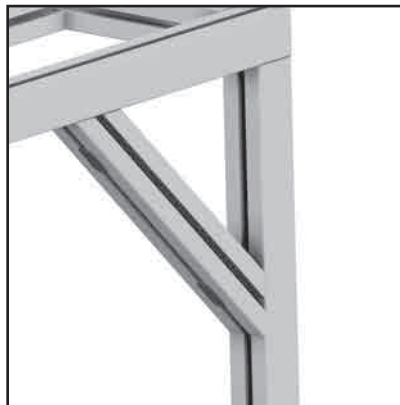
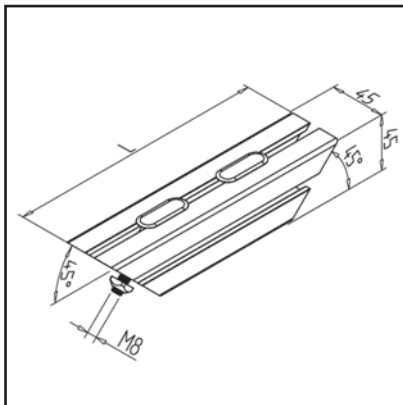
**TECHN. DATA / ITEMS SUPPLIED**

- Aluminium, anodized E6/EV1
- Length (l) : 360 mm
- Profile 45 x 45, ready for use
- Both ends cut at 45° with counter-bores for fastening kit
- With fastening material steel, zinc plated
- Use on vertical struts **part no. 21.1761/7** (square nut with position-fixing)
- **Other lengths and designs under part no. 21.1761/5 on request**
- **Please specify dimension L**
- Weight = 0.870 kg/piece

APPLICATIONS

- Reinforcement of profile constructions in "timbered structure" principle

ASSEMBLY

- Screw on the profile groove of the frame construction with supplied hardware

STRENGTHENING ELEMENT 45 VA

Part no.

21.1706/0

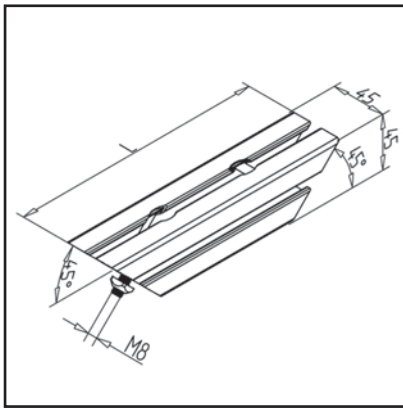

TECHN. DATA / ITEMS SUPPLIED

- Stainless steel
- Length (l) : 360 mm
- Profile 45x45 VA, ready for installation
- Both ends cut at 45° with counter-bores for fastening kit
- Fastening kit
- **Other lengths on request**
- **Please specify dimension L**
- Weight = 0.890 kg/piece



APPLICATIONS

- Reinforcement of profile constructions in "timbered structure" principle

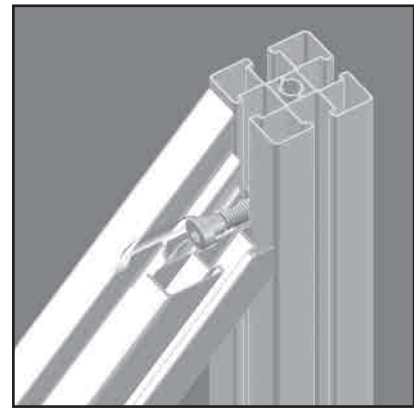

ASSEMBLY

- Screw on the profile groove of the frame construction with supplied hardware

STRENGTHENING ELEMENT 90

Part no.

21.1762/0

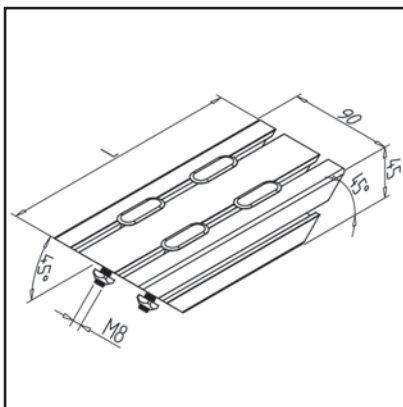

TECHN. DATA / ITEMS SUPPLIED

- Aluminium, anodized E6/EV1
- Length (l) : 360 mm
- Profile 45 x 90, ready for use
- Both ends cut at 45° with 4 counter-bores for fastening kit
- With fastening material steel, zinc plated
- **Other lengths and designs under part no. 21.1762/5 on request**
- **Please specify dimension L**
- Weight = 1.416 kg/piece

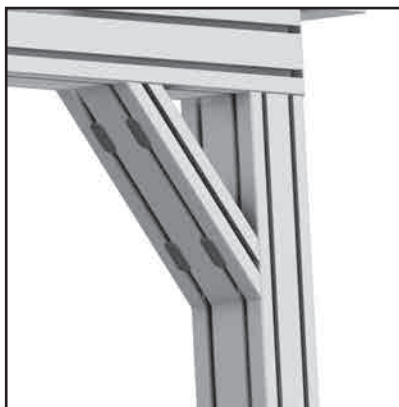

APPLICATIONS

- Reinforcement of profile constructions in "timbered structure" principle



ASSEMBLY

- Screw on the profile groove of the frame construction with supplied hardware

CANTILEVER FOOT 175

Part no.

21.2191/0

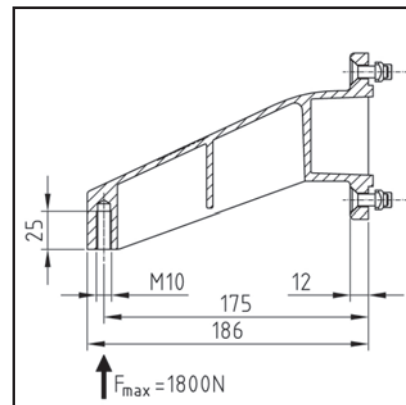
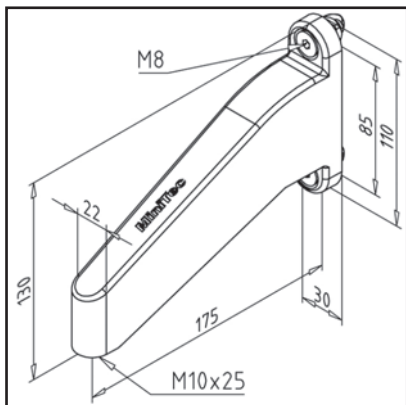

TECHN. DATA / ITEMS SUPPLIED

- Aluminium, Pressure die-casting, powder-coated, grey
- With fastening material steel, zinc plated
- Weight = 0.369 kg/piece

APPLICATIONS

- Placing frames and attaching stands

ASSEMBLY

- Attachment to profile strut with fastening material
- Fastening of casters, articulated feet, and screws M10

SUPPORTING FOOT 45 GD

Part no.

21.1731/0

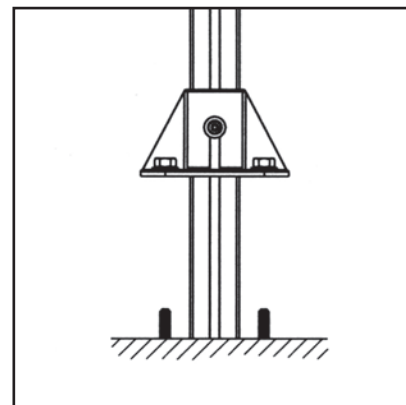
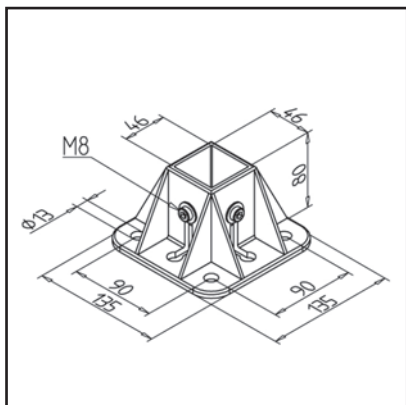

TECHN. DATA / ITEMS SUPPLIED

- Aluminium, Pressure die-casting, powder-coated, grey
- With galvanized steel fastening material, for profile
- Package size of 10 pieces **part no. 21.1731/010**
- Weight = 0.587 kg/piece

APPLICATIONS

- Suitable for profiles up to dimension 45 x 45
- Floor fastening of protective fields, signboards, racks
- As connection element for wall attachment; can be used both-sided

ASSEMBLY

- Insert profile into foot
- Insert the square nut with spring steel sheet into the profile groove; preassemble the screws
- Fix the floor stand to the floor or wall, using the high-performance anchors or the universal pin with a hexagonal screw
- Tighten fastening screws

COVER SUPPORTING FOOT 45

Part no.

22.1164/0

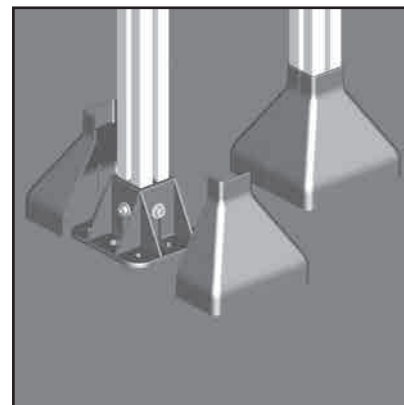
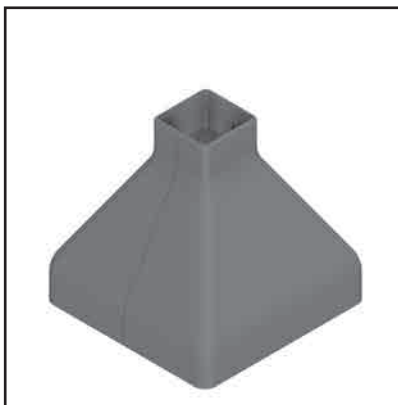
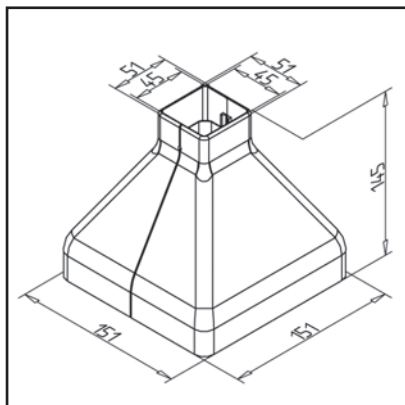

TECHN. DATA / ITEMS SUPPLIED

- ABS, grey
- Weight = 0.166 kg/pair

APPLICATIONS

- To cover the stand foot 45 GD and 45 GD open

ASSEMBLY

- Attach to profiles/stand foot

SUPPORTING FOOT 45 GD OPEN

Part no.

21.1738/0

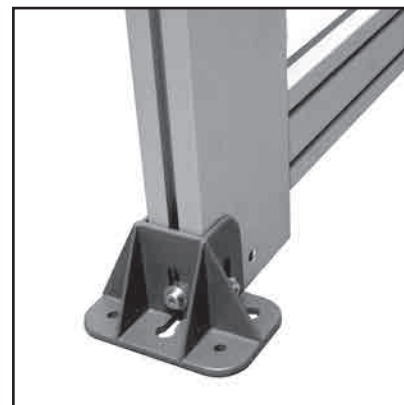
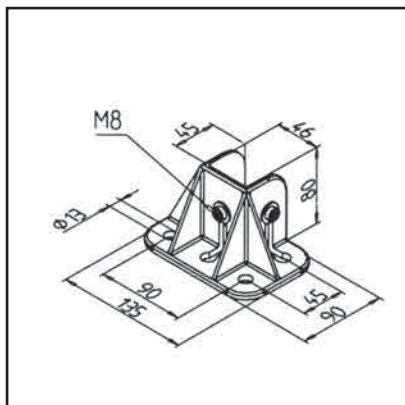

TECHN. DATA / ITEMS SUPPLIED

- Aluminium, Pressure die-casting, powder-coated, grey
- With galvanized steel fastening material, for profile
- Package size of 10 pieces **part no.. 21.1738/010**
- Weight = 0.356 kg/piece

APPLICATIONS

- Floor fastening of protective fields, signboards, racks
- As connection element for wall attachment; can be used both-sided

ASSEMBLY

- Insert profile into foot
- Insert the square nut with spring steel sheet into the profile groove; preassemble the screws
- Fix the floor stand to the floor or wall, using the high-performance anchors or the universal pin with a hexagonal screw
- Tighten fastening screws

SUPPORTING FOOT 45 GD S

Part no. 21.1723/0

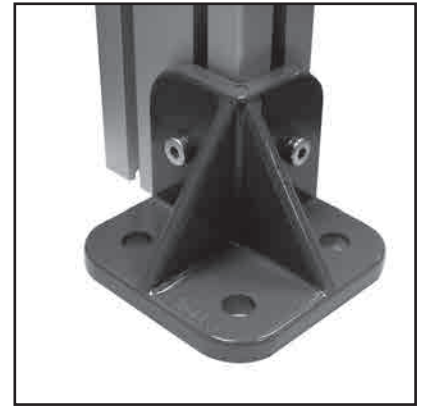
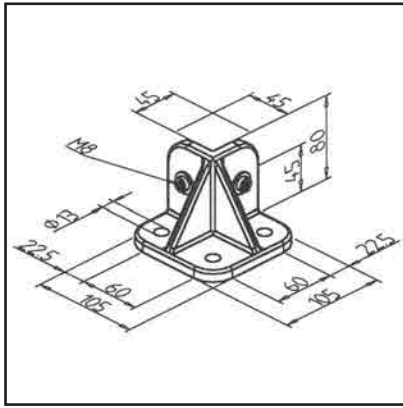

TECHN. DATA / ITEMS SUPPLIED

- Aluminium, Pressure die-casting, powder-coated, grey
- With galvanized steel fastening material, for profile
- Package size of 10 pieces **part no.. 21.1723/010**
- Weight = 0.499 kg/piece

APPLICATIONS

- Floor fastening of protective fields, sign-boards, racks
- As connection element for wall attachment; can be used both-sided
- For all profiles

ASSEMBLY

- Fix the floor stand to the floor or wall, using the high-performance anchors or the universal pin with a hexagonal screw
- Tighten fastening screws

SUPPORTING FOOT 90 GD

Part no. 21.1737/0

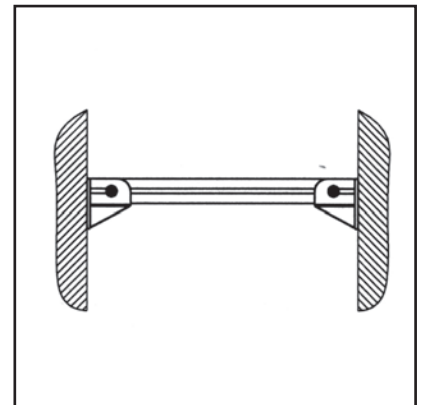
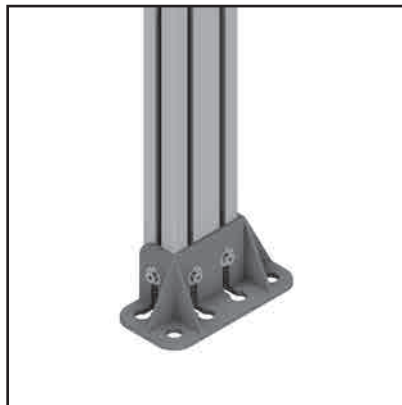
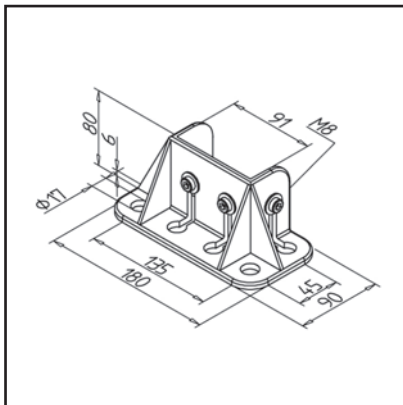

TECHN. DATA / ITEMS SUPPLIED

- Aluminium, Pressure die-casting, powder-coated, grey
- With galvanized steel fastening material, for profile
- Package size of 10 pieces **part no.. 21.1737/010**
- Weight = 0.465 kg/piece

APPLICATIONS

- Fitting for profiles with maximum dimension of 45 x 90, 90 x 90 and 90 x 180
- Floor fastening of protective fields, sign-boards, racks
- As connection element for wall attachment; can be used both-sided

ASSEMBLY

- Insert profile into foot
- Insert the square nut with spring steel sheet into the profile groove; preassemble the screws
- Fix the floor stand to the floor or wall, using the high-performance anchors or the universal pin with a hexagonal screw
- Tighten fastening screws

SUPPORTING FOOT 90 S

Part no.

21.1707/0

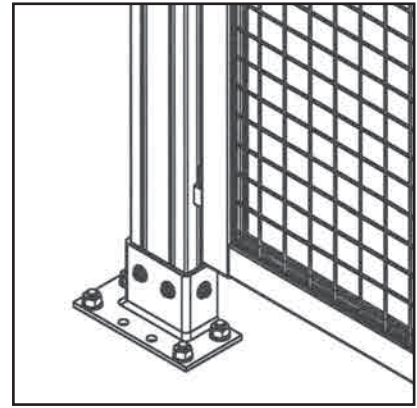
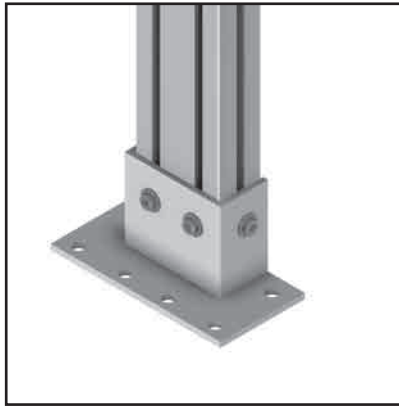
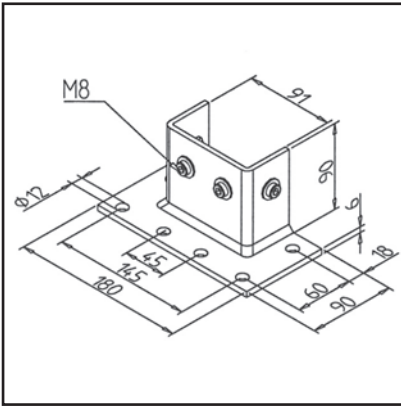

TECHN. DATA / ITEMS SUPPLIED

- Steel, galvanized
- With galvanized steel fastening material, for profile
- Weight = 1.438 kg/piece

APPLICATIONS

- Fitting for profiles with maximum dimension of 45 x 90, 90 x 90 and 90 x 180
- Floor fastening of protective fields, sign-boards, racks
- As connection element for wall attachment; can be used both-sided

ASSEMBLY

- Insert the square nut with spring steel sheet into the profile groove; preassemble the screws
- Fix the floor stand to the floor or wall, using the high-performance anchors or the universal pin with a hexagonal screw
- Tighten fastening screws

COVER SUPPORTING FOOT 90

Part no.

22.1025/1

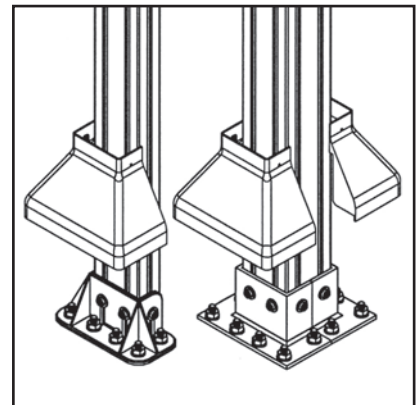
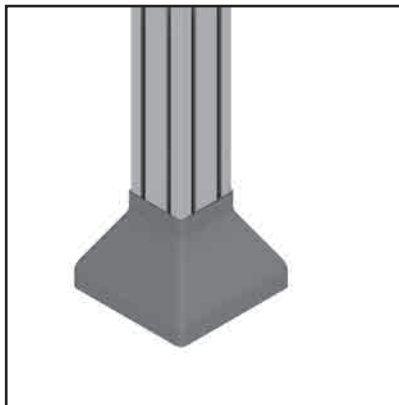
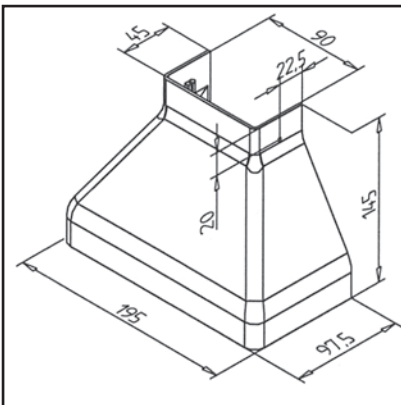

TECHN. DATA / ITEMS SUPPLIED

- ABS, grey
- Weight = 0.131 kg/piece

APPLICATIONS

- Suitable for foot 90 GD and 90 S
- Less dust and dirt deposit on the foot
- Easy to clean

ASSEMBLY

- Expand the cover manually and clip in the slots of the profile
- Push the cover downwards
- Fasten on the side with tapping screw 3.4 x 16, then drill hole \varnothing 2.5 mm at the marked location

TRANSPORT AID

Part no.

26.1101/0

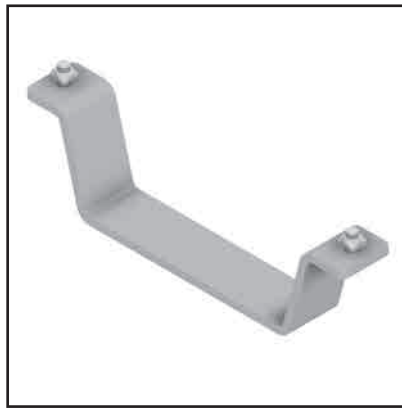
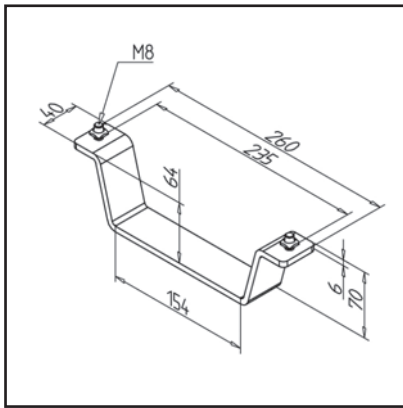
**TECHN. DATA / ITEMS SUPPLIED**

- Steel, galvanized
- With fastening material steel, zinc plated
- Weight = 0.708 kg/piece

APPLICATIONS

- Securing of constructions when transported by forklift truck

ASSEMBLY

- Mount under construction with fastening material from the scope of supply to the profile groove
- Use always in pairs