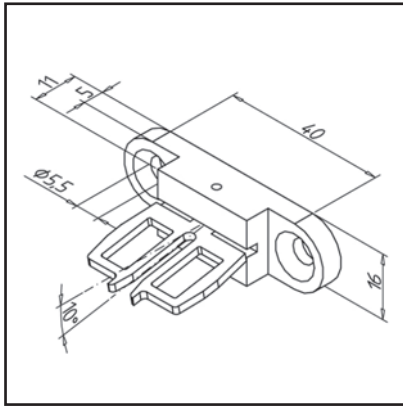

ACTUATING BOW FOR SECURITY SWITCH B3

Part no.

21.1110/3

**TECHN. DATA / ITEMS SUPPLIED**

- Separator guide, typ B3, for particularly small operating radius over the narrow side of the bracket
- Weight = 0.030 kg/piece

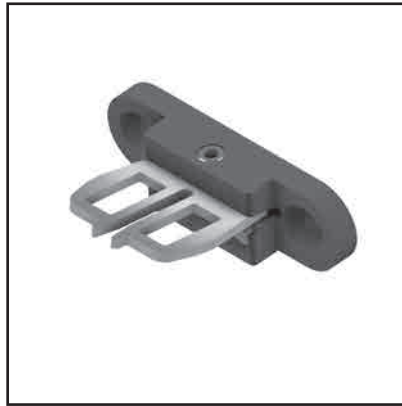
**APPLICATIONS**

- Operating handle for small operating radii in conjunction with safety switch **part no. 21.1110/0**, replaces the standard strap

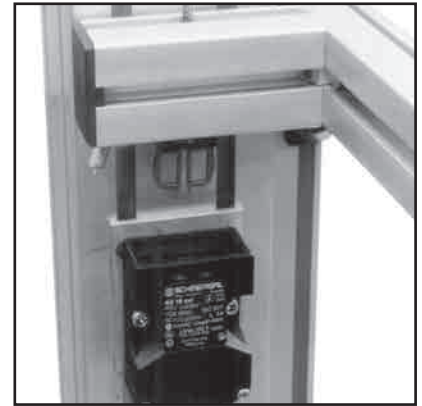
**ASSEMBLY**

- With fastening kit from items supplied secure the safety switch to the profile groove
- Directly on panel element with countersunk screws M5 according to material thickness

ACTUATING BOW FOR SECURITY SWITCH B2

Part no.

21.1110/2

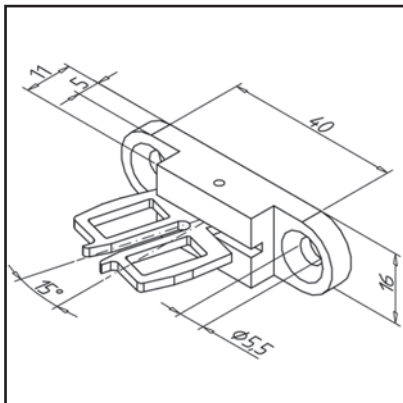
**TECHN. DATA / ITEMS SUPPLIED**

- Separator guide, B2, for particularly small operating radius over the wide side of the bracket
- Weight = 0.030 kg/piece

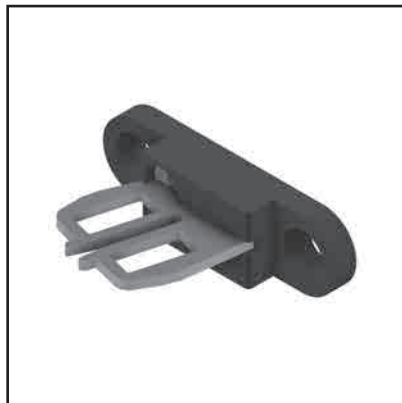
**APPLICATIONS**

- Operating handle for small operating radii in conjunction with safety switch **part no. 21.1110/0**, replaces the standard strap

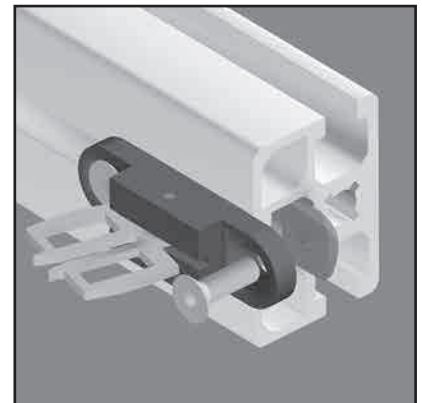
**ASSEMBLY**

- With fastening kit from items supplied secure the safety switch to the profile groove
- Directly on panel element with countersunk screws M5 according to material thickness

SECURITY SWITCH WITH LOCK

Part no. 21.1766/0

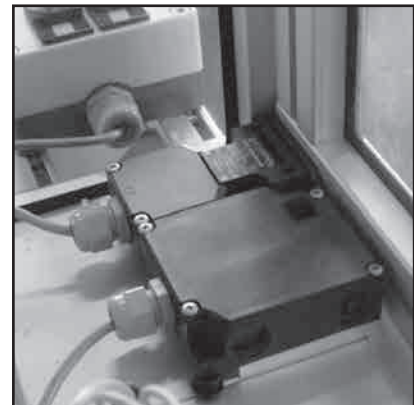
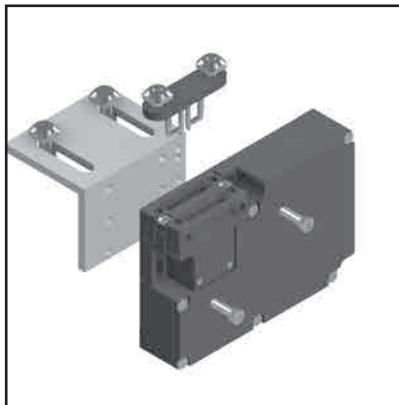
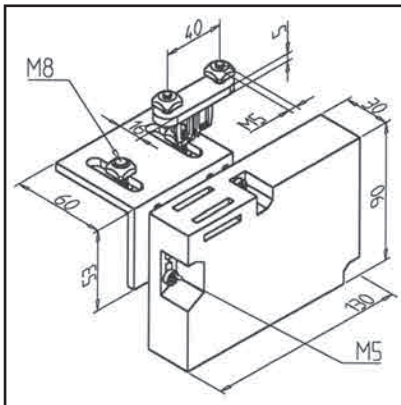

TECHN. DATA / ITEMS SUPPLIED

- Switch, type AZM 161SK-12/12RK-024
- Thermoplastic housing, black, self-extinguishing
- Protective system IP67, nominal operating current 10 A (230 V), driving voltage 24 V AC/DC, power consumption 10 W
- Fastening kit
- Optionally also with control voltage 110 V AC or 230 V AC available
- Weight = 0.480 kg/piece

APPLICATIONS

- For protective equipment with high safety requirements

ASSEMBLY

- Fasten with fixing material to profile groove
- For small radii, use actuating yoke B6 **part no. 21.1766/2**.

CABLE DUCT 27 AL

Part no. 20.1051/0

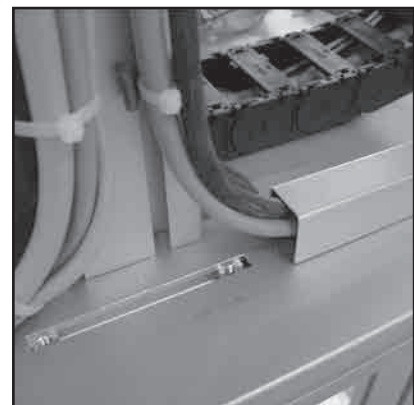
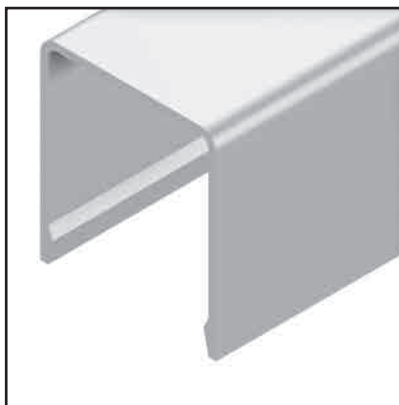
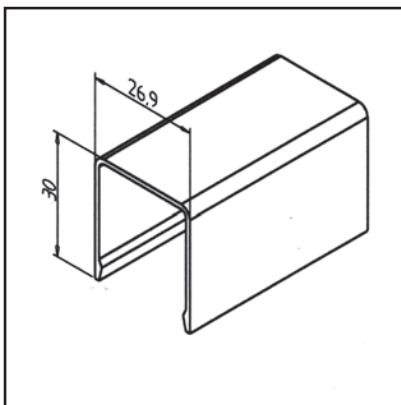

TECHN. DATA / ITEMS SUPPLIED

- Aluminium, extruded, anodized E6/EV1
- Weight = 0.193 kg/m
- Bar length = 6 m

APPLICATIONS

- Cover for cables and pneumatic hoses

ASSEMBLY

- On clamp **part no. 22.1204/0** or **part-no. 22.1212/0** clipping on
- Earthing brackets for optional grounding **part no. E9.0141/0** can be used

END CAP CABLE DUCT 27 AL

Part no. 22.1119/1

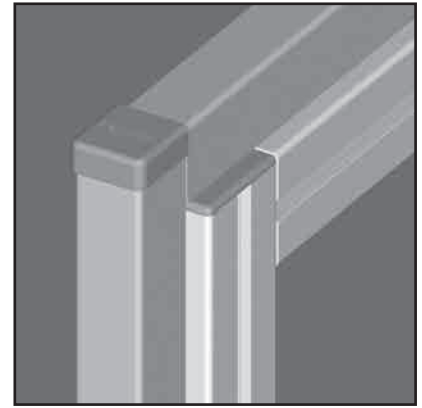
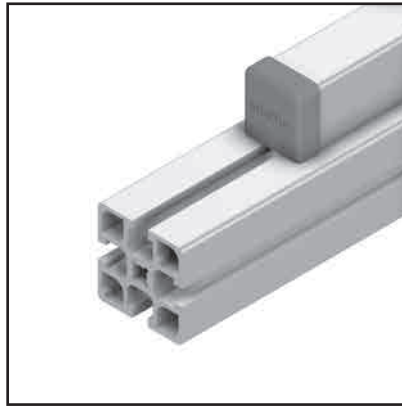
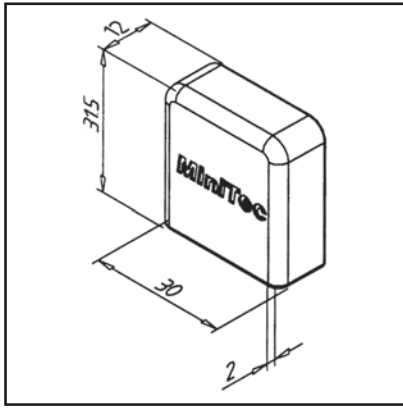

TECHN. DATA / ITEMS SUPPLIED

- ABS, Injection Mould, grey
- Weight = 0.004 kg/piece

APPLICATIONS

- End cap for conduit AL
- Manufacture external angles with cable duct AL

ASSEMBLY

- Simply push onto the end of the cable duct

EDGE PROTECTION FOR CABLE DUCT 27 AL

Part no. 22.1120/1

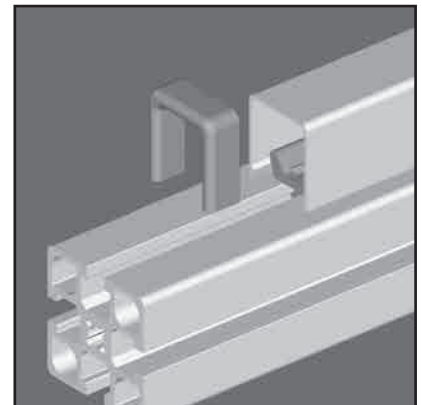
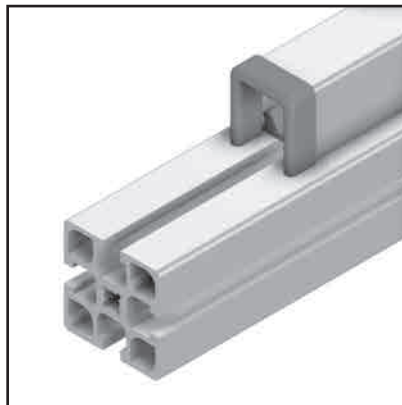
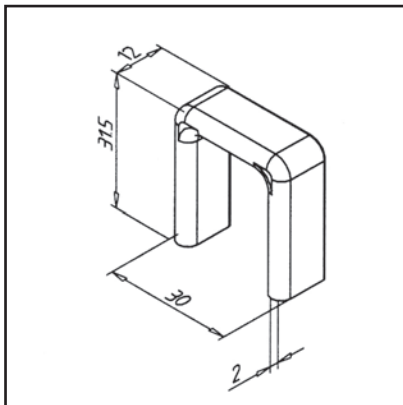

TECHN. DATA / ITEMS SUPPLIED

- ABS, Injection Mould, grey
- Weight = 0.003 kg/piece

APPLICATIONS

- Edge protection for conduit AL

ASSEMBLY

- Simply push onto the end of the cable duct

INNER ANGLE CABLE DUCT 27 AL

Part no. 22.1121/1

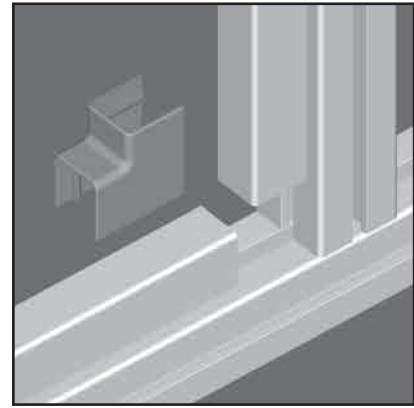
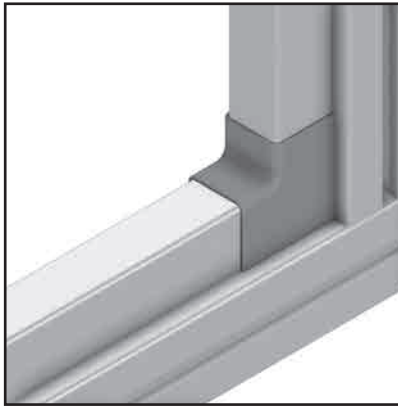
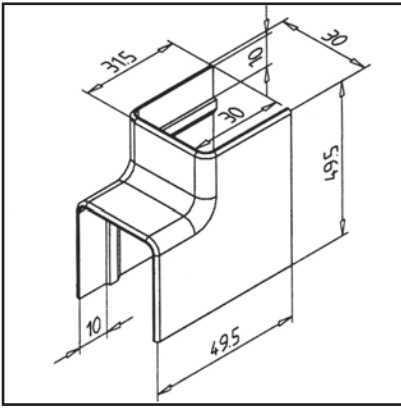

TECHN. DATA / ITEMS SUPPLIED

- ABS, Injection Mould, grey
- Weight = 0.009 kg/piece

APPLICATIONS

- Connect the cable duct AL to the inner angle

ASSEMBLY

- Clip the first side of cable duct on clamps.
- Insert the angle
- Click on the second side of the cable duct and slide along as far as the stop

CABLE DUCT 45 AL

Part no. 20.1071/0

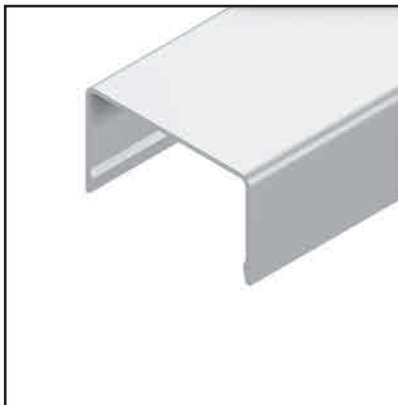
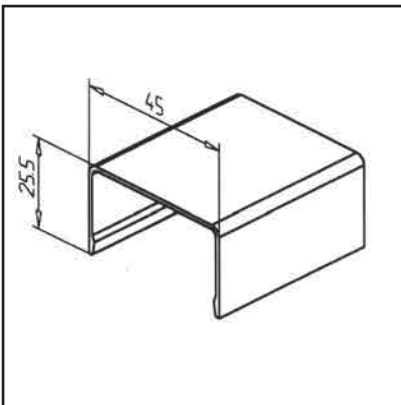

TECHN. DATA / ITEMS SUPPLIED

- Aluminium, anodized E6/EV1
- Weight = 0.301 kg/m
- Bar length = 6 m

APPLICATIONS

- Cover for cables and pneumatic hoses

ASSEMBLY

- On clamp 45 **part no. 22.1210/0** clipping on
- Earthing brackets for optional grounding **part no. E9.0141/0** can be used

CAP CABLE DUCT 45 AL

Part no. 22.1116/1

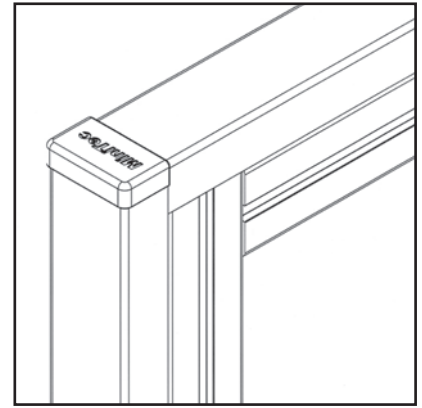
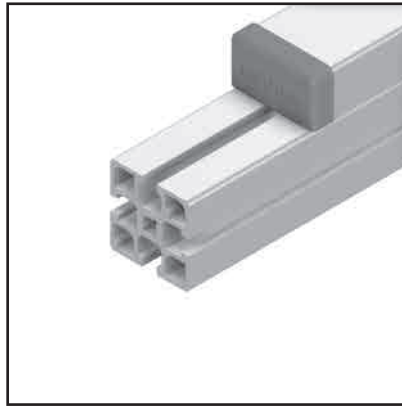
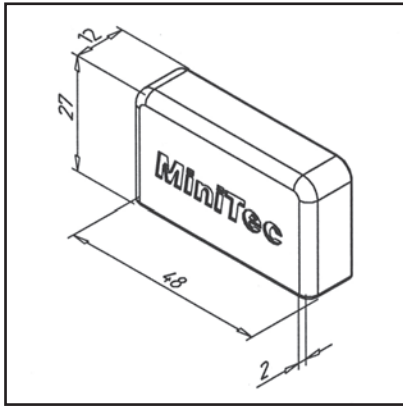

TECHN. DATA / ITEMS SUPPLIED

- ABS, Injection Mould, grey
- Weight = 0.006 kg/piece

APPLICATIONS

- Finish the cable duct 45
- Production of external angle with cable canal 45 AL

ASSEMBLY

- Simply push onto the end of the cable duct

PROTECTION CAP CABLE DUCT 45 AL

Part no. 22.1117/1

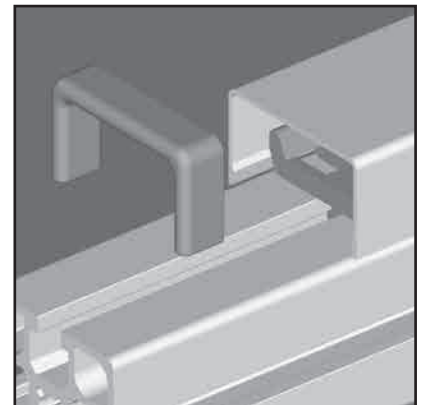
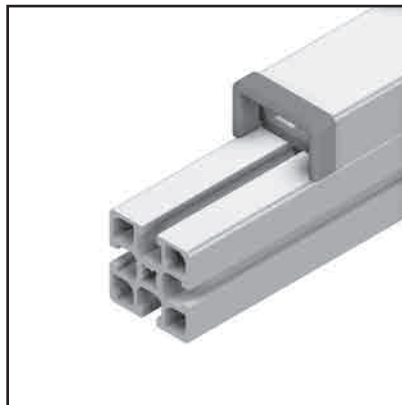
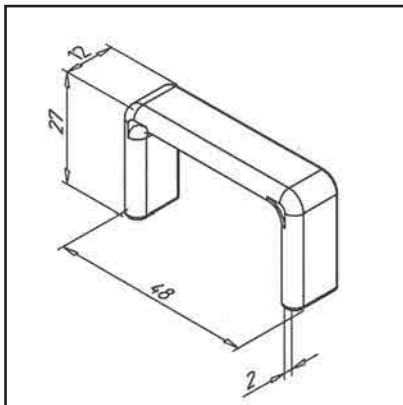

TECHN. DATA / ITEMS SUPPLIED

- ABS, Injection Mould, grey
- Weight = 0.005 kg/piece

APPLICATIONS

- Edge protection for Cabel Canal 45 AL

ASSEMBLY

- Simply push onto the end of the cable duct

INSIDE ANGLE CABLE DUCT 45 AL

Part no.

22.1118/1

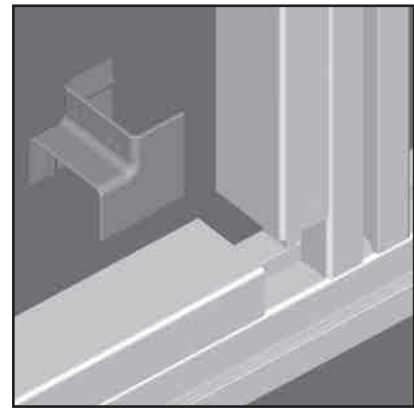
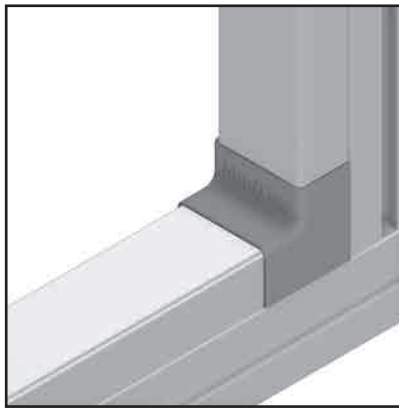
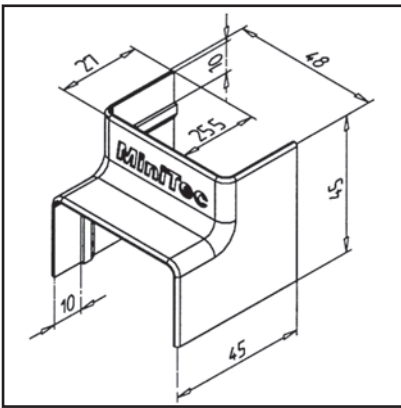

TECHN. DATA / ITEMS SUPPLIED

- ABS, Injection Mould, grey
- Weight = 0.010 kg/piece

APPLICATIONS

- Connecting cable canal 45 AL to internal angles

ASSEMBLY

- Clip the first side of cable duct on clamps.
- Insert the angle
- Click on the second side of the cable duct and slide along as far as the stop

ANGLE 90° FOR CABLE DUCT 45 AL

Part no.

22.1156/0

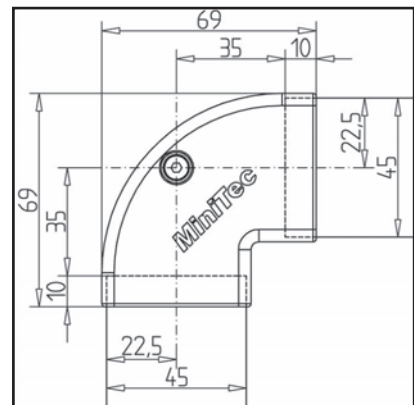
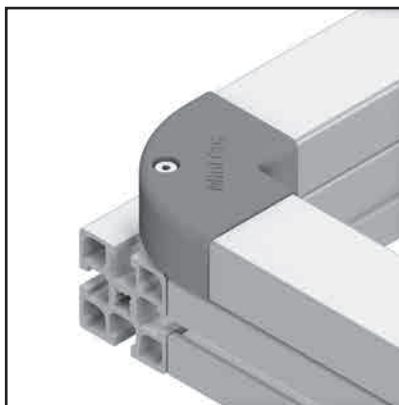
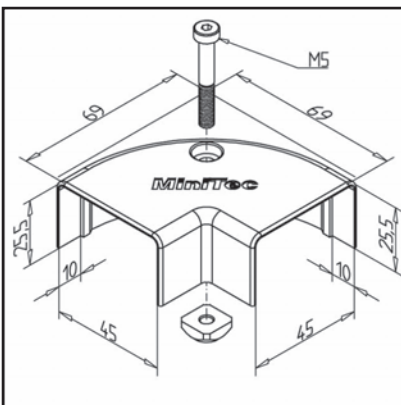

TECHN. DATA / ITEMS SUPPLIED

- ABS, Injection Mould, grey
- Fastening kit
- Weight = 0.026 kg/piece

APPLICATIONS

- Connection of cable canal 45 AL

ASSEMBLY

- Push on both channel ends 45, tighten the screw

ADAPTER CAP CONNECTOR STRIP FOR CABLE DUCT 45 AL

Part no.

22.1154/1

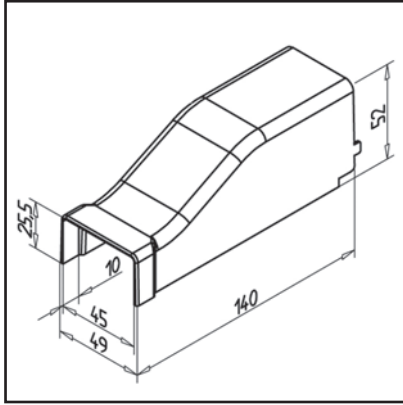

TECHN. DATA / ITEMS SUPPLIED

- ABS, Injection Mould, grey
- Weight = 0.034 kg/piece

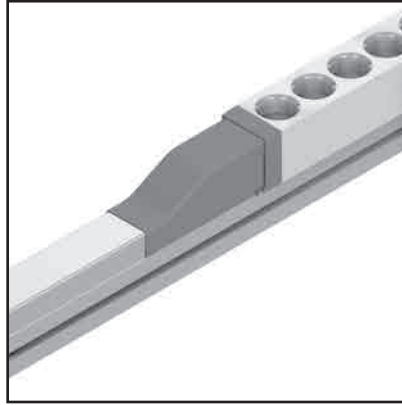

APPLICATIONS

- Cover of cable canal 45 AL

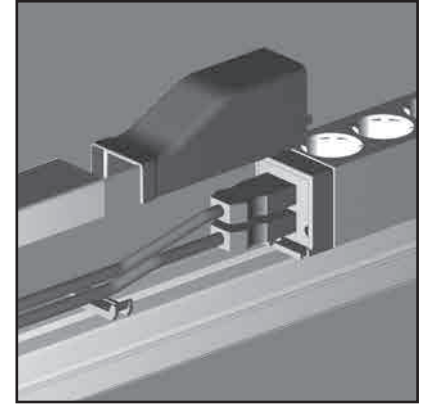

ASSEMBLY

- Clip onto cable conduit 45

CABLE DUCT 90 AL

Part no.

20.1056/0

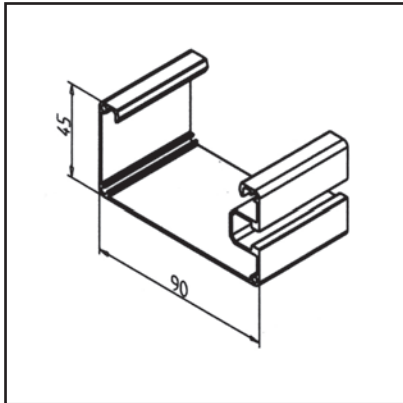

TECHN. DATA / ITEMS SUPPLIED

- Aluminium, anodized E6/EV1
- Weight = 0.971 kg/m
- Bar length = 6 m

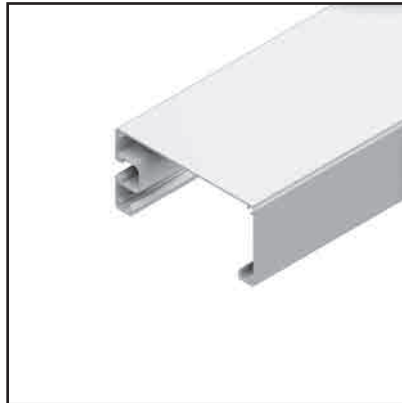

APPLICATIONS

- Cover for cables and pneumatic hoses
- Suitable for MiniTec profiles, grid dimension: 90
- Can also be swung open, when used with hinges
- End ledges with integrated energy supply

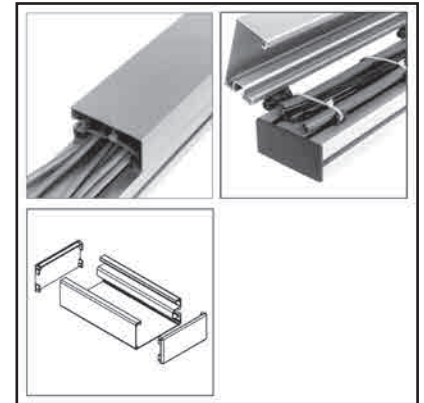

ASSEMBLY

- On clamp **part no. 22.1204/0** or **part-no. 22.1212/0** clipping on
- Cap **part no. 22.1045/0**
- Earthing brackets for optional grounding **part no. E9.0141/0** can be used

END CAP FOR CABLE DUCT 90 AL

Part no.

22.1045/0

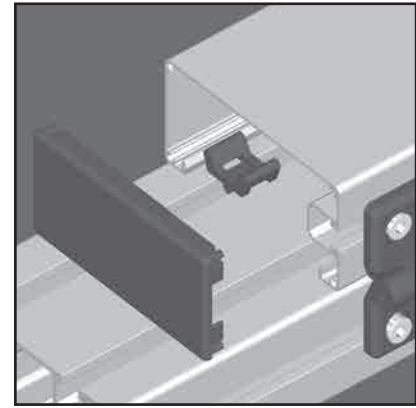
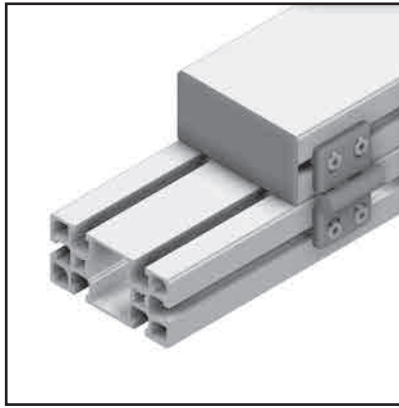
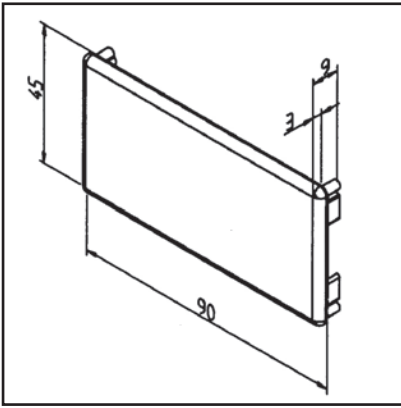

TECHN. DATA / ITEMS SUPPLIED

- ABS, Injection Mould, grey
- Weight = 0.011 kg/piece

APPLICATIONS

- Termination of cable canal 90 AL
- Constructions of corners on outside face

ASSEMBLY

- Simply push onto the end of the cable duct

CABLE CLIP 27-30

Part no.

22.1212/0

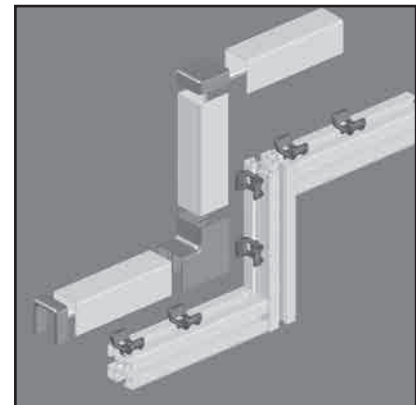
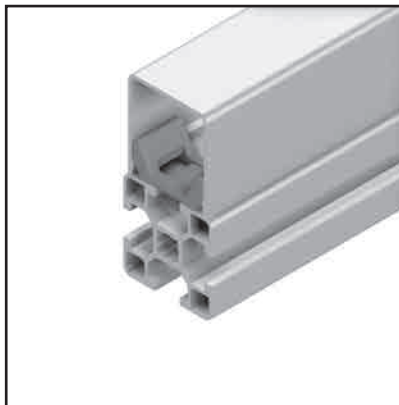
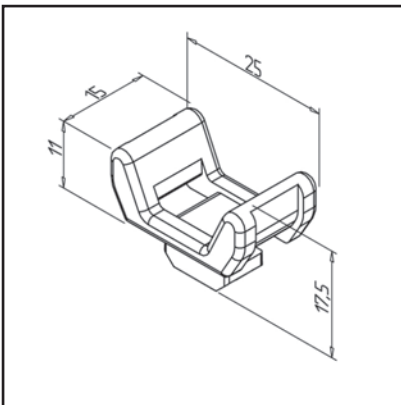

TECHN. DATA / ITEMS SUPPLIED

- PA, Injection Mould, grey
- Weight = 0.002 kg/piece

APPLICATIONS

- Simple and rational fastening of cables and pneumatic hoses
- Fixing of cable canal 27 AL
- For use of all profile types of profile series 30

ASSEMBLY

- Insert in profile groove and fix by 90° rotation
- Insert cable tie band through the cable clip and around the cable. Bind together, cut off any excessive length

CABLE CLIP 27-45

Part no.

22.1204/0

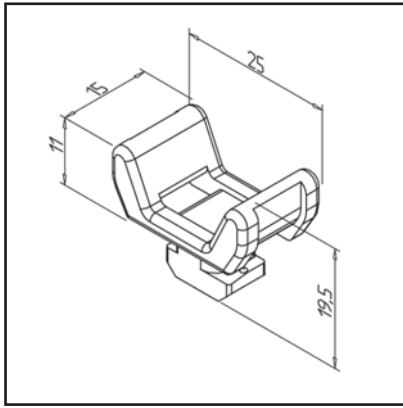
**TECHN. DATA / ITEMS SUPPLIED**

- PA, Injection Mould, grey
- Weight = 0.003 kg/piece

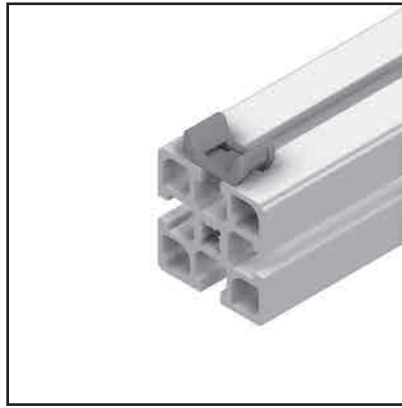
**APPLICATIONS**

- Simple and rational fastening of cables and pneumatic hoses
- Fixing of cable canal 27 AL and cable canal 90 AL
- Use with all profiles of the 45 profile series

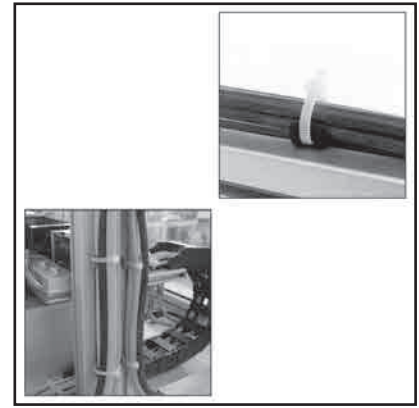
**ASSEMBLY**

- Insert in profile groove and fix by 90° rotation
- Insert cable tie band through the cable clip and around the cable. Bind together, cut off any excessive length

CLAMP 27-45 C

Part no.

22.1216/0

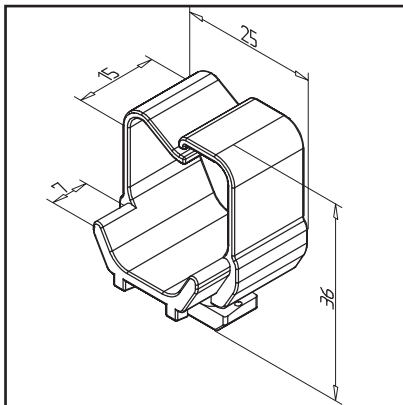
**TECHN. DATA / ITEMS SUPPLIED**

- PP, Injection Mould, grey
- Weight = 0.004 kg/piece

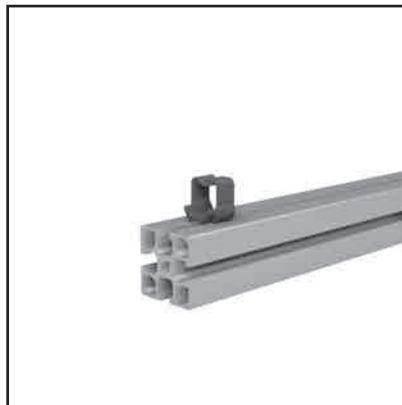
**APPLICATIONS**

- Simple and rational fastening of cables and pneumatic hoses
- Fixing of cable canal 27 AL and cable canal 90 AL
- Use with all profiles of the 45 profile series
- Preferably to be used for laying cables and hoses overhead or for frequent changes to the installation.

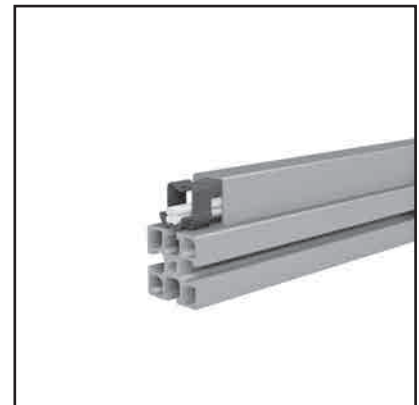
**ASSEMBLY**

- Insert in profile groove and fix by 90° rotation
- Simply clip cables and hoses up to 8 mm diameter into the clamp. Removal is also possible.
- If necessary, fasten cables with cable ties. Thread the cable ties into the end of the clamp (7mm) and tighten.

CABLE CLIP 45

Part no.

22.1210/0

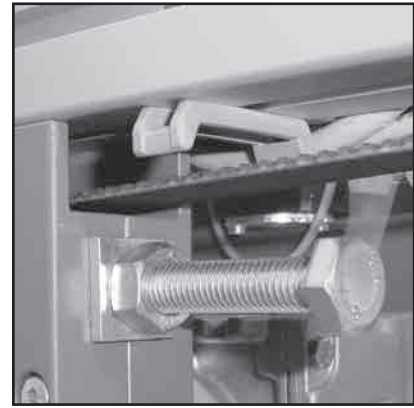
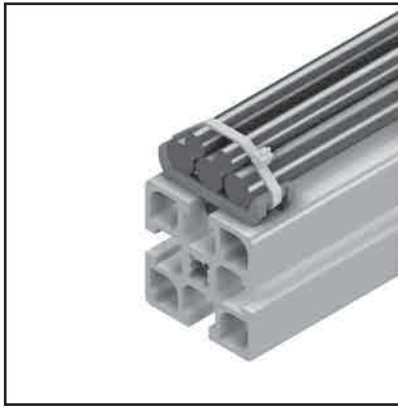
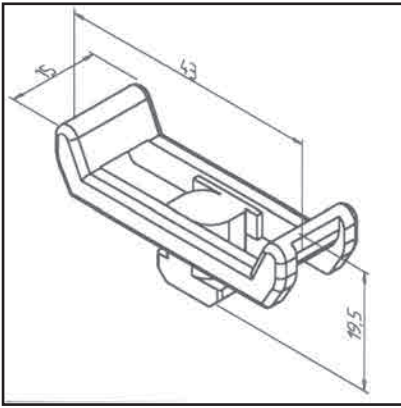

TECHN. DATA / ITEMS SUPPLIED

- PA, Injection Mould, grey
- Weight = 0.004 kg/piece

APPLICATIONS

- Simple and rational fastening of cables and pneumatic hoses
- Suitable for conduit 45 AL

ASSEMBLY

- Insert in profile groove and fix by 90° rotation
- Insert cable tie band through the cable clip and around the cable. Bind together, cut off any excessive length
- Cover of timing belt, chains etc.

CABLE CLAMP 45

Part no.

22.1270/0

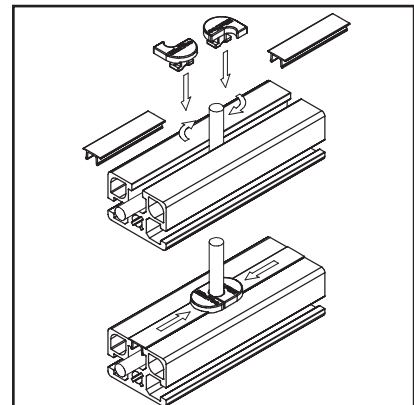
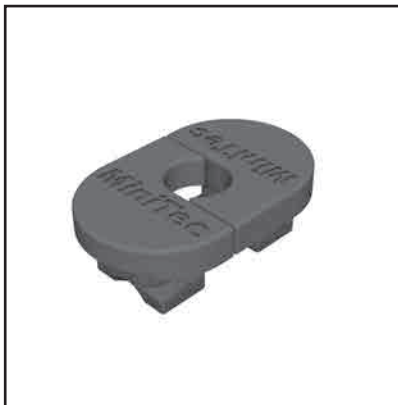
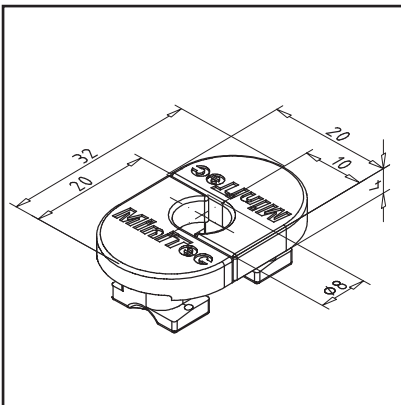

TECHN. DATA / ITEMS SUPPLIED

- ABS, Injection Mould, grey
- The cable clamp (2-part) consists of 2 identical components
- Weight = 0.028 kg/pair

APPLICATIONS

- For fixing cables and hoses laid in the profile groove
- For cables up to 8 mm diameter
- Please note the bending radius of the cables.
- Use with all profiles of the 45 profile series

ASSEMBLY

- Swing both parts to the left and right of the cable into the profile groove, then push them together.
- When using cover profiles to close the grooves, this can be pushed under the cable clamp approx. 4 mm deep.

ENERGY CHAIN R

Part no.

33.0410/0

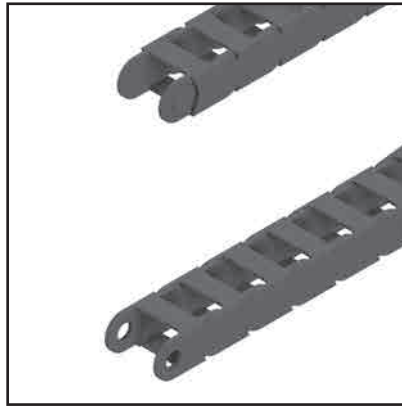
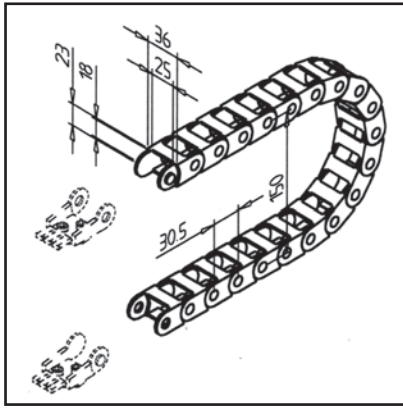

TECHN. DATA / ITEMS SUPPLIED

- Plastic, black
- Without fastening kit
- Weight = 0.341 kg/m

APPLICATIONS

- Energy chain to bind cables and hoses on slides and movable elements

ASSEMBLY

- Fixing the energy chain means of connection elements **part no. 33.0411/0**

MOUNTING BRACKETS FOR ENERGY CHAIN R

Part no.

33.0411/0

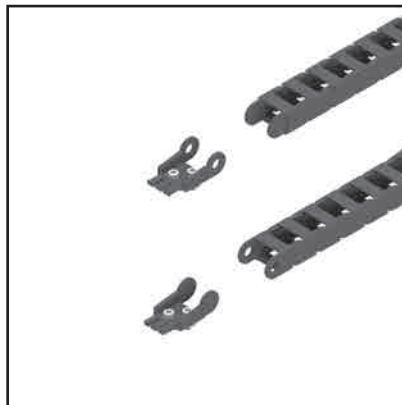
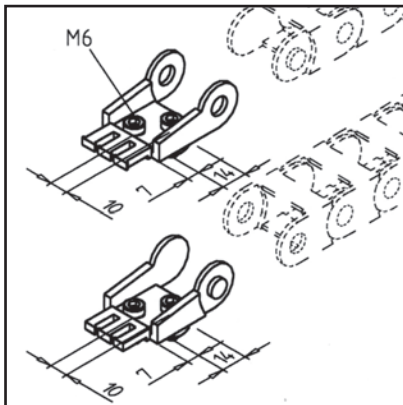

TECHN. DATA / ITEMS SUPPLIED

- Plastic, black
- With fastening material steel, zinc plated
- One element to the right and to the left
- Weight = 0.058 kg/piece

APPLICATIONS

- To attach the energy chain R **part no. 33.0410/0** to profile construction

ASSEMBLY

- Fasten at a suitable place with supplied hardware
- Use cable tie band to fix cables and hoses

CABLE DUCT 32

Part no.

22.1082/0

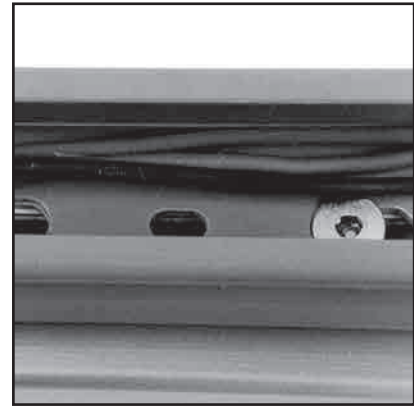
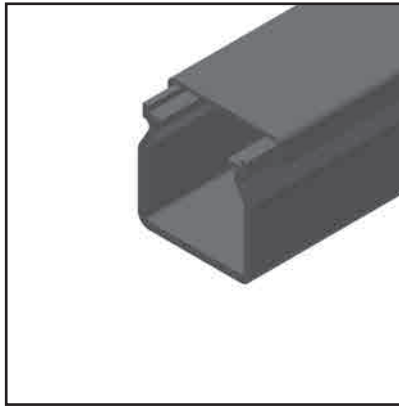
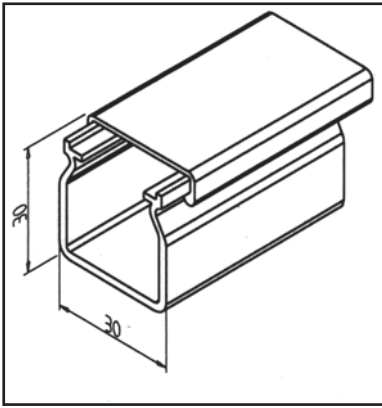

TECHN. DATA / ITEMS SUPPLIED

- PVC, grey
- Snap-cover
- Weight = 0.275 kg/m
- Bar length = 2 m

APPLICATIONS

- Installation of cables and hoses of all kinds

ASSEMBLY

- Fastening with screws M6 x 12 and rhombus-nut M6

CABLE DUCT 45

Part no.

22.1084/0

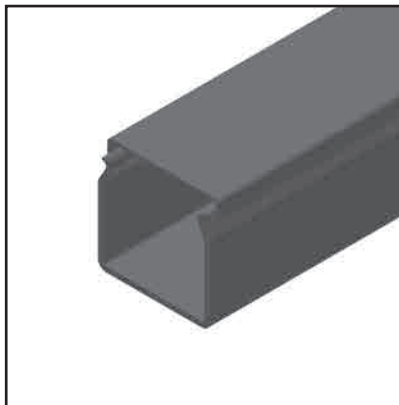
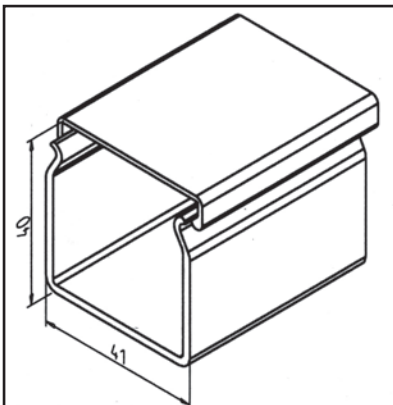

TECHN. DATA / ITEMS SUPPLIED

- PVC, grey
- Snap-cover
- Weight = 0.402 kg/m
- Bar length = 2 m

APPLICATIONS

- Installation of cables and hoses of all kinds

ASSEMBLY

- Fastening with screws M6 x 12 and rhombus-nut M6

PROXIMITY SWITCH HOLDER 12

Part no.

28.0120/0

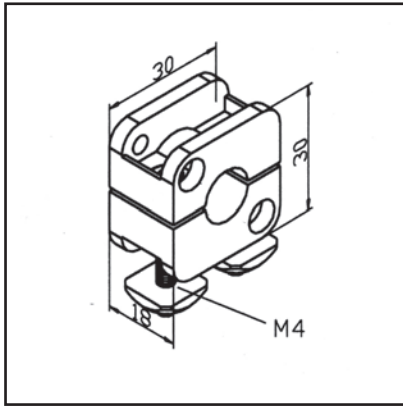
**TECHN. DATA / ITEMS SUPPLIED**

- Plastic, black
- With fastening material steel, zinc plated
- Ø 12
- Weight = 0.036 kg/piece

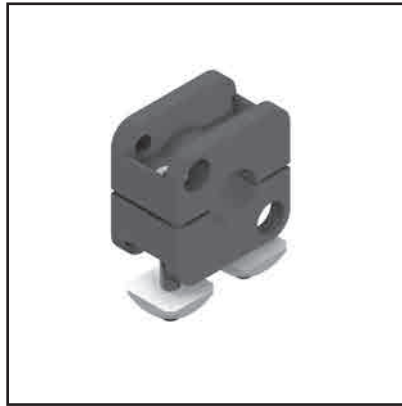
**APPLICATIONS**

- Fastening of proximity switches Ø 12 mm in profile constructions and linear guides

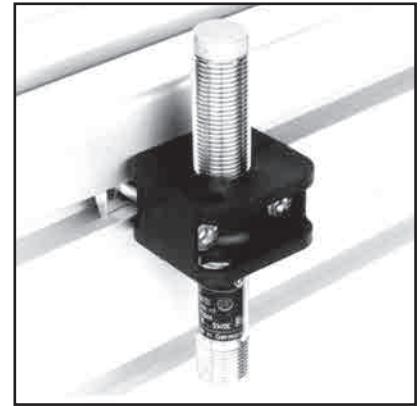
**ASSEMBLY**

- Fasten to profile groove with supplied hardware.

PROXIMITY SWITCH HOLDER 18

Part no.

28.0121/0

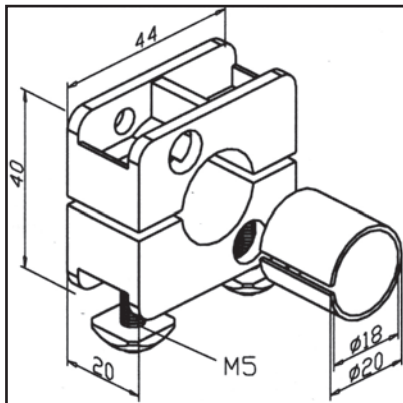
**TECHN. DATA / ITEMS SUPPLIED**

- Plastic
- With fastening material steel, zinc plated
- Ø 18 mm
- Ø 20 mm
- Weight = 0.046 kg/piece

**APPLICATIONS**

- Fastening of proximity switches Ø 18 mm and Ø 20 mm in profile constructions and linear guides

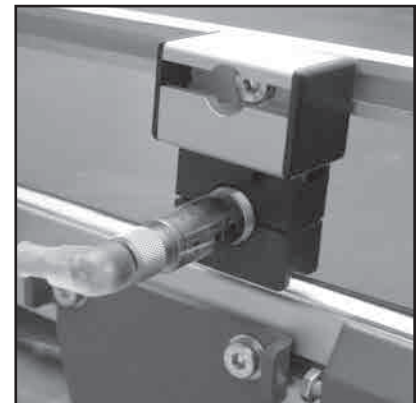
**ASSEMBLY**

- Fasten to profile groove with supplied hardware.

PROXIMITY SWITCH HOLDER 30

Part no.

28.0122/0

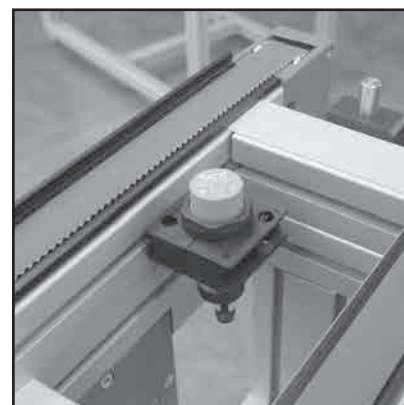
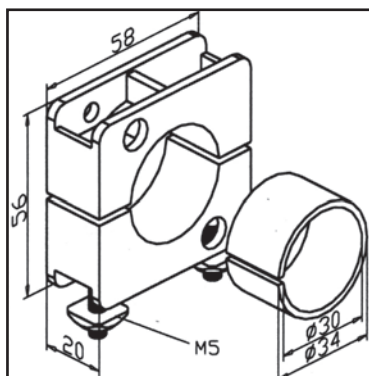

TECHN. DATA / ITEMS SUPPLIED

- Plastic, black
- With fastening material steel, zinc plated
- Ø 30 mm
- Ø 34 mm
- Weight = 0.068 kg/piece

APPLICATIONS

- Fixation of proximity switches Ø 30 and Ø 34 in profile constructions and linear axes

ASSEMBLY

- Fasten to profile groove with supplied hardware.

SENSOR HOLDERS

ALL SIDE SUPPORTS CAN BE COMBINED WITH ALL BEAMS

Carriers

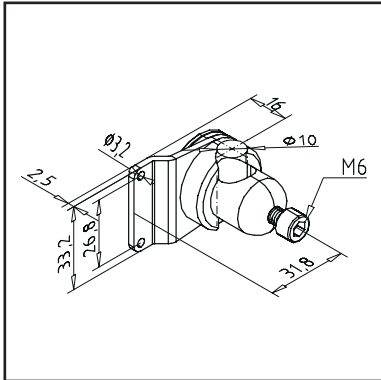

Part no. E1.0055/0

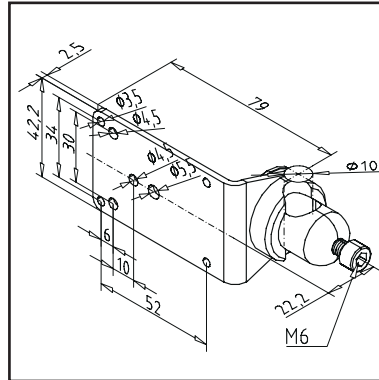

Part no. E1.0070/0

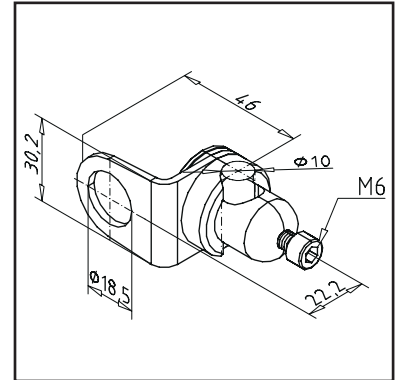

Part no. E1.0068/0

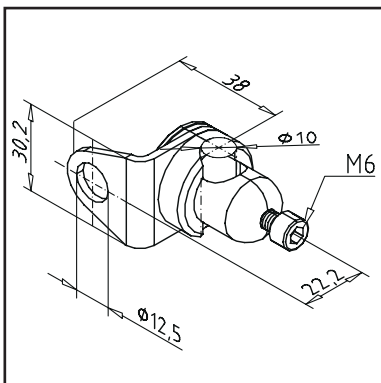

Part no. E1.0069/0

Lateral holders

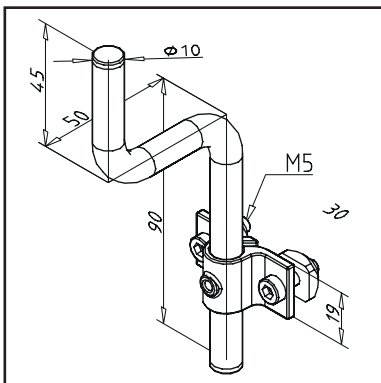

Part no. 29.5046/2

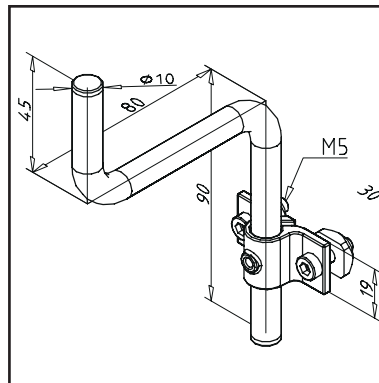

Part no. 29.5047/2

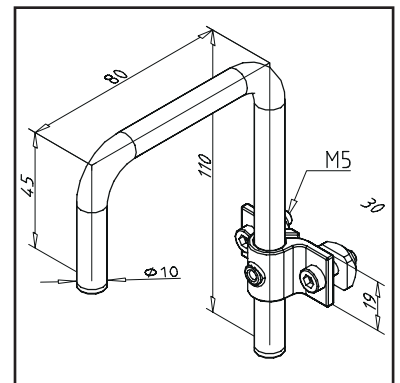

Part no. 29.5048/2